

2024/05-17 13:45:56
 Generated:
 By user:
 Drawing:

Volume Summary

Name	Type	Cut factor	Fill factor	2d Area (sqm)	Cut (Cu, M3)	Fill (Fu, M3)	Net (Cu, M3)
VOL.WS-01	Full	1,000	1,000	1000,59	518,26	518,55	333,290(CuP)
VOL.WS-02	Full	1,000	1,000	528,28	261,67	485,91	265,190(CuP)
VOL.WS-03	Full	1,000	1,000	412,85	183,75	240,22	189,780(CuP)
VOL.WS-04	Full	1,000	1,000	688,82	296,74	488,63	225,530(CuP)
VOL.WS-05a	Full	1,000	1,000	186,00	40,72	8,49	37,830(CuP)
VOL.WS-05b	Full	1,000	1,000	78,00	22,27	0,42	21,850(CuP)
VOL.WS-05c	Full	1,000	1,000	96,00	26,20	0,40	24,800(CuP)
VOL.WS-05d	Full	1,000	1,000	110,27	29,86	1,46	28,230(CuP)
Totaal							
Total				3056,81	1388,68	345,59	973,890(CuP)

* Value adjusted by cut or fill factor other than 1.0

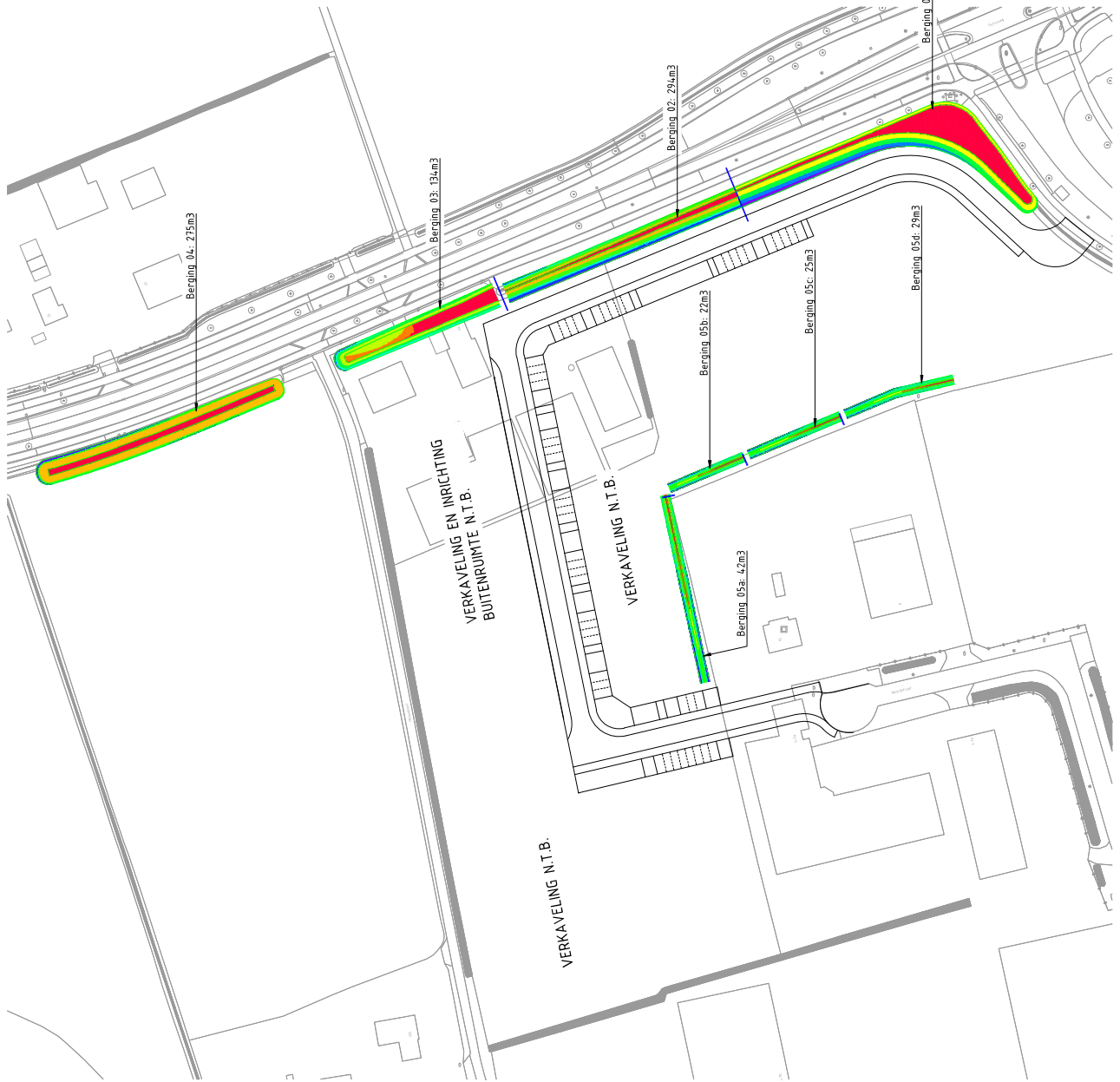

Project: Bedrijventerrein Driehoeven III
 Oudestraat
 Ingeieurs enadviseurs
 1105 CA Schiedamschen dijk
 2312 JG ZA
 T 06 43 61 11 11
 F 06 43 61 11 11
 www.ingeieursenadviseurs.nl

Project	1105 CA Schiedamschen dijk
Client	2312 JG ZA
Scale	1:100
Date	2024/05-17
Author	...
Checker	...
Approver	...