

### RENVOOI PLATTEGROND

- 1 = entrepui stalen kozijn deur met zijlichten
- 2 = schoonloopmat in tochtportaal
- 3 = vaste muur 1350 naar binnen
- 4 = betontegels 450x700
- 5 = vloertegel houtstroken b=160
- 6 = hardstenen dorpel (opstap 180+)
- 7 = tapijt in serre
- 8 = vloertegel houtstroken b=160 op 180+
- 9 = bar (apparatuur ntb)
- 10 = ontbijtbuffet
- 11 = glasdeurkoelkast tbv. speciaalbeer
- 12 = glasdeurkoelkast tbv. wijn
- 13 = audio-apparatuur + bedieningsscherm
- 14 = servies en bestek
- 15 = koffiemachine + molen waaronder condiment
- 16 = kassa
- 17 = kastje op vloerverhoging
- 18 = foto van kade (zicht richting water)
- 19 = boeken- / lektuurkast
- 20 = vaatwasmachine

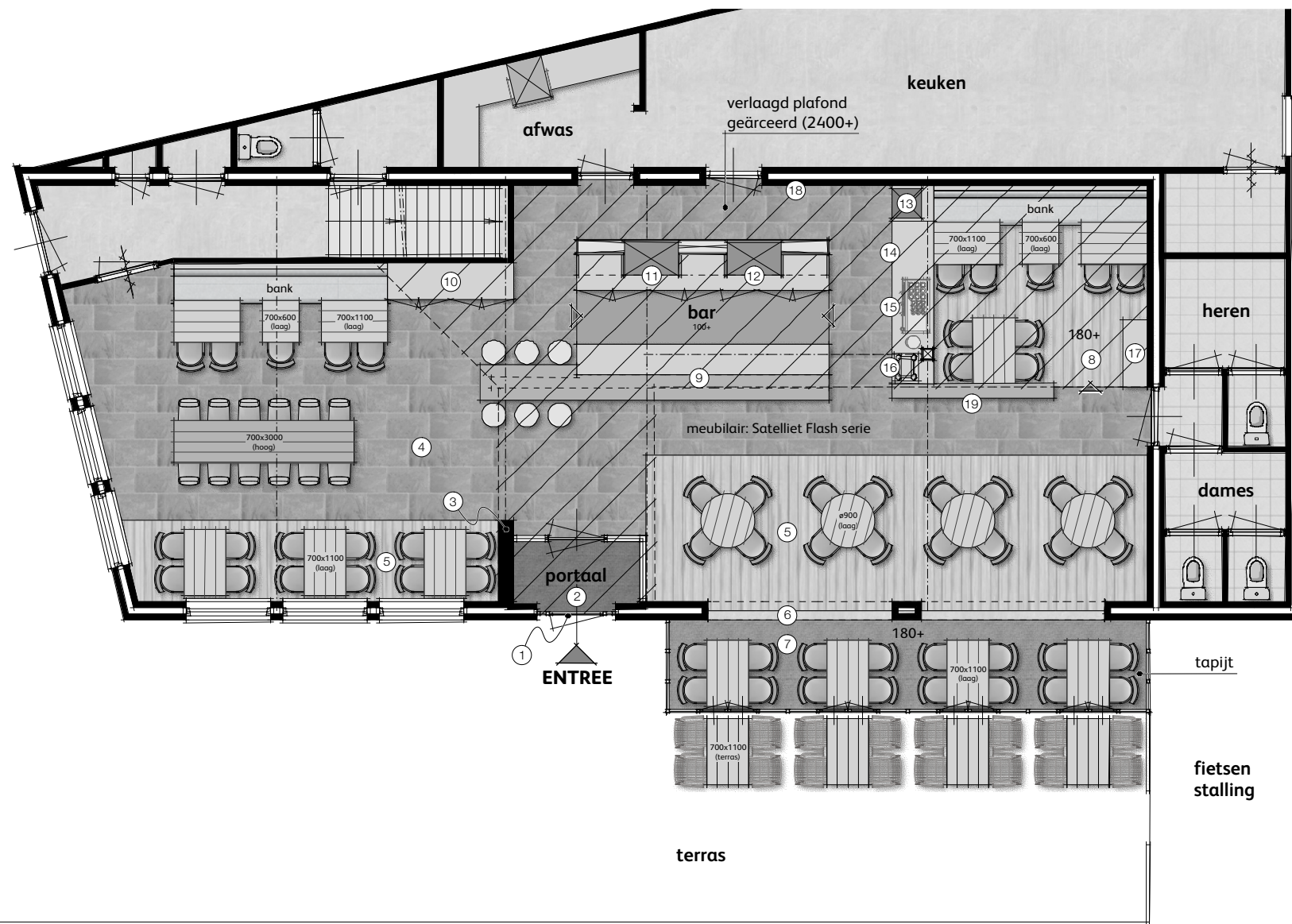

Plattegrond 1:100

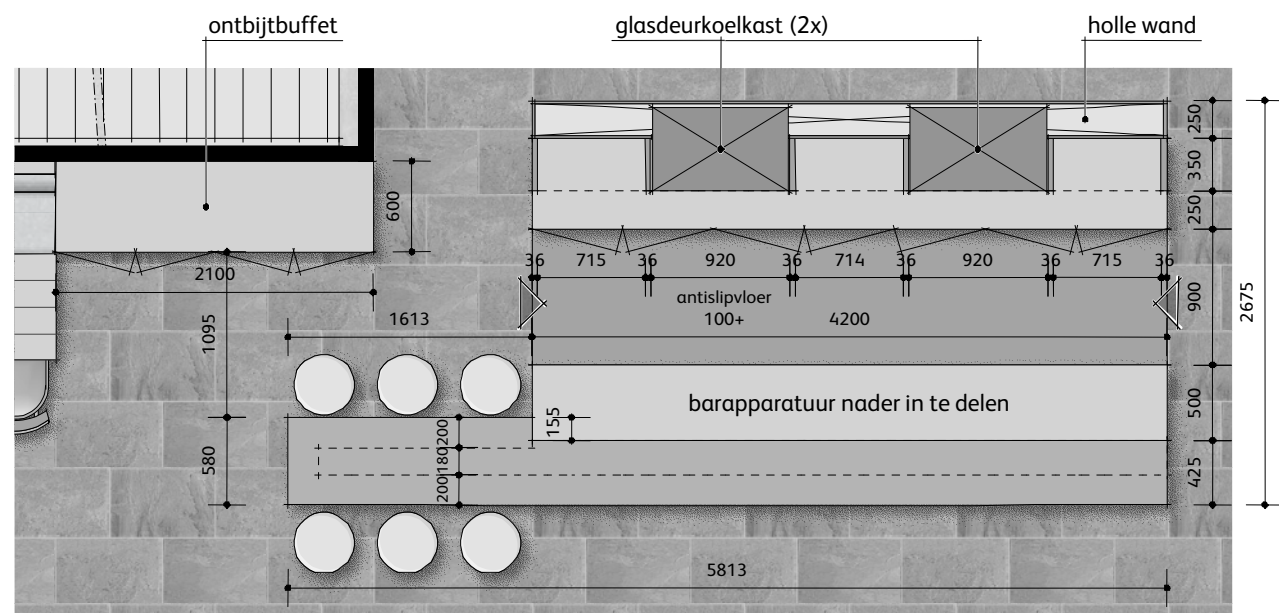

Plattegrond bar + ontbijtbuffet 1:50

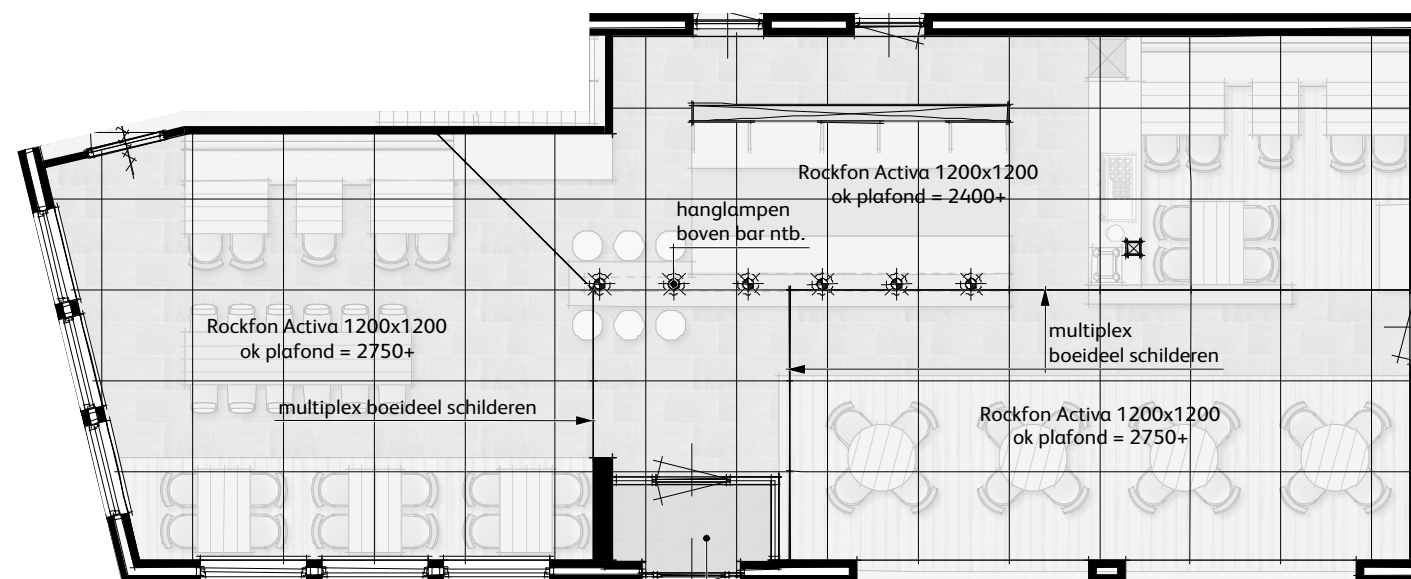

Plafondplan 1:100

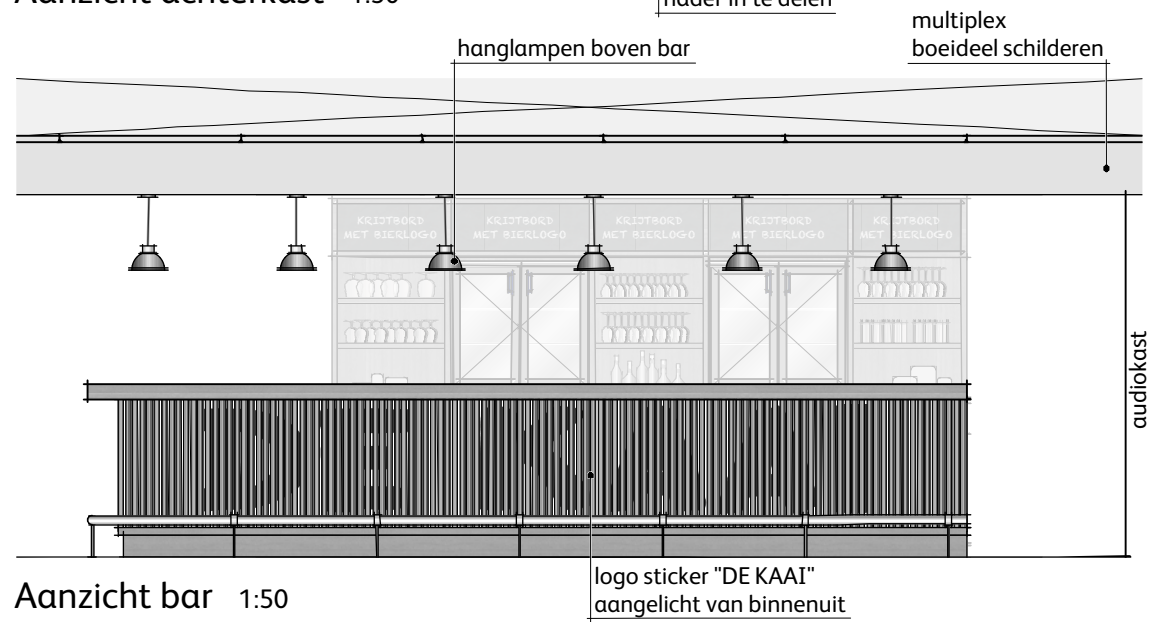
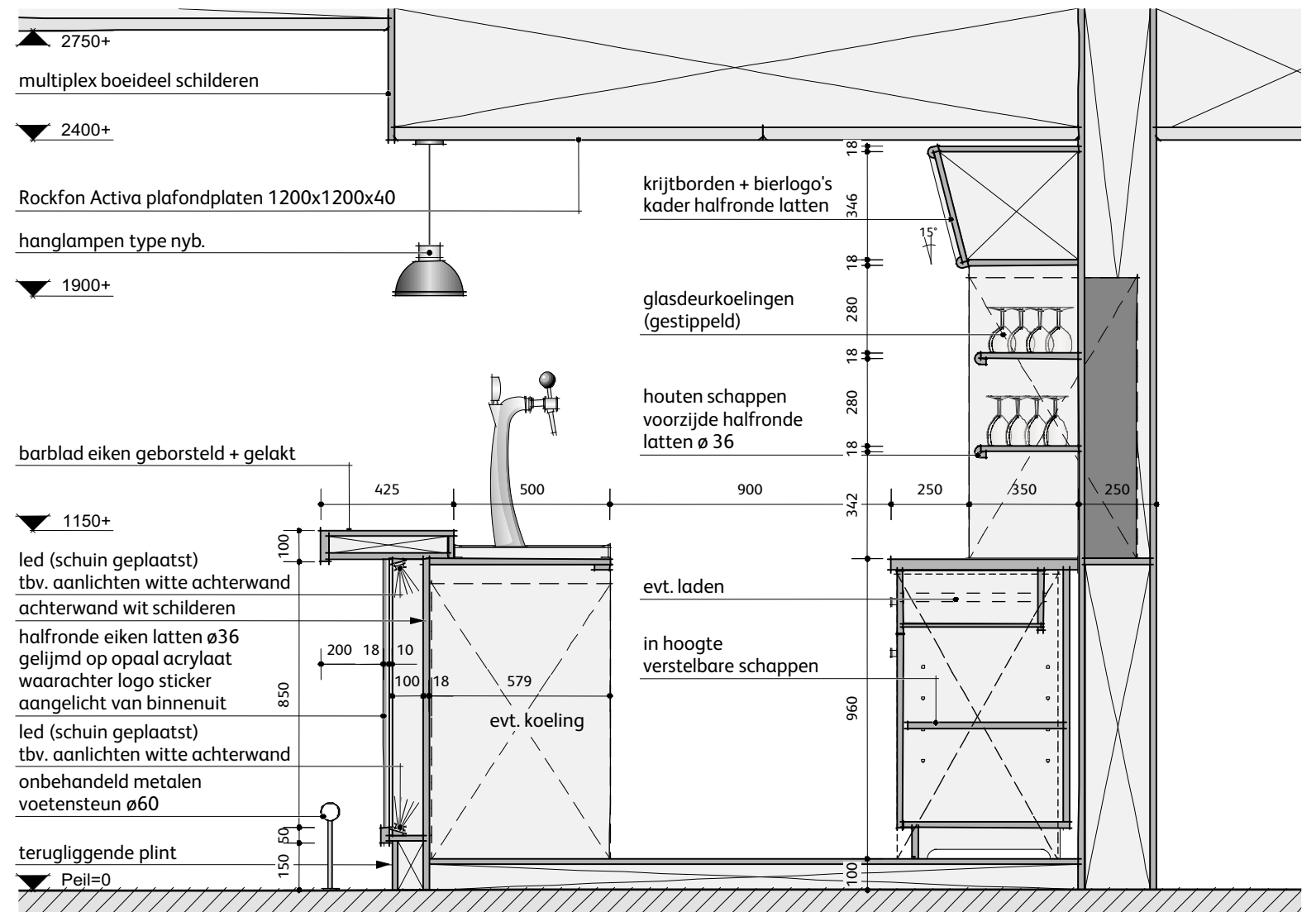
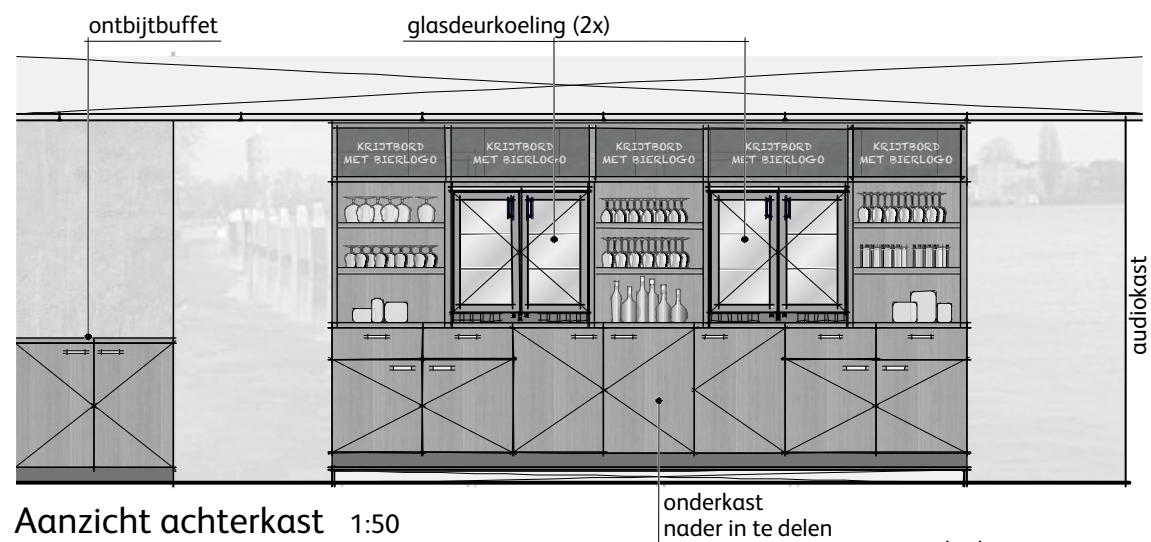
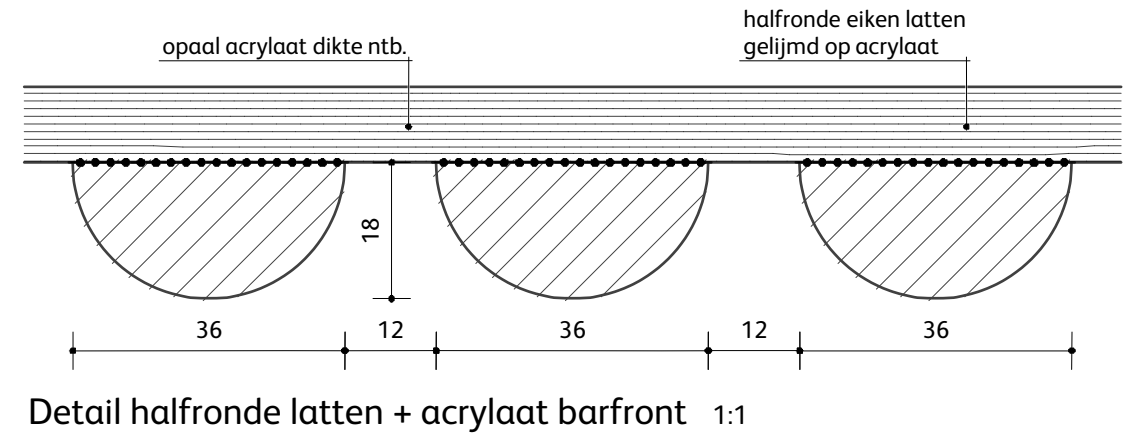
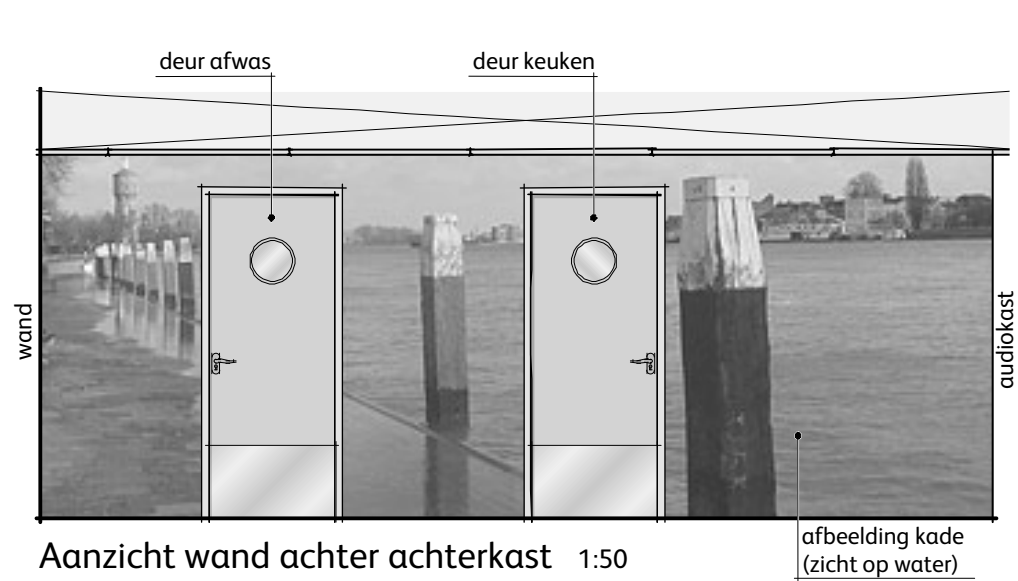

Principeddoorsnede bar + achterkast 1:20

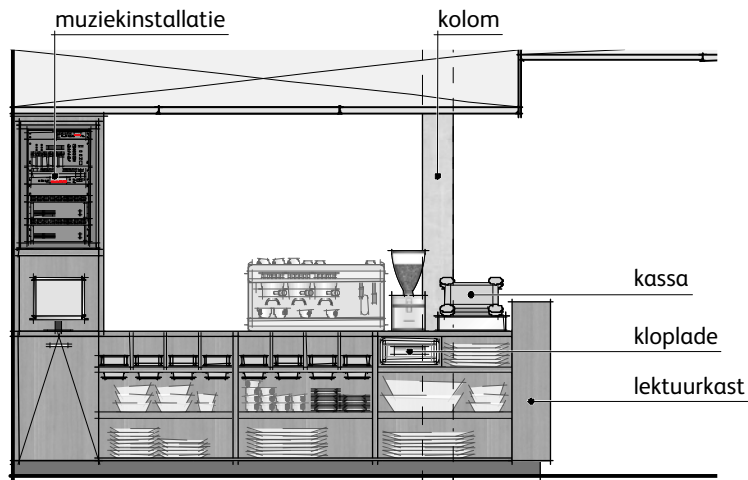

Aanzicht koffiekast 1:50

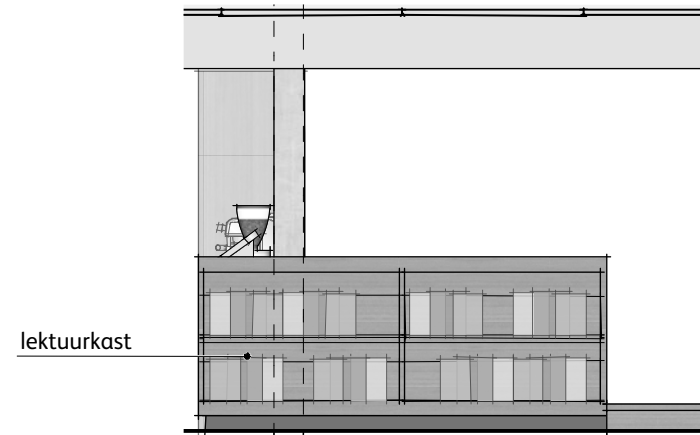

Aanzicht lektuurkast 1:50

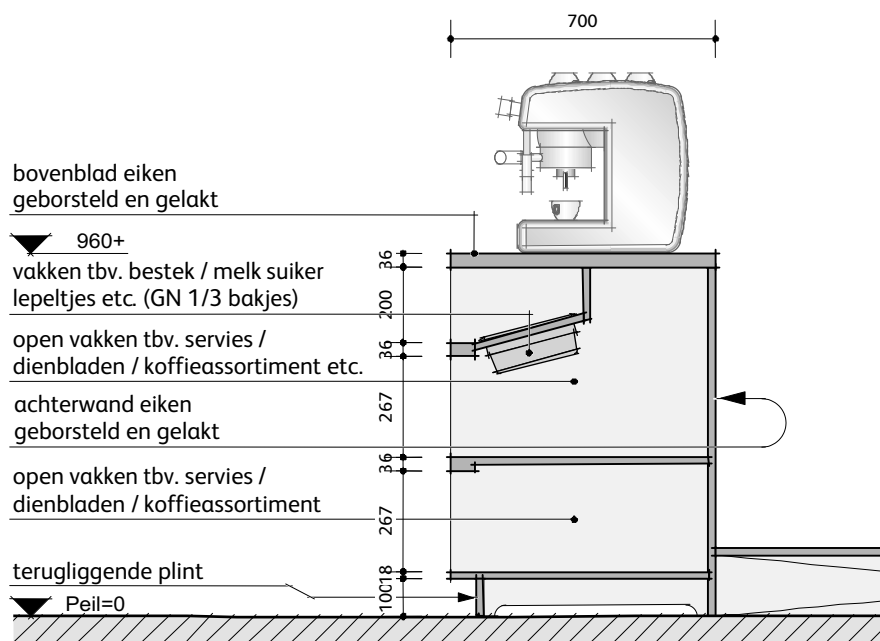
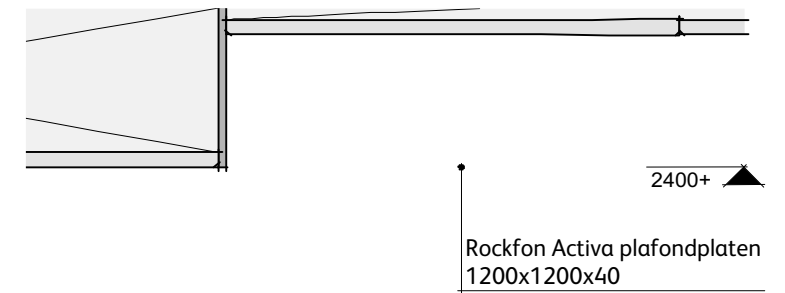
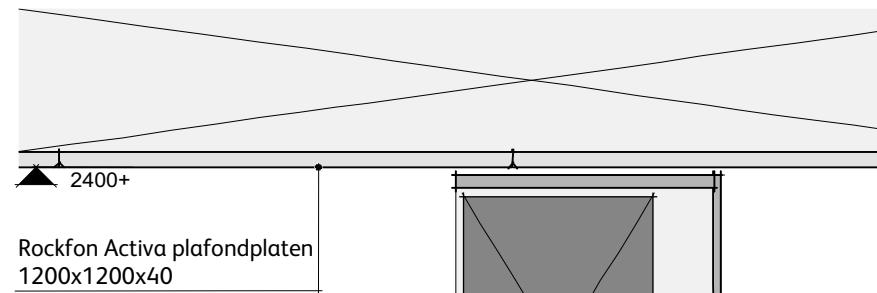
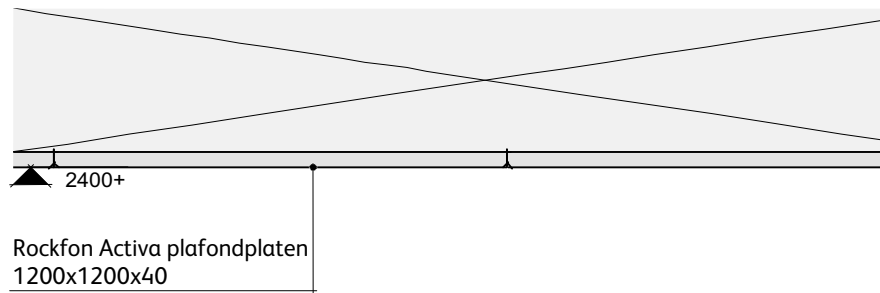

Principe koffiekast 1:20

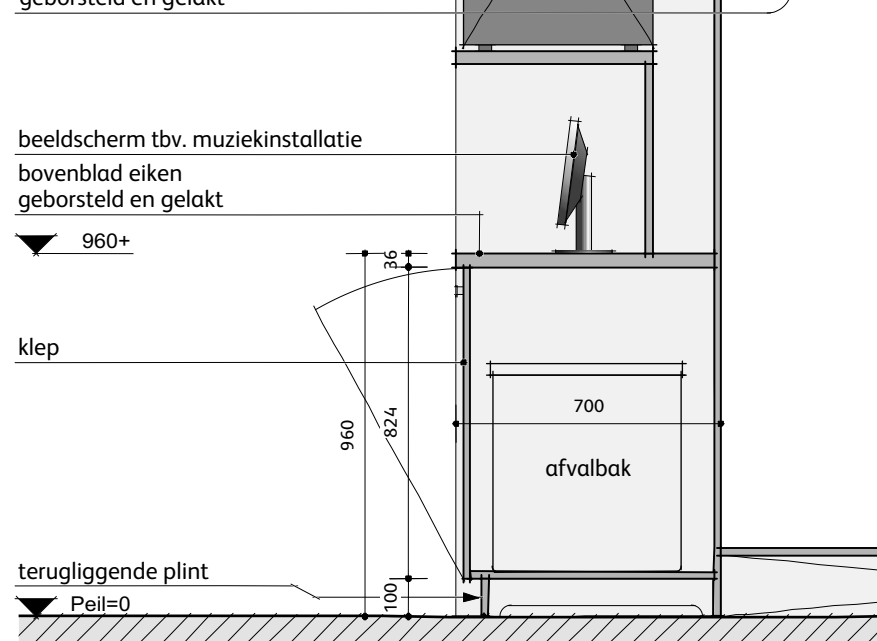

Principe koffiekast tpv audio / afvalklep 1:20

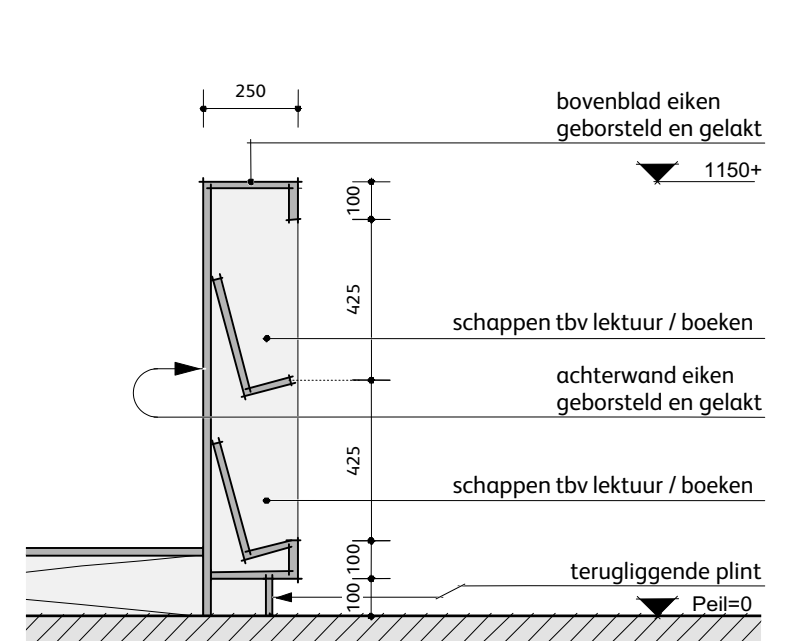

Principe lektuurkast 1:20