

# inhoudsopgave

| <u>bladnr.</u> | <u>inhoud:</u>   | <u>laatste datum:</u> |
|----------------|--|-----------------------|
| blad 00        | voorblad   | 15-12-2022            |
| blad 01        | Fascia LED 600mm                                       | 15-12-2022            |
| blad 02        | Wall logo arch "M"                                     | 15-12-2022            |
| blad 03        | Panel LED arch "M"                                     | 15-12-2022            |
| blad 04        | McCafé LED 3000mm                                      | 15-12-2022            |
| blad 05        | DT-1 = Drive Totem 1 - 6,5m                            | 15-12-2022            |
| blad 06        | DT-1 = Drive Totem 1 - 6,5m                            | 15-12-2022            |
| blad 07        | DS-A = Directional Sign - welkom                       | 15-12-2022            |
| blad 08        | DS-A = Directional Sign - welkom                       | 15-12-2022            |
| blad 09        | DS-A = Directional Sign - tot ziens                    | 15-12-2022            |
| blad 10        | DS-A = Directional Sign - tot ziens                    | 15-12-2022            |
| blad 11        | GS-1 = Gateway Sign                                    | 15-12-2022            |
| blad 12        | GS-1 = Gateway Sign                                    | 15-12-2022            |
| blad 13        | COD Canopy+ praatpaal                                  | 15-12-2022            |
| blad 14        | COD Canopy+ praatpaal                                  | 15-12-2022            |
| blad 15        | COD = praatpaal  | 15-12-2022            |
| blad 16        | foto DTC + COD + DPS + DMB                             | 15-12-2022            |
| blad 17        | DPS + DMB  | 15-12-2022            |
| blad 18        | DPS + DMB  | 15-12-2022            |
| blad 19        | PB = prullenbak  | 15-12-2022            |
| blad 20        | PB = prullenbak  | 15-12-2022            |
| blad 21        | fietsnietjes / fietsaanleunbeugels                     | 15-12-2022            |
| blad 22        | terrasafscheiding laag hekwerk met optie verlichting   | 15-12-2022            |
| blad 23        | terrasafscheiding windscherm met optie verlichting     | 15-12-2022            |
| blad 24        | terrasafscheidingen + opties verlichting en Moshi paal | 15-12-2022            |
| blad 25        | meubilair terras                                       | 15-12-2022            |
| blad 26        | vlaggenmast  | 15-12-2022            |



St. Ignatiusstraat 255, 4817 KK Breda  
Postbus 9306, 4801 LH Breda  
tel. +31 (0) 76 522 9009  
info@debontgroep.nl  
www.debontgroep.nl

opdrachtgever

**McDonald's Nederland B.V.**

**postbus 403, 3500 AK te Utrecht**

project

**Nieuwbouw McDonald's restaurant + McDrive  
te Vlissingen Souburg**

onderwerp

**terreinobjecten + signage**

|              |           |            |
|--------------|-----------|------------|
| formaat      | getekend  | datum      |
| A3           | AvB       | 15-12-2022 |
| schaal       | type      | status     |
| n.v.t.       | T-595     | definitief |
| fase         | store nr. | gewijzigd  |
| bouwaanvraag | .         | ....       |

projectnummer  
**20054S**  
tekeningnummer  
**B-06**

**124-451-001** - McD Fascia 600 mm LED - green Substructure

**124-453-001** - McD Fascia 600 mm LED - brown Substructure

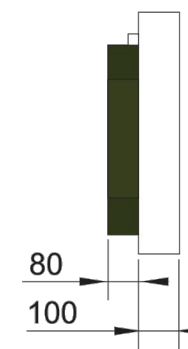

## Dimensions:

5493 x 600 x 180 mm

## Design:

2 mm Aluminium-backplate glued with 10 mm Foamex plate. LED modules installed on the Foamex plate. Cover made of 3mm white acrylic glass, case opaque, front of the letters translucent. Cover fixed with screws on the Foamex plate. Single letters are mounted on a substructure made of welded aluminium profiles, coated in dark green - Akzo Nobel MK 120 or brown - RAL 8003.

## Illumination:

Internal illumination with LED.

## Technical Information:

|                   |                         |
|-------------------|-------------------------|
| Nominal Voltage:  | 230V                    |
| Frequency:        | 50-60 Hz                |
| Connected Load:   | 184 W                   |
| Connecting Cable: | 3 x 1,5 mm <sup>2</sup> |
| Fuse Protection:  | C16 A                   |

## Installation:

Roof mounted on a Substructure (to be ordered separately). The substructure has to be installed in advance, roof needs to be sealed by a qualified person after installation of the substructure. Once connected and fitted the sign should be tested for functionality.

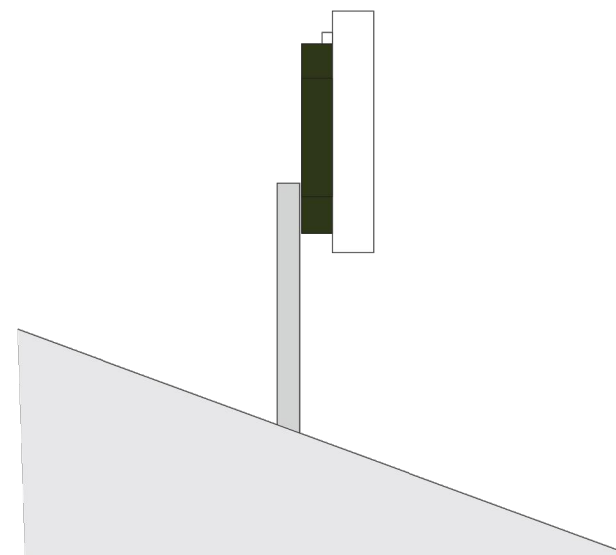

## The Sign conforms with the following guidelines:

VDE 0100, VDE 0128, VDE 0711, EN 55015, EN 60598, EN 50107, EN 61547, EN 6100-3-2

## CE conform according to guidelines:

89/336/EWG, 92/31/EWG, 73/23/EWG

|  |                           |
|--|---------------------------|
| 124-000-001 - Wall-Logo Height 450 mm  | WxHxD - 514 x 450 x 120   |
| 124-000-001 - Wall-Logo Height 565 mm  | WxHxD - 646 x 565 x 120   |
| 124-000-001 - Wall-Logo Height 707 mm  | WxHxD - 808 x 707 x 120   |
| 124-468-001 - Wall-Logo Height 900 mm  | WxHxD - 1029 x 900 x 120  |
| 124-000-001 - Wall-Logo Height 1220 mm | WxHxD - 1394 x 1220 x 120 |

### Dimensions:

see schedule above

### Design:

2 mm Aluminium-backplate glued with 8 mm Foamex plate. LED modules installed on the Foamex plate. Letter Casing and Cover made of thermo-formed 3 mm yellow, flat acrylic glass fixed with screws at Foamex plate.

### Illumination:

Internal illumination with LED.

### Illuminants:

|           |          |
|-----------|----------|
| Logo 450: | 12 V LED |
| Logo 565: | 12 V LED |
| Logo 707: | 12 V LED |
| Logo 900: | 12 V LED |

### Connected load:

|       |
|-------|
| 6,5 W |
| 8,2 W |
| 9,6 W |
| 20 W  |

### Technical Information:

|                   |                         |
|-------------------|-------------------------|
| Nominal Voltage:  | 230V                    |
| Frequency:        | 50-60 Hz                |
| Connecting Cable: | 3 x 1,5 mm <sup>2</sup> |
| Fuse Protection:  | C16 A                   |

### Installation:

Wall Installation with plugs and screws. The sign is internally cabled and requires on-Site connection to existing Power Supply Cable. Once connected an fitted the sign should be tested for functionality. Sign can also be installed on the roof with a substructure, which has to be ordered separately.

### The Sign conforms with the following guidelines:

VDE 0100, VDE 0128, VDE 0711, EN 55015, EN 60598, EN 50107, EN 61547, EN 6100-3-2

### CE conform according to guidelines:

89/336/EWG, 92/31/EWG, 73/23/EWG

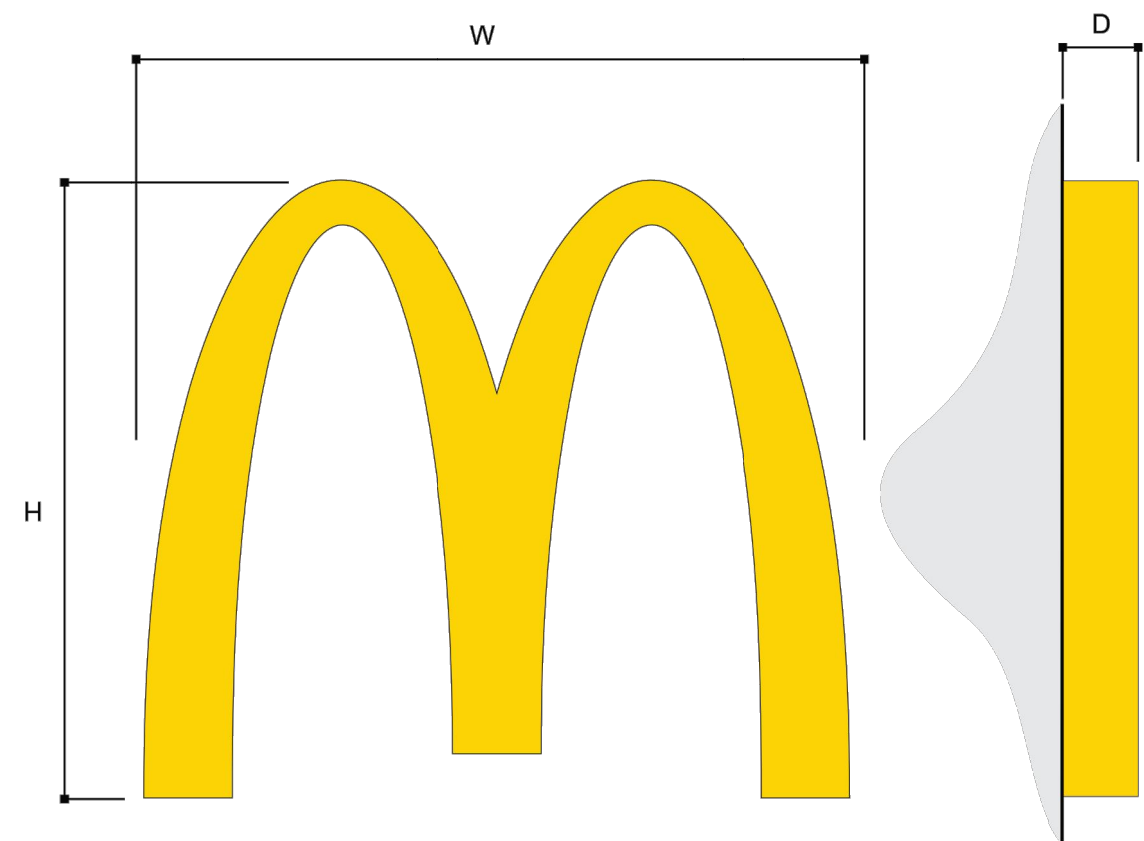

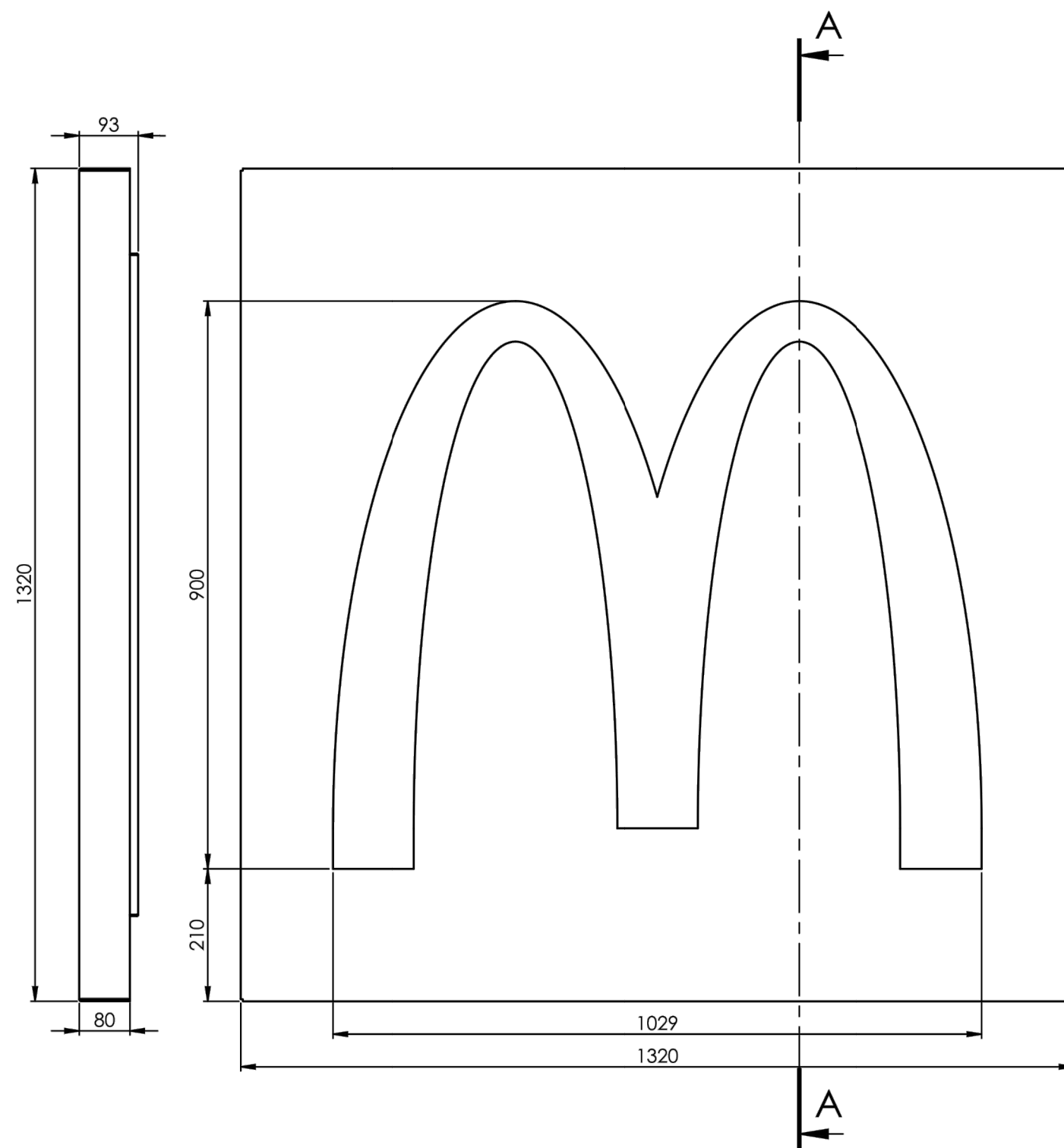

A-A  
1:13

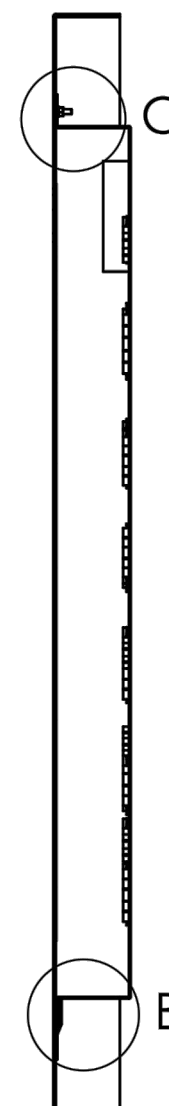

C  
1:5

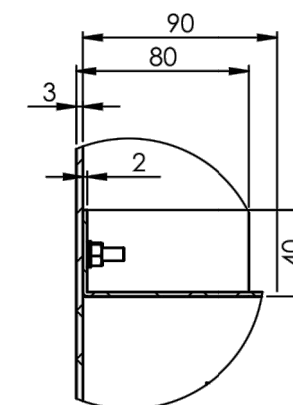

B  
1:5

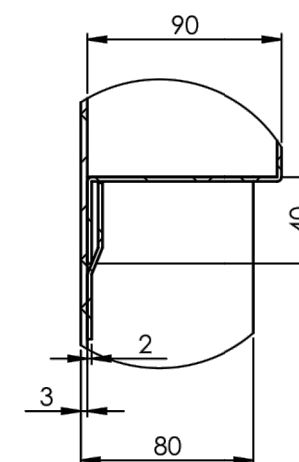

03

|   |              |                        |  |                     |                                     |
|---|--------------|------------------------|--|---------------------|-------------------------------------|
| Tolerancje ogólne<br>General tolerances<br>EN 22768-1/m                               |              | Skala<br>Scale<br>1:20 | MC DONALDS   |                     | kg                                  |
|   |              |                        | Masa/Weight  |                     |                                     |
| A4  | Data<br>Date | Nazwisko<br>Name       | PANEL M-LOGO FÜR WHITE CAP 1320X1320 MM<br>NEUE AUSFÜHRUNG |                     |                                     |
| Rysował<br>Drawn  | 2013-05-16   | D.Rudner               |  |                     |                                     |
| Sprawdził<br>Checked  | 2013-05-16   | G.Zwolak               |  |                     |                                     |
| Zatwierdził<br>Approved   | 2013-05-16   | G.Zwolak               |  |                     |                                     |
|  |              |                        | 024 554 600  |                     |                                     |
|   |              |                        | Nr rysunku/Article No                                      | Rewizja<br>Revision | Stan wykończenia/Finished condition |
|   |              |                        | Zapisany jako/Save as: 024 554 600.SLDDRW                  |                     |                                     |



124-906-001 Artikelnummer mit brauner UK

124-905-001 Artikelnummer mit grüner UK

**Maße:** 3000 x 1206 x 200 mm**Buchstabenkörper:**

Ausführung in Profil 8. Zarge aus thermisch verformtem weißen Acryl (3mm) - mit 3mm Acryl-Spiegel verklebt.  
 Rückwand aus Aluminiumblech (2 mm) mit aufgeklebter PVC-Platte (10 mm) als Trägerelement für die LED-Module.  
 PVC-Platte ist umlaufend 3 mm kleiner als die Aluminium-Trägerplatte.  
 Die Acrylzarge wird durch seitliche Verschraubungen in der PVC-Platte mit der Rückwand verbunden.

**Tragkonstruktion:**

Aluminium-QR 80 x 80 mm - mit Vertikal-Stützen 20 x 20 mm gemäß RAL 8003 oder dunkelgrün - Akzo Nobel MK 120 pulverbeschichtet.

**Ausleuchtung und LED-Wechsel:**

LED mit elektronischen Vorschaltgeräten.  
 LED-Wechsel beim Logo durch Abnehmen der Buchstabenkörper

**Technische Daten:**

Netzspannung: 230V  
 Frequenz: 0/50-60 Hz  
 Anschlußleitung: 3x 1,5 mm  
 Absicherung: C16 A  
 Gesamtleistung: 110 W

**Das Element stimmt mit den Vorschriften folgender Richtlinien überein:**

VDE 0100, VDE 0128, VDE 0711, EN 55015, EN 60598, EN 50107, EN 61547, EN 6100-3-2

**CE-konform nach folgenden Richtlinien:**

89/336/EWG, 92/31/EWG, 73/23/EWG

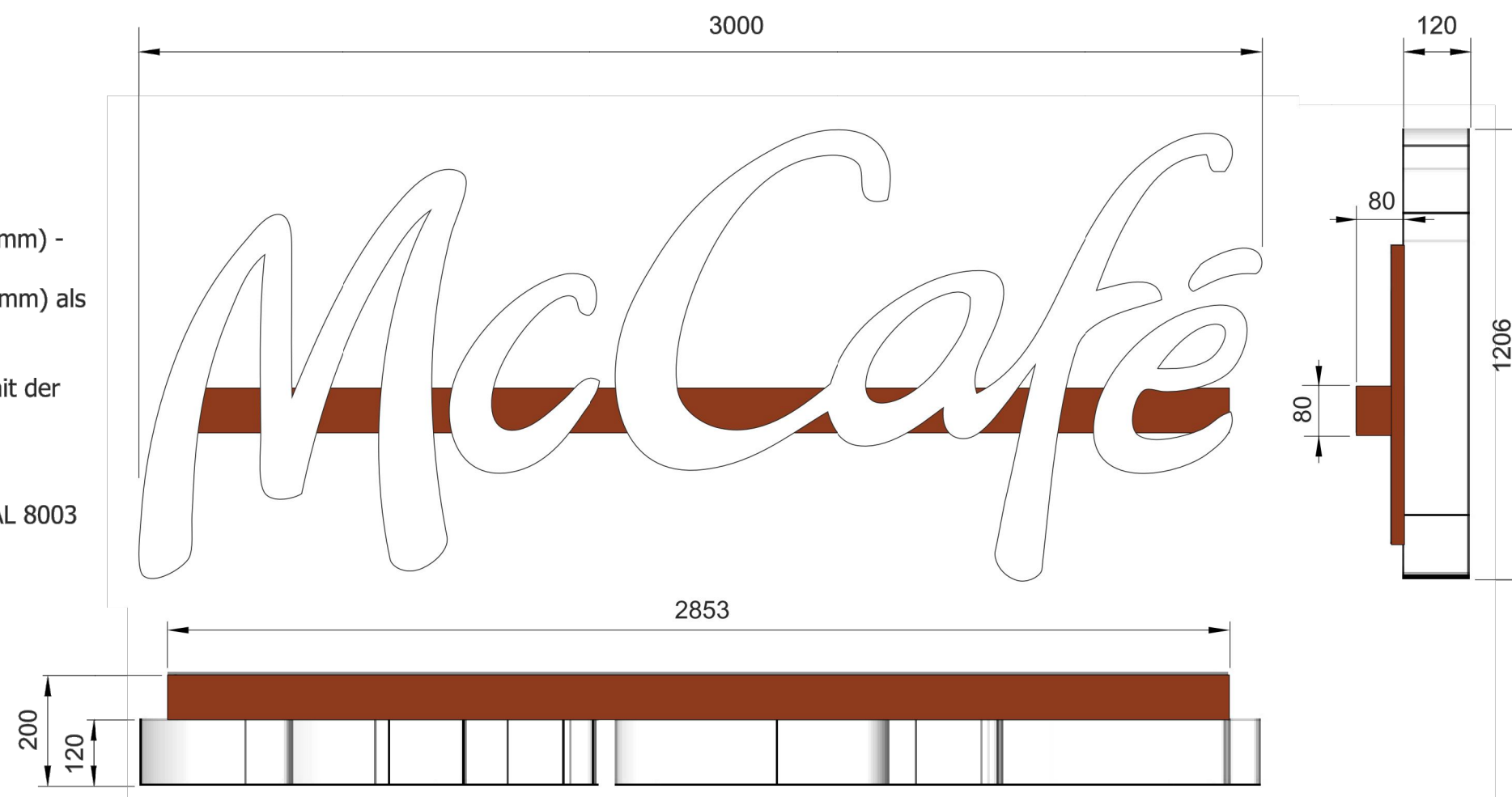

124-414-001 Drive Totem 1 - 6,5 m VERSION A

124-000-001 Drive Totem 1 - 6,5 m VERSION B

**Dimensions:**

(WxHxD) 1450 x 6500 x 320 mm

**Design:**

Galvanized steel-construction, Cover made of 3 mm Reynobond "Italian Walnut" (McCafé-element & blank element), other elements coated in dark green - Akzo Nobel MK 120 (M & Mcdrive). M cut out- yellow acrylic glass pushed through, McCafé and McDrive cut out and back-layed with acrylic glass. Side faces coated in in RAL 7022. Plinth made of Aluminium, coated in in RAL 7022. Element "McDrive" is rotatable.

**Illumination:**

Internal illumination with LED.

**Technical Information:**

Nominal Voltage: 230V  
 Frequency: 50-60 Hz  
 Connected Load: 250 W  
 Connecting Cable: 3 x 1,5 mm<sup>2</sup>  
 Fuse Protection: C16 A

**Installation:**

Free-standing Installation with fixing bolts in existing foundation. Bolts according to DIN norm. When using Fixing Bolts ensure that the concrete has hardened sufficiently in accordance with specified requirements of the Bolt. Once connected and fitted the sign should be tested for functionality.

**Foundation/Fixing Material:**

1600 x 1600 x 900 mm - Concrete C 25/30 / Fixing Bolts

**The Sign conforms with the following guidelines:**

VDE 0100, VDE 0128, VDE 0711, EN 55015, EN 60598, EN 50107, EN 61547, EN 6100-3-2

**CE conform according to guidelines:**

89/336/EWG, 92/31/EWG, 73/23/EWG



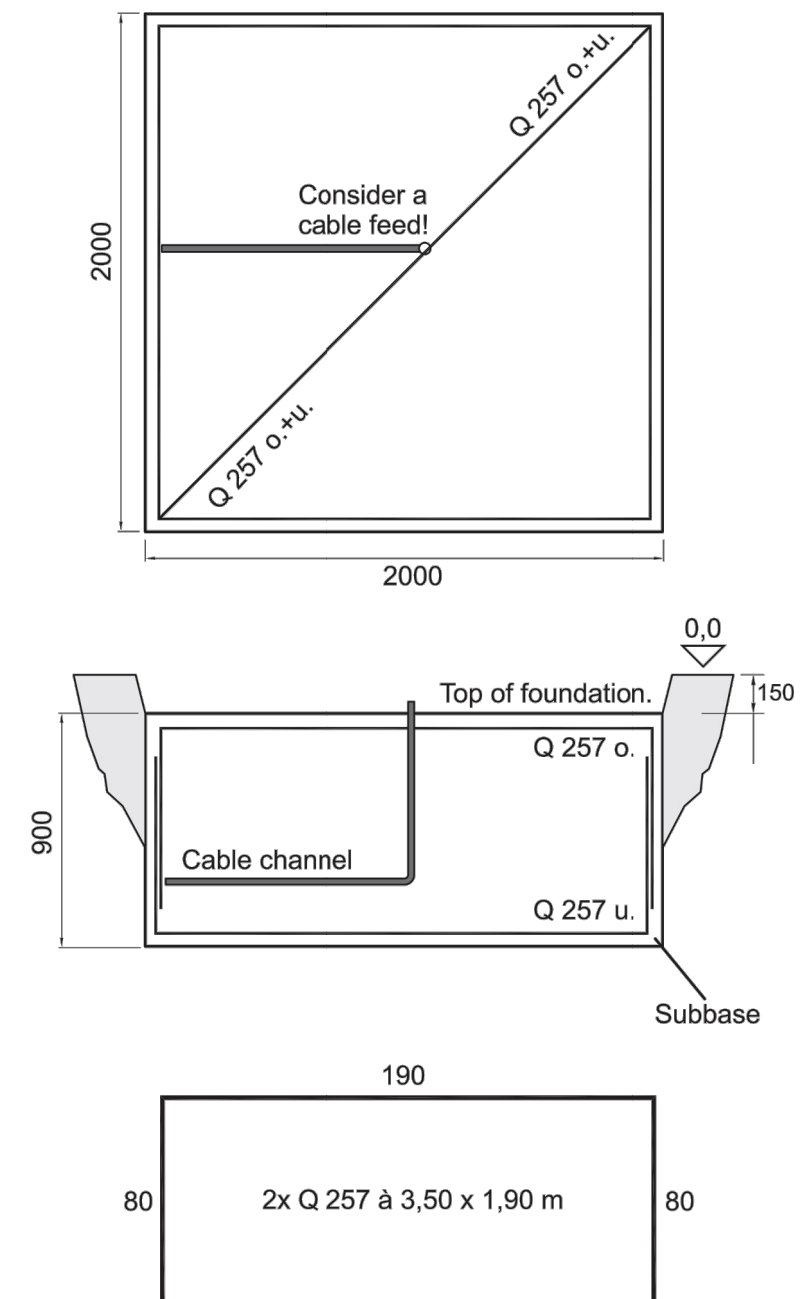

**A geotechnical survey should be done to confirm conditions for the Foundation.**

Individual Foundation drawings are available upon request.  
Local conditions and requirements should be observed and adhered to at all times.  
Foundations should only be planned and cast by suitably qualified persons.  
Lightning strike protection should be installed as per the local legal requirements.



### Dimensions:

(WxHxD) 600 x 2100 x 120 mm

### Design:

Galvanized steel-construction, aluminium cover coated in dark green- Akzo Nobel MK 120. Illuminated text/arrow cut out an back-layed with white acrylic glass. Upper white element made of white acrylic glass - illuminated. Plinth made of Aluminium, coated in in grey - RAL 7022.

### Illumination:

Internal illumination with LED.

### Technical Information:

Nominal Voltage: 230V  
Frequency: 50-60 Hz  
Connected Load: 41 W  
Connecting Cable: 3 x 1,5 mm<sup>2</sup>  
Fuse Protection: C16 A

### Installation:

Free-standing Installation with fixing bolts in existing foundation. Bolts according to DIN norm. When using Fixing Bolts ensure that the concrete has hardened sufficiently in accordance with specified requirements of the Bolt. Once connected an fitted the sign should be tested for functionality.

### Foundation/Fixing Material:

800 x 800 x 1000 mm - Concrete C 25/30 / Fixing Bolts

### The Sign conforms with the following guidelines:

VDE 0100, VDE 0128, VDE 0711, EN 55015, EN 60598, EN 50107, EN 61547, EN 6100-3-2

### CE conform according to guidelines:

89/336/EWG, 92/31/EWG, 73/23/EWG



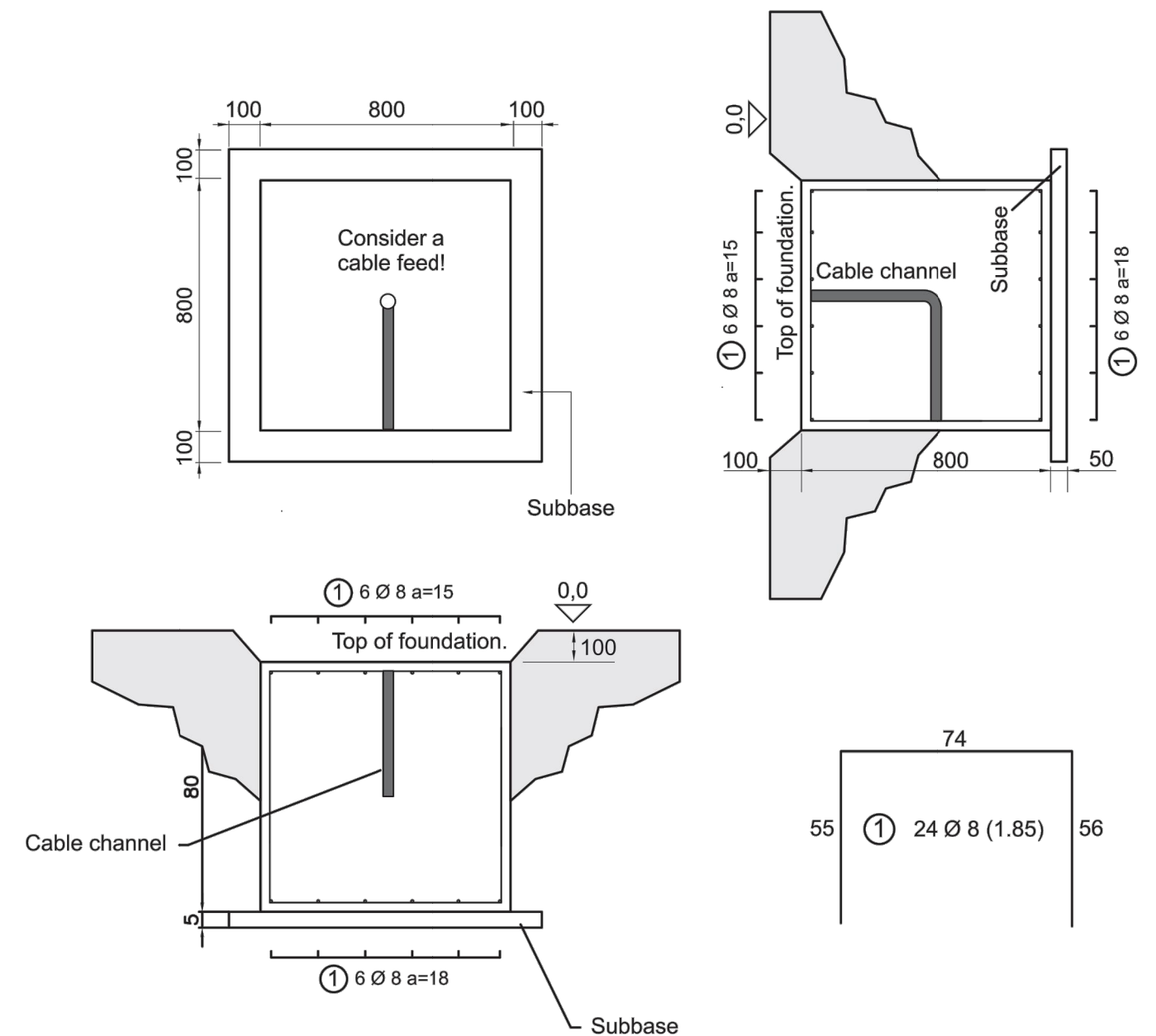

Individual Foundation drawings are available upon request.  
Local conditions and requirements should be observed and adhered to at all times.  
Foundations should only be planned and cast by suitably qualified persons.  
Lightning strike protection should be installed as per the local legal requirements.



### Dimensions:

(WxHxD) 600 x 2100 x 120 mm

### Design:

Galvanized steel-construction, aluminium cover coated in dark green- Akzo Nobel MK 120. Illuminated text/arrow cut out an back-layed with white acrylic glass. Upper white element made of white acrylic glass - illuminated. Plinth made of Aluminium, coated in in grey - RAL 7022.

### Illumination:

Internal illumination with LED.

### Technical Information:

Nominal Voltage: 230V  
Frequency: 50-60 Hz  
Connected Load: 41 W  
Connecting Cable: 3 x 1,5 mm<sup>2</sup>  
Fuse Protection: C16 A

### Installation:

Free-standing Installation with fixing bolts in existing foundation. Bolts according to DIN norm. When using Fixing Bolts ensure that the concrete has hardened sufficiently in accordance with specified requirements of the Bolt. Once connected an fitted the sign should be tested for functionality.

### Foundation/Fixing Material:

800 x 800 x 1000 mm - Concrete C 25/30 / Fixing Bolts

### The Sign conforms with the following guidelines:

VDE 0100, VDE 0128, VDE 0711, EN 55015, EN 60598, EN 50107, EN 61547, EN 6100-3-2

### CE conform according to guidelines:

89/336/EWG, 92/31/EWG, 73/23/EWG



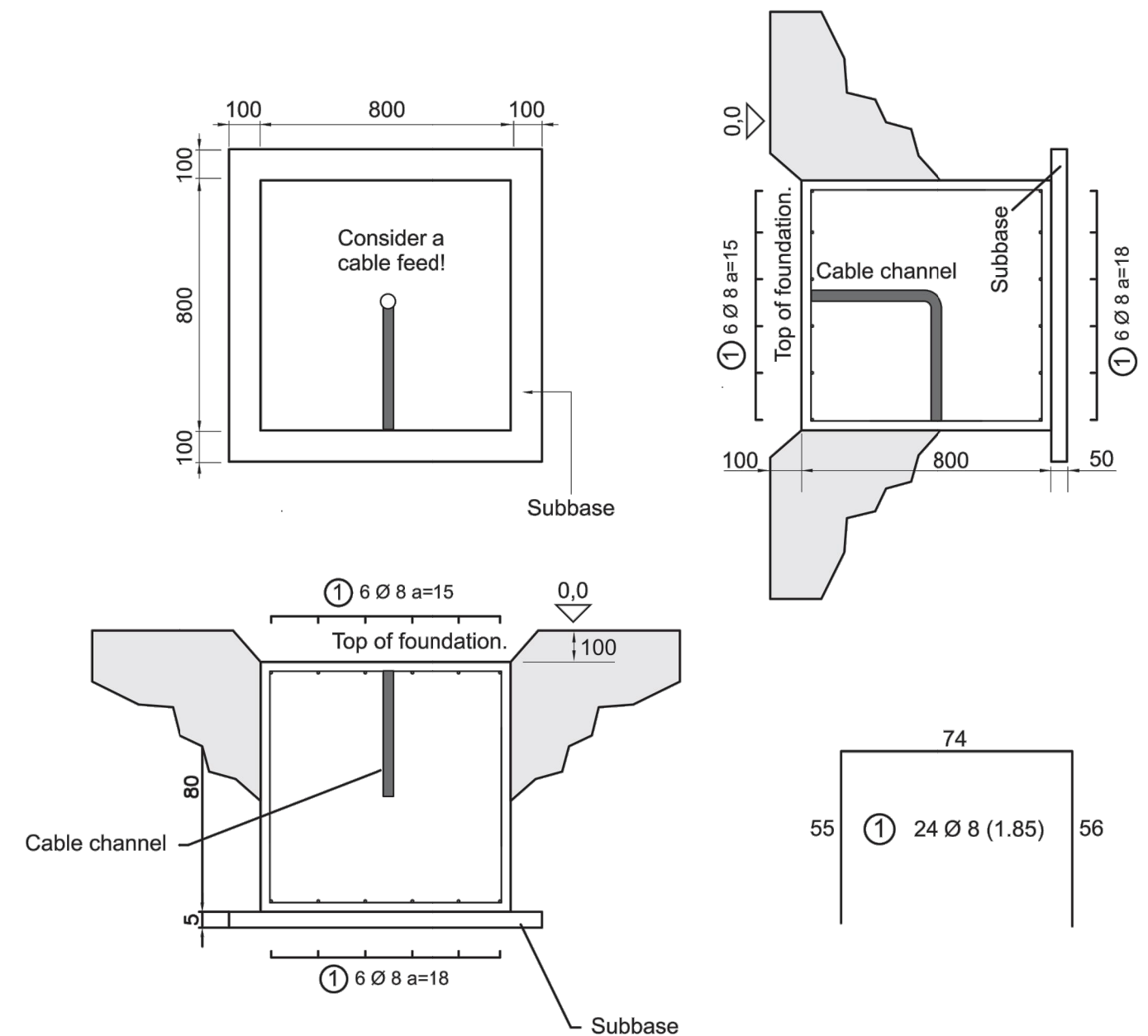
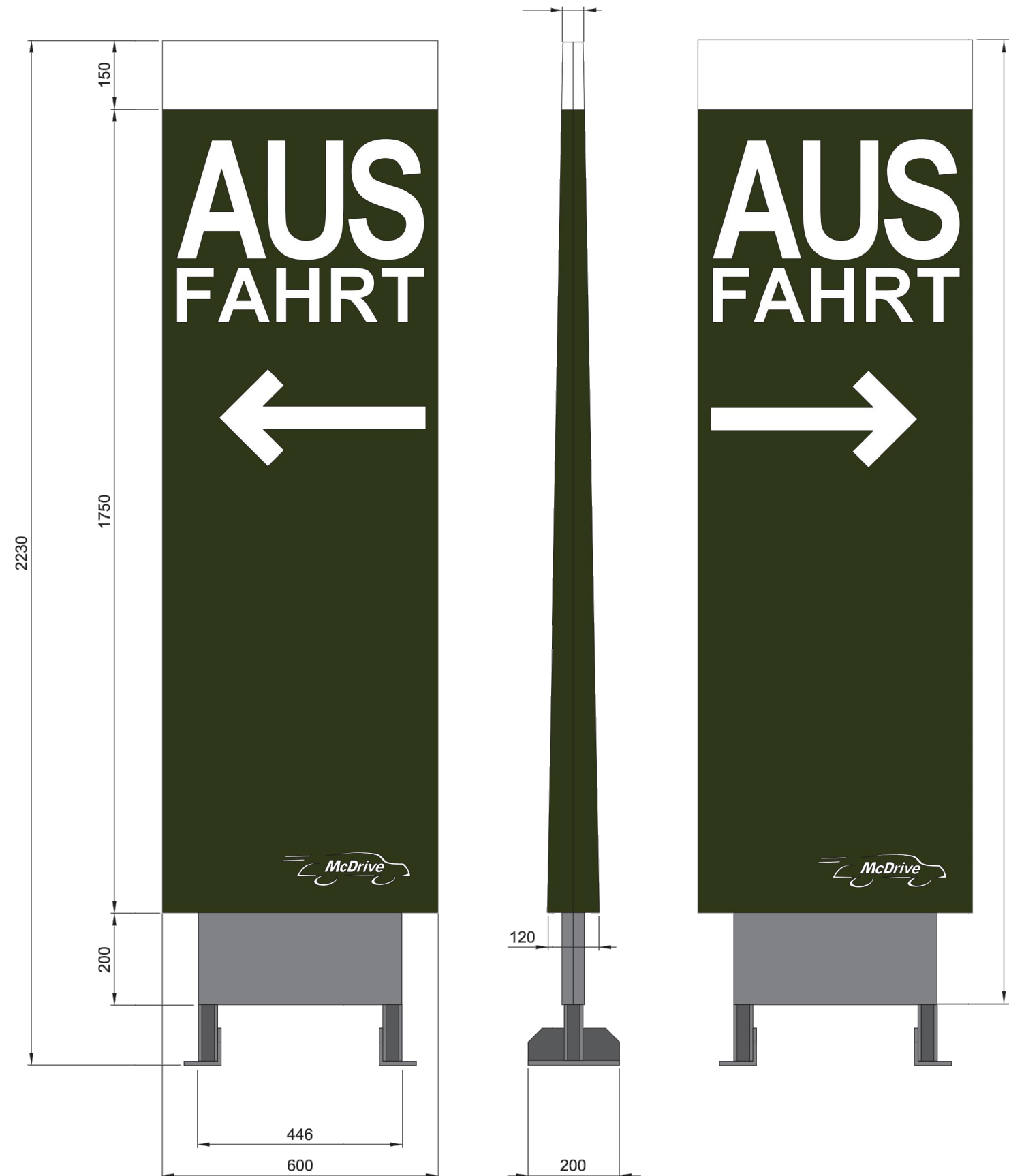

**A geotechnical survey should be done to confirm conditions for the Foundation.**

Individual Foundation drawings are available upon request.  
Local conditions and requirements should be observed and adhered to at all times.  
Foundations should only be planned and cast by suitably qualified persons.  
Lightning strike protection should be installed as per the local legal requirements.

**Dimensions:**

(WxHxD) 4250 x 3300 x 200 mm

**Design:**

Galvanized steel-construction, Cover made of 3 mm Reynobond "Italian Walnut", swingable arm made of galvanized steel-construction with Reynobond cover coated in dark green- Akzo Nobel MK 120. Stripes made of reflective vinyl with additional LED modules. Logos "McDrive" and "24" (optional!) cut out and back-layed with acrylic glass/illuminated. Credit card logos digital-print on dark green background. Plinth made of Aluminium, coated in in RAL 7022. **If the boom is hit, an alarm will sound, and a red warning lamp will begin to flash (optional!).**

**Illumination:**

Internal illumination with LED.

**Illuminants:**

Lightbox: 12 V LED

**Technical Information:**

Nominal Voltage: 230V  
Frequency: 50-60 Hz  
Connected Load: 40 W  
Connecting Cable: 3 x 1,5 mm<sup>2</sup>  
Fuse Protection: C16 A

**Installation:**

Free-standing Installation with fixing bolts in existing foundation. Bolts according to DIN norm. When using Fixing Bolts ensure that the concrete has hardened sufficiently in accordance with specified requirements of the Bolt. Once connected and fitted the sign should be tested for functionality.

**Foundation/Fixing Material:**

1300 x 1300 x 1000 mm - Concrete C 25/30 / Fixing Bolts

**The Sign conforms with the following guidelines:**

VDE 0100, VDE 0128, VDE 0711, EN 55015, EN 60598, EN 50107, EN 61547, EN 6100-3-2

**CE conform according to guidelines:**

89/336/EWG, 92/31/EWG, 73/23/EWG

Status: January 2011

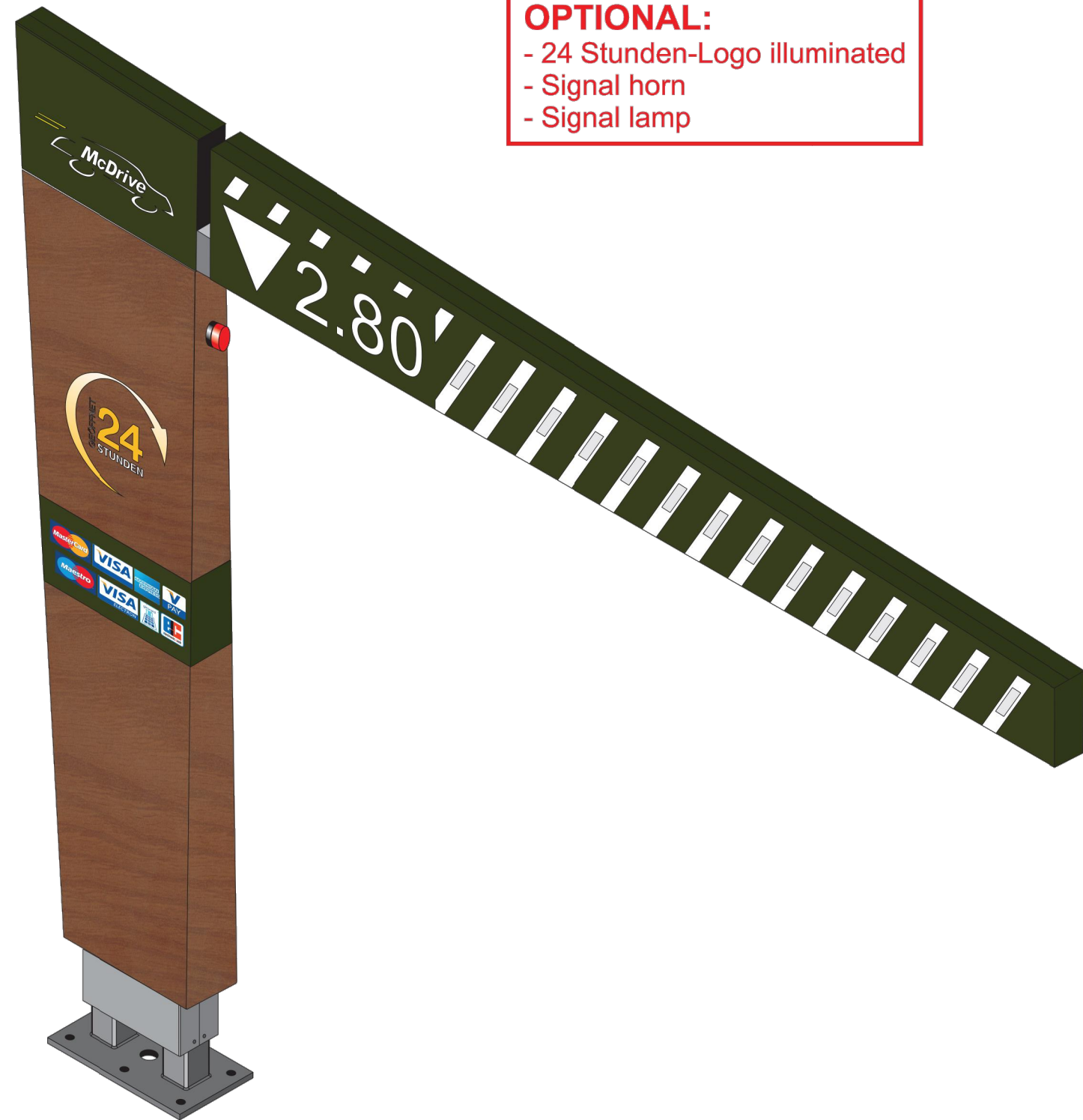
**OPTIONAL:**

- 24 Stunden-Logo illuminated
- Signal horn
- Signal lamp

## 124-427-001 Gateway Sign 1 - right

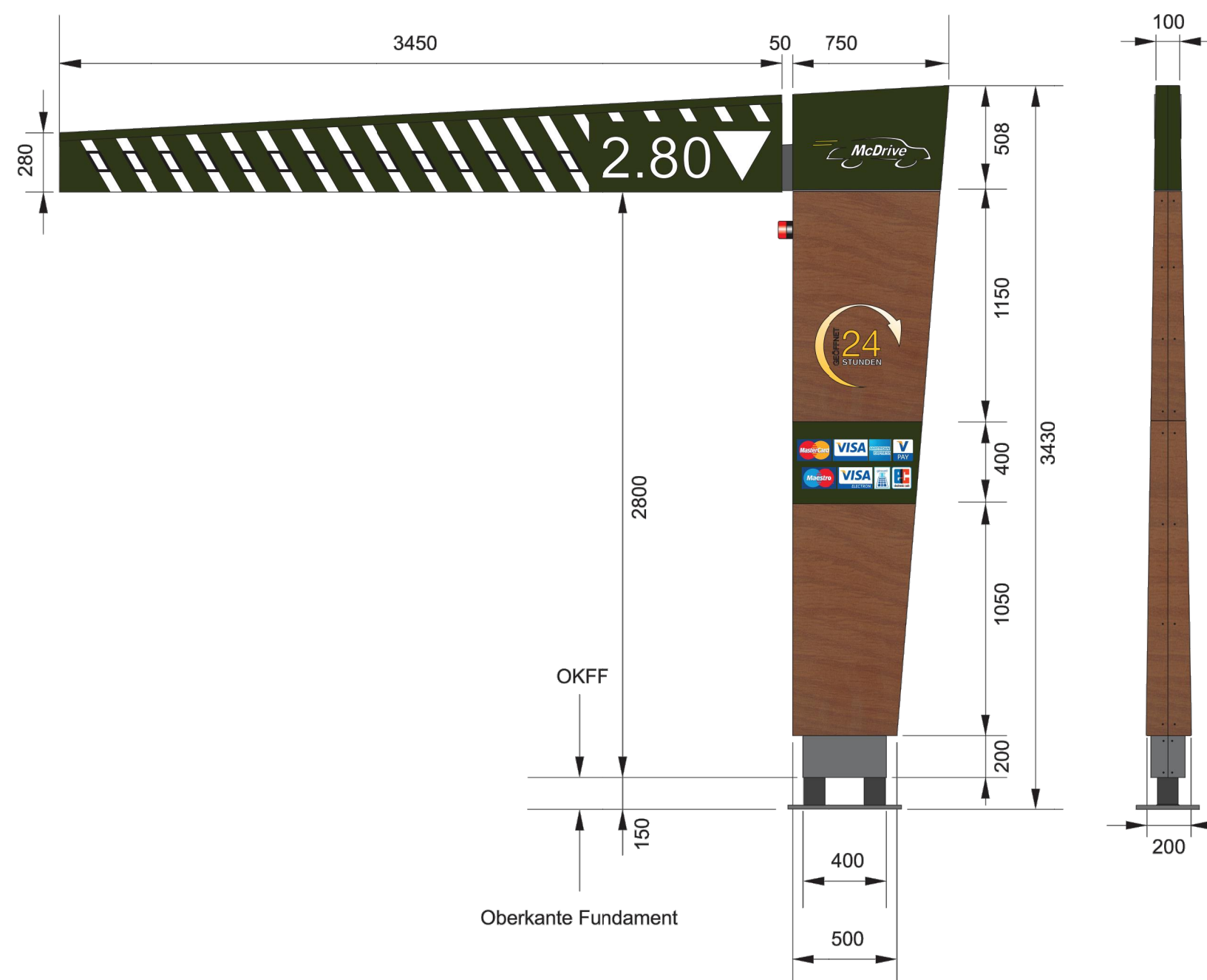
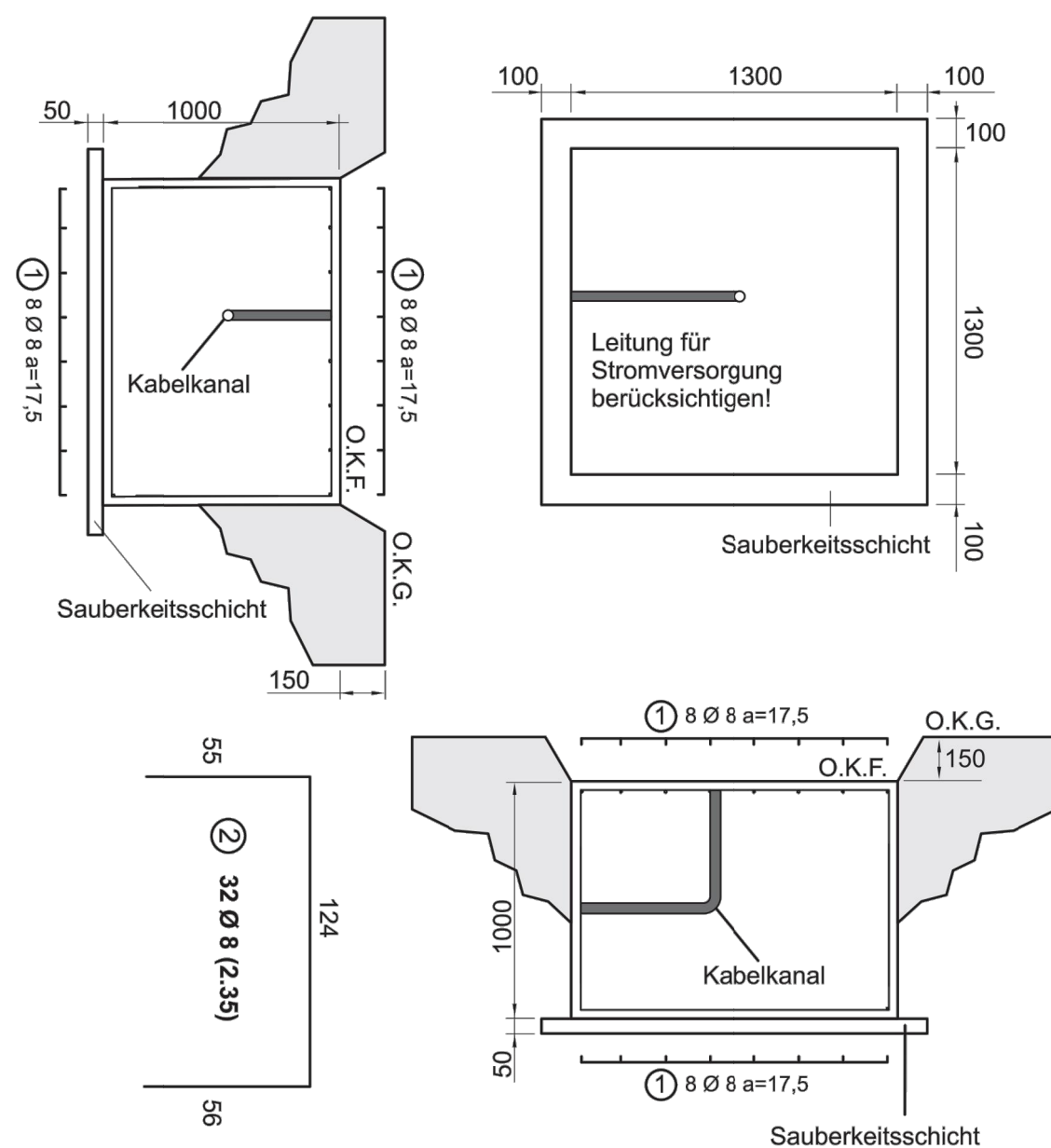

**A geotechnical survey should be done to confirm conditions for the Foundation.**

Individual Foundation drawings are available upon request.  
Local conditions and requirements should be observed and adhered to at all times.  
Foundations should only be planned and cast by suitably qualified persons.  
Lightning strike protection should be installed as per the local legal requirements.



**Dimensions:**

(WxHxD) Canopy: 2294 x 3525 x 200 mm

(WxHxD) Steel Frame: 800 x 2978 x 500 mm

**Design:**

Galvanized steel-construction coated in RAL 7022 - grey, case for COD coated in RAL 7022 - grey. Roof made of GRP, coated in white - RAL 9010. Triangle made of red, translucent acrylic glass with white opaque vinyl. Plinth made of Aluminium, coated in in RAL 7022. Additional LED modules for the illumination of the COD are installed under the canopy.

**Illumination:**

Internal illumination with LED.

**Technical Information:**

Nominal Voltage: 230V  
 Frequency: 50-60 Hz  
 Connected Load: 69 W  
 Connecting Cable: 3 x 1,5 mm<sup>2</sup>  
 Fuse Protection: C16 A

**Installation:**

Free-standing Installation with fixing bolts in existing foundation. Bolts according to DIN norm. When using Fixing Bolts ensure that the concrete has hardened sufficiently in accordance with specified requirements of the Bolt. Once connected and fitted the sign should be tested for functionality.

**Foundation/Fixing Material:**

1200 x 1200 x 1000 mm - Concrete C 25/30 / Fixing Bolts

**The Sign conforms with the following guidelines:**

VDE 0100, VDE 0128, VDE 0711, EN 55015, EN 60598, EN 50107, EN 61547, EN 6100-3-2

**CE conform according to guidelines:**

89/336/EWG, 92/31/EWG, 73/23/EWG





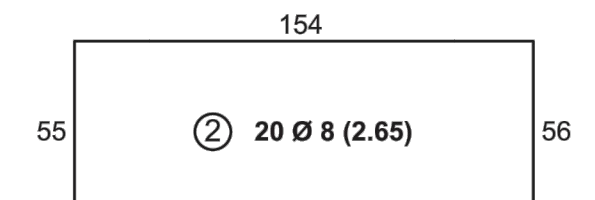
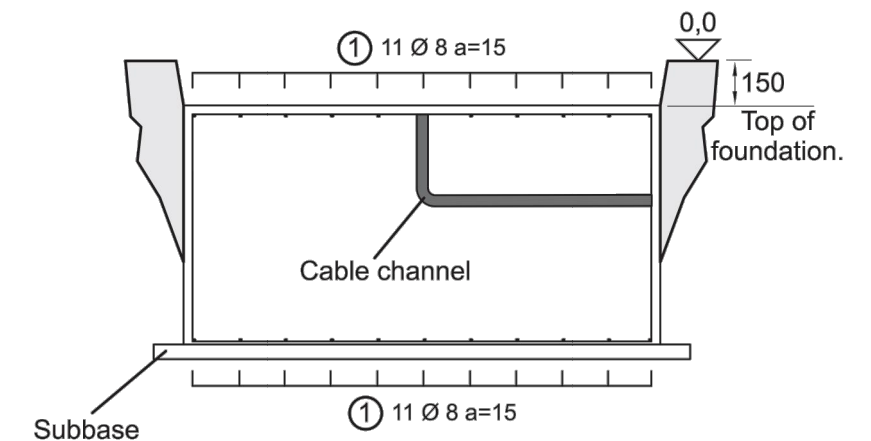
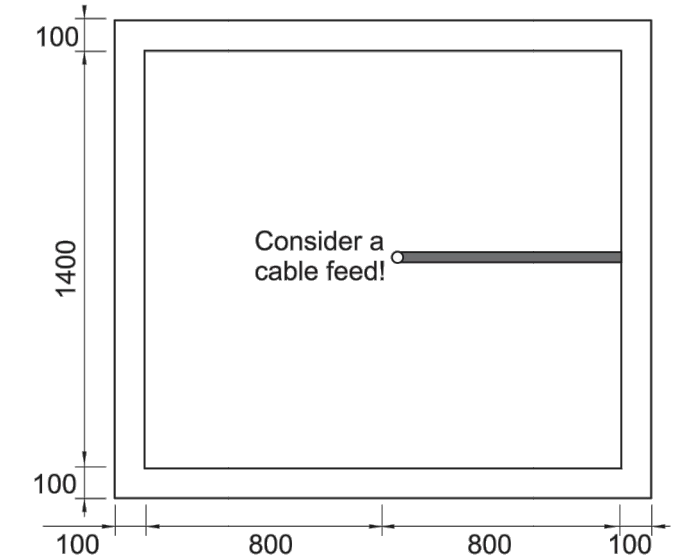
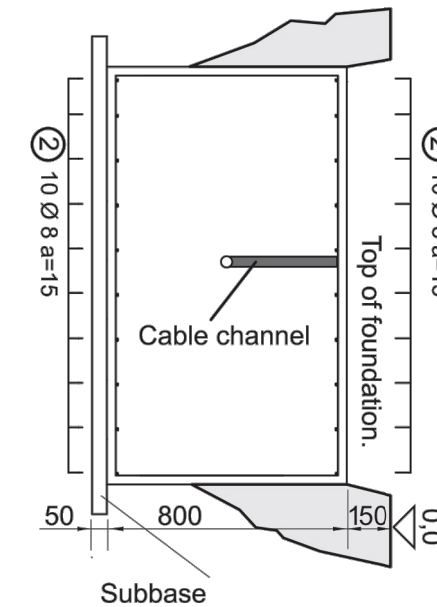
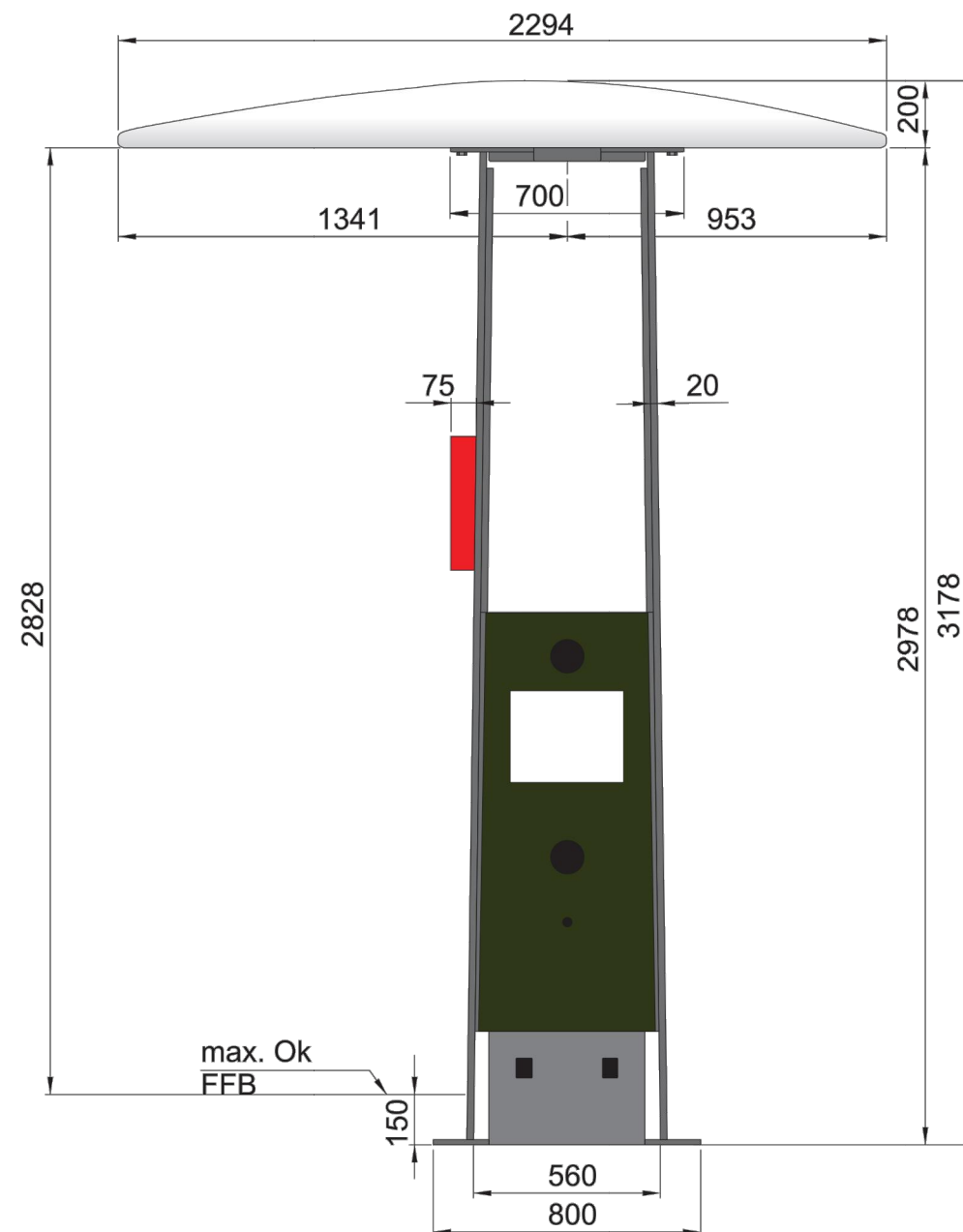
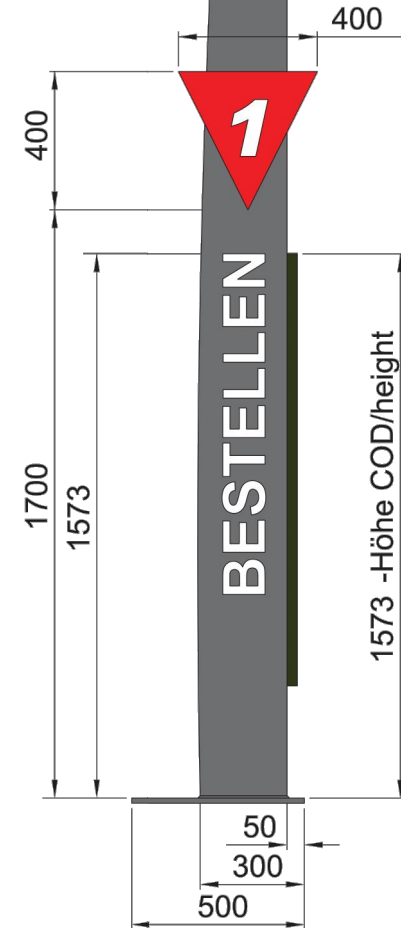
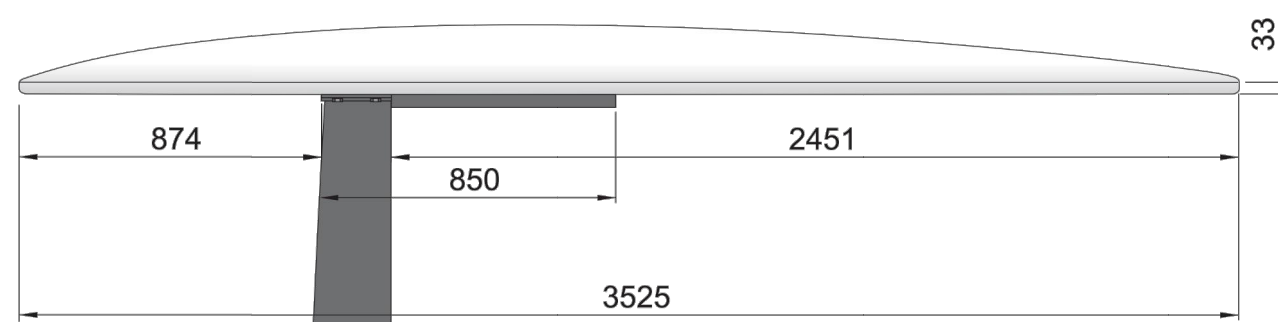

**A geotechnical survey should be done to confirm conditions for the Foundation.**

Individual Foundation drawings are available upon request.  
Local conditions and requirements should be observed and adhered to at all times.  
Foundations should only be planned and cast by suitably qualified persons.  
Lightning strike protection should be installed as per the local legal requirements.



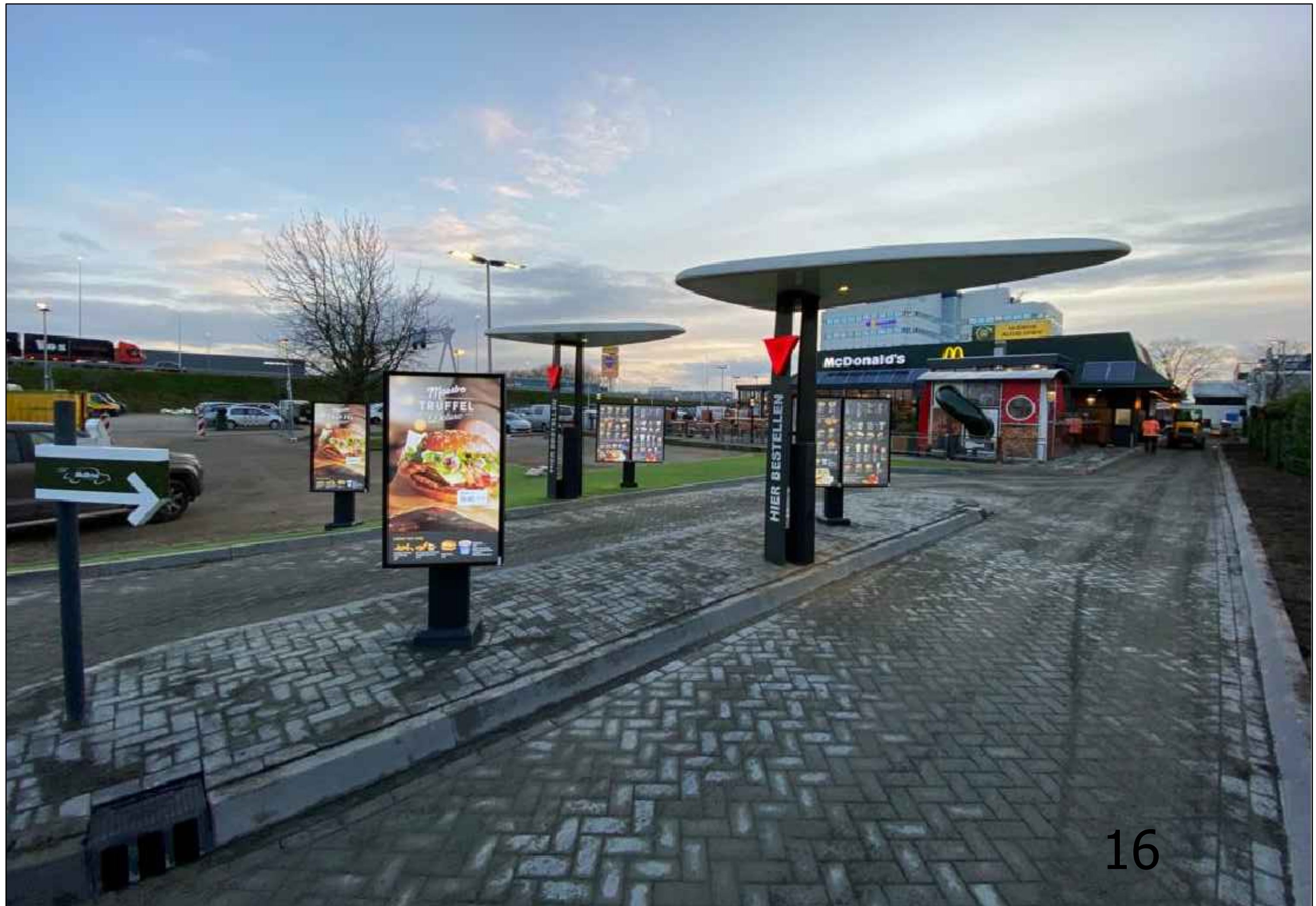





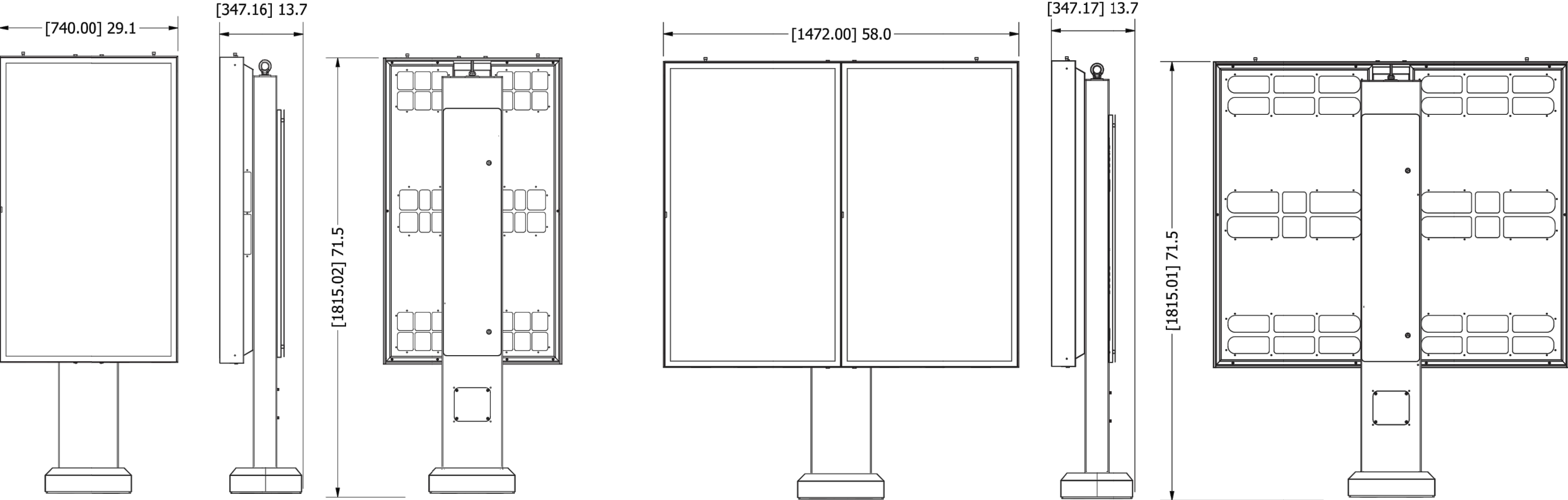



## 124-000-001 Trash Bin

**Dimensions:**

(WxHxD)

1440x 523 x 694 mm

**Design:**

Galvanized steel-post and foot-plate. Casing and trash bin made of Polyethylen. Waste container can be emptied after opening the door on the right hand side. Trash has a flap which can be moved with the handle on the left nad side.

**Installation:**

Free-standing Installation with fixing bolts in existing foundation. Bolts according to DIN norm. When using Fixing Bolts ensure that the concrete has hardened sufficiently in accordance with specified requirements of the Bolt.

**Foundation/Fixing Material:**

600 x 600 x 250 mm - Concrete C 25/30 / Fixing Bolts

**The Sign conforms with the following guidelines:**

See product information of the producer.

**CE conform according to guidelines:**



See product information of the producer.

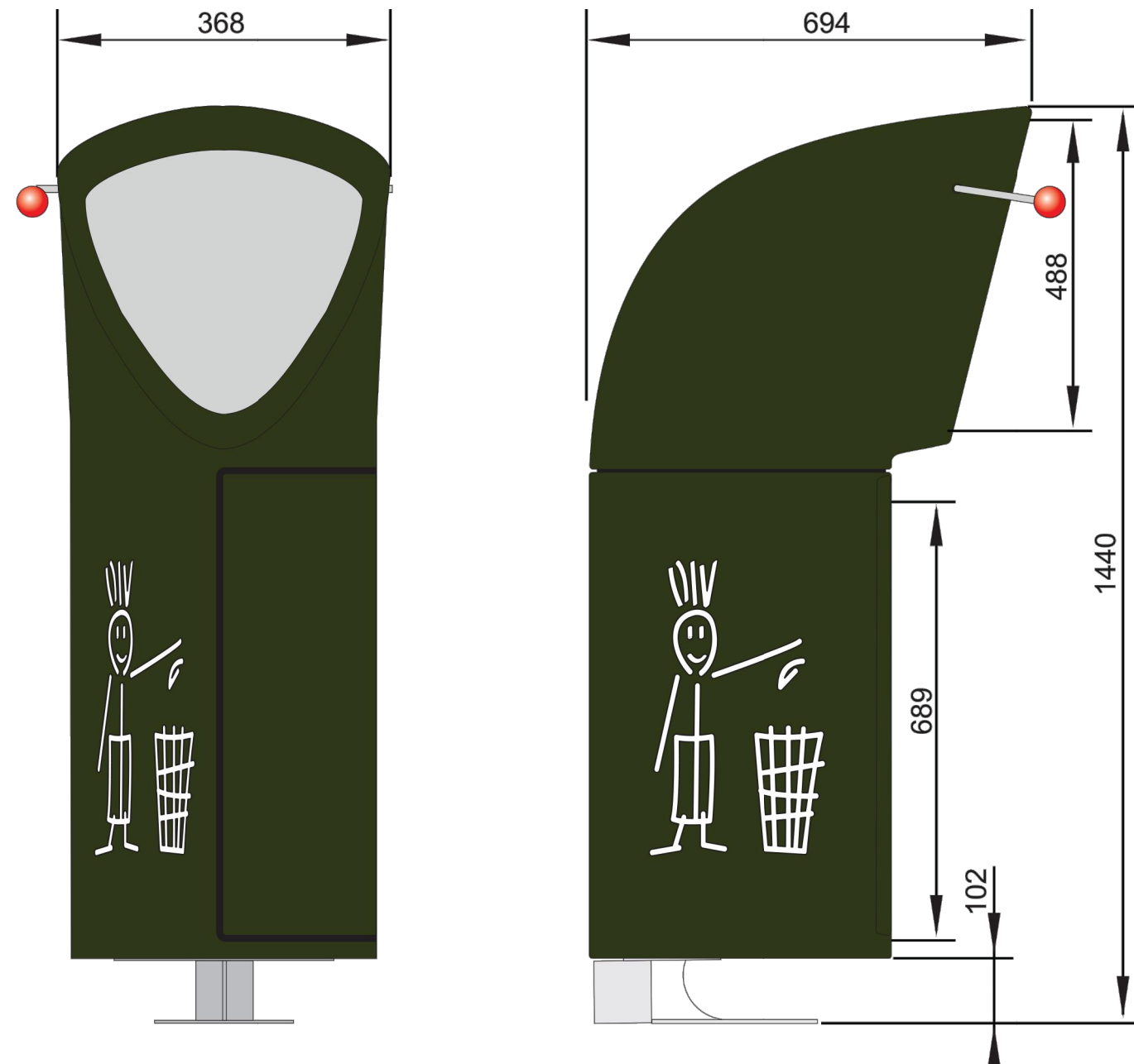

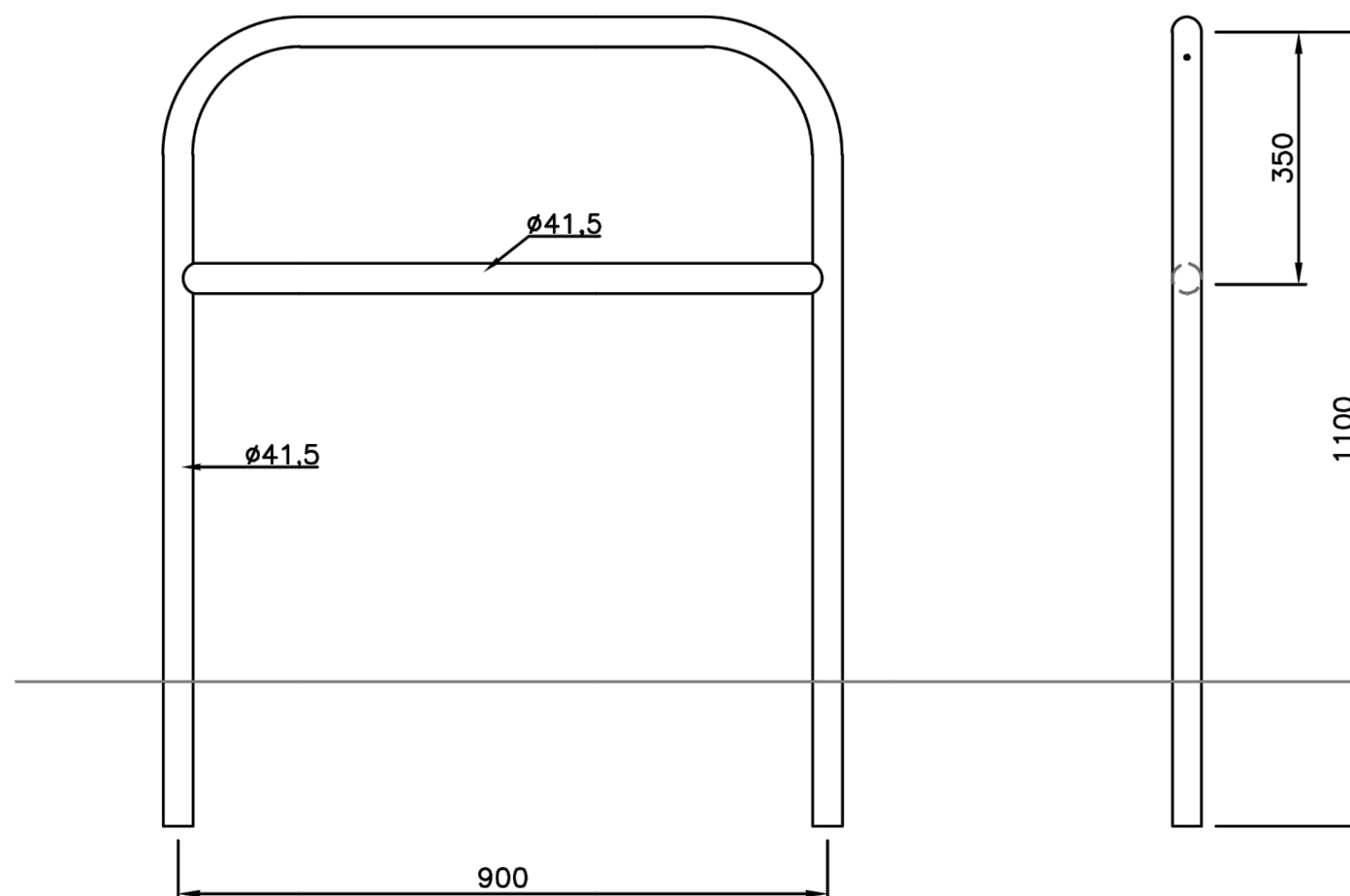
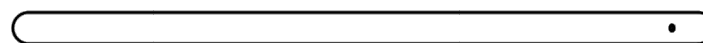
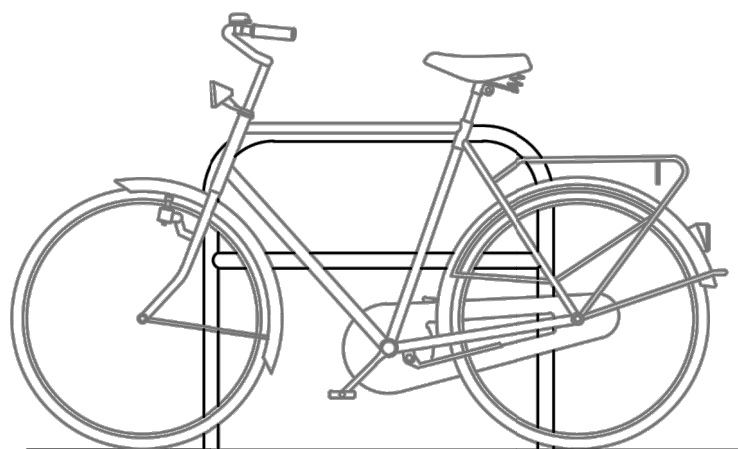



stalen aanleunbeugel met tussenbuis van rond 42mm, breedte 90cm, hoogte 90cm vanaf aangegoten betonvoeten 30x30x30cm

|  |             |  |              |               |   |
|--|-------------|--|--------------|---------------|---|
| <br>Postbus 18<br>NL 7670AA Vriezenveen<br>tel. 0546-554444<br>fax. 0546-561115 | Wijzigingen | benaming   | schaal       | 1:10          |  |
|  | Datum door  |  | formaat      | A3            |   |
|  | 27-10-11 HZ | Art nr. 02.010.000   | datum        | 09-11-98      |   |
|  | -           | opm.<br>Fietsaanleunbeugel met<br>tussenbuis 41,5 900x1100 | getekend     | P.v.U         |   |
|  | -           |  | cc verkoop   | ja            |   |
|  | -           |  | extern       | ja            |   |
|  | -           |  | tekening nr. | 02.010.000 VK |   |

# FENCING AND LIGHTING E3

## DESCRIPTION

### FENCING RAILING NORM

#### MATERIALS

Electro-galvanised steel structure, polyester powder coated. Railing and handrail in aluminum, polyester powder coated. Stainless steel screws.

#### GROUND FIXATION

Concrete screws Ø 7.5 mm x 100 mm

#### MEASUREMENTS

Height: 1 m

Length: 1800 mm

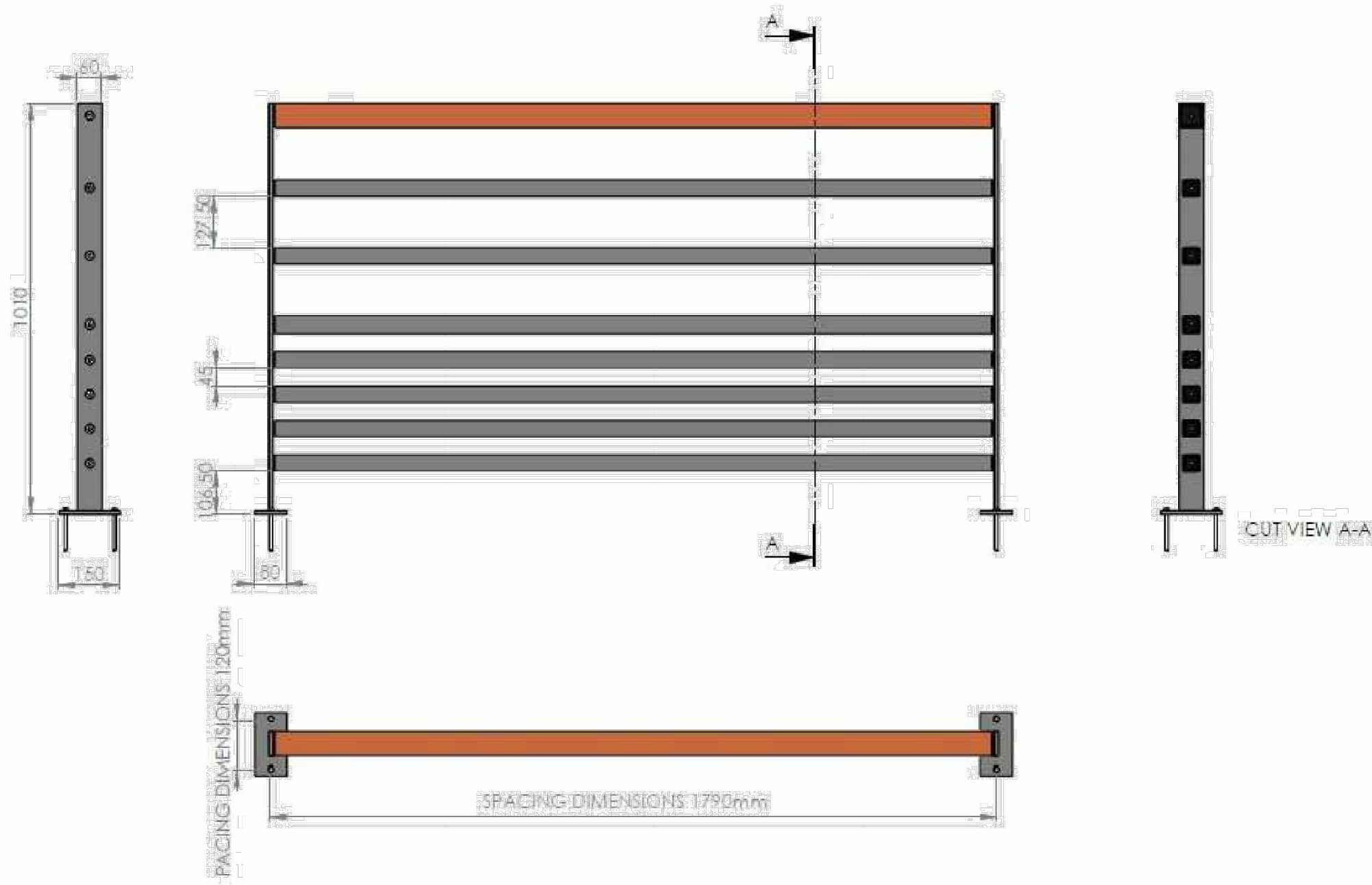

## McDONALD's Terrace Furniture

### wind screen and lighting

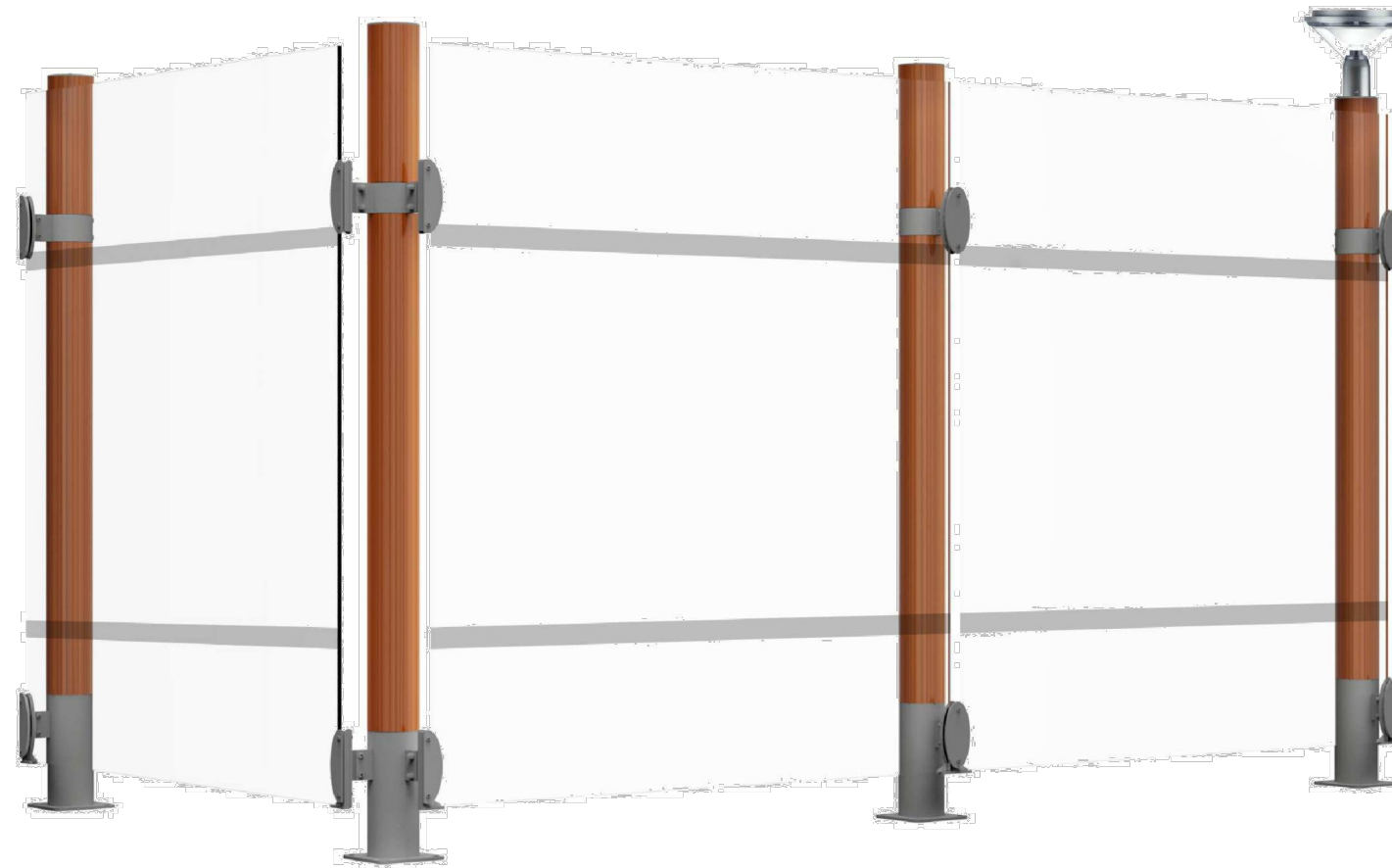

\* **Glass element** H:1750mm  
with visual guideline stripe

**Recommended glass panels :**  
Stadip 5-5-2 from St Gobain  
Height = 1750mm  
Width : according to installation

\* Lantern can be supplied upon request

#### **General conditions :**

- \* EXW prices - excluding installation
- \* Payment at 30 days from date of invoice
- \* Overdue payment : outstanding interest rate based on legal rate x1,6 prorata temporis

#### **Particular Conditions :**

- \* Product supply only

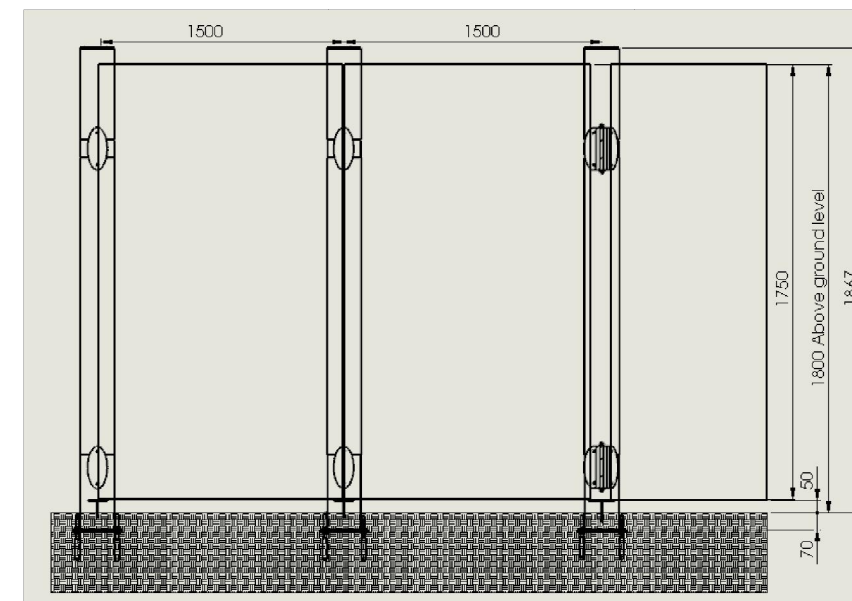

Dimensions in mm



# PRODUCTS

## FENCING



Twilight luminaire

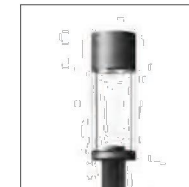

Bega luminaire



## WINDSCREEN



MOSHI POLE 5 M  
LIGHTING POINT





vlaggenmast