

Principe Waterinstallaties

Doorstroom principe drinkwaterinstallatie Studio's

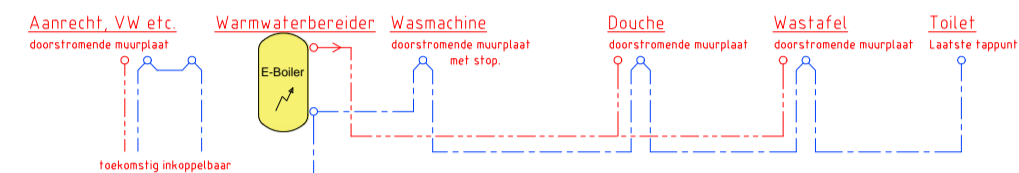

Algemeen

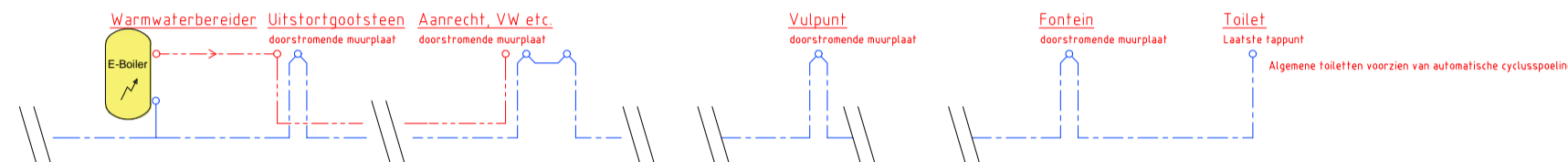

Waterbehandeling en verdeling

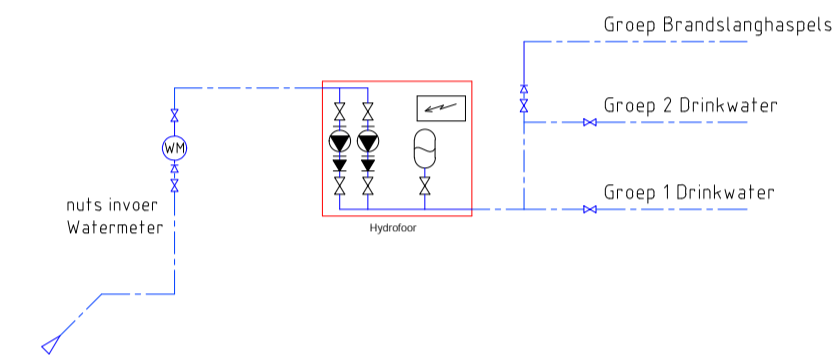

RENVOOI:

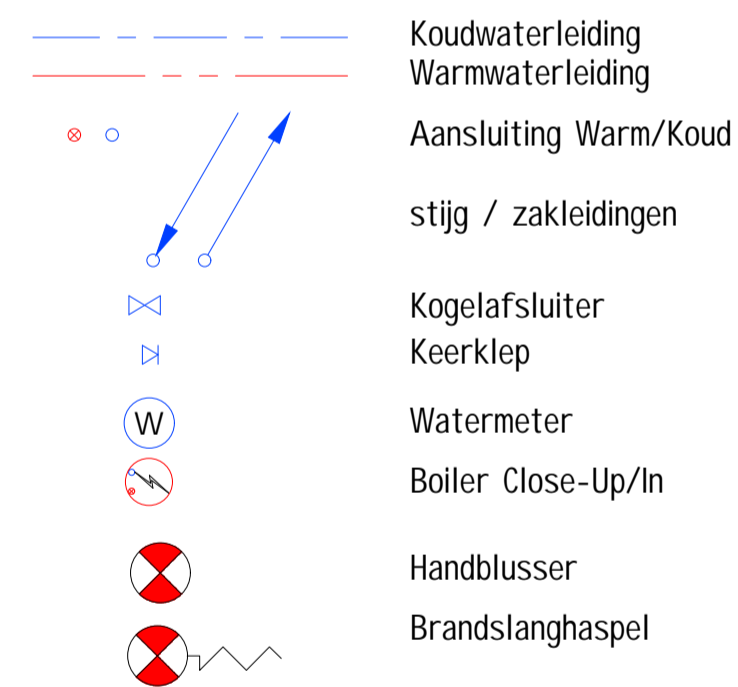

OPMERKINGEN

- Koudwaterleidingen isoleren met armaflex, 9mm dik.
- Waterleidingen in fundering/kruipruimte
- Toestellen en aansluitingen conform leverancier sanitair

RENVOOI:

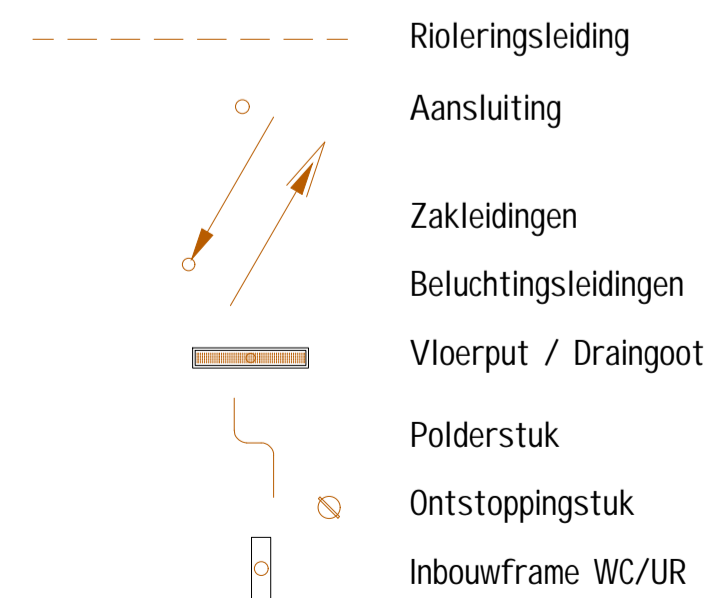

OPMERKINGEN

- Leidingafschot minimaal 5mm/m.

Principe woonkamer-eetkamer algemeen Waterinstallaties en Rioleringsinstallaties

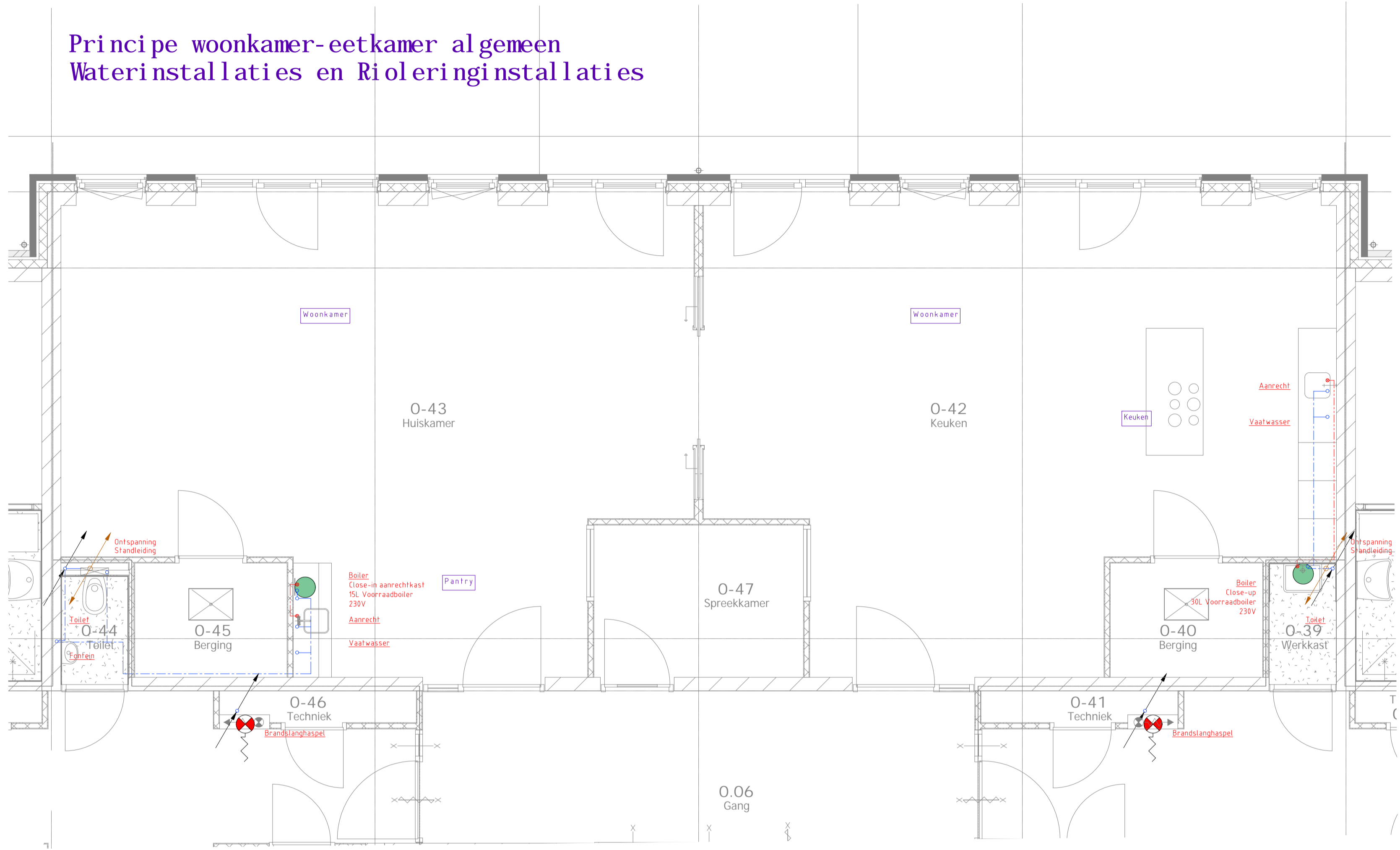

Principe uitloop Rioleringsinstallaties

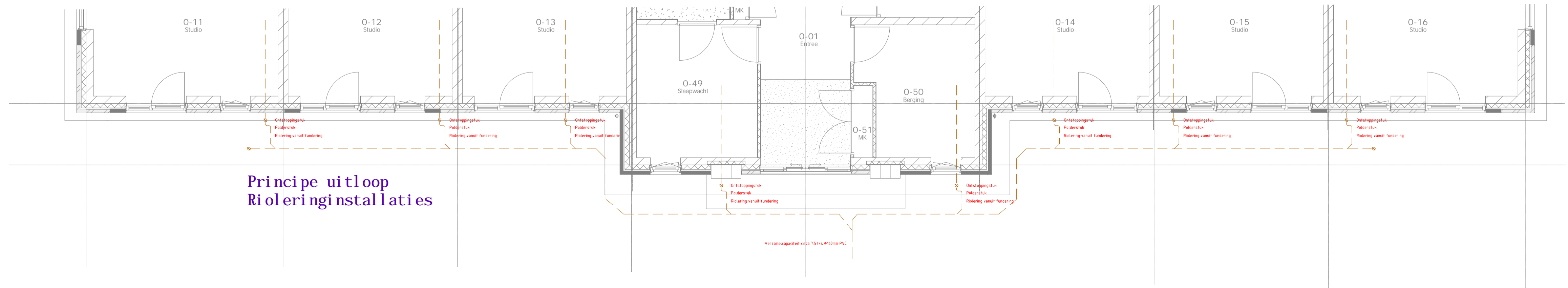

Vergunning

datum wijz.:	project:	Zorgcomplex Het Heemse Hof te Hardenberg	opdrachtgever:	Loostad	
	schaal:	1:75	proj.nr.:	23220	
datum:	19-12-2023	getekend:	SM	tek.nr.:	S001
Formaat:	A1	gezien:	MB	status:	DO

STRAKKS
INGENIEURS