

| | | | |
|-----|----|----|----|
| P | P | P | P |
| 100 | 99 | 98 | 97 |

| | | | | | | | |
|----|----|----|----|----|----|----|----|
| 29 | 28 | 27 | 26 | 25 | 24 | 23 | 22 |
| P | P | P | P | P | P | P | P |

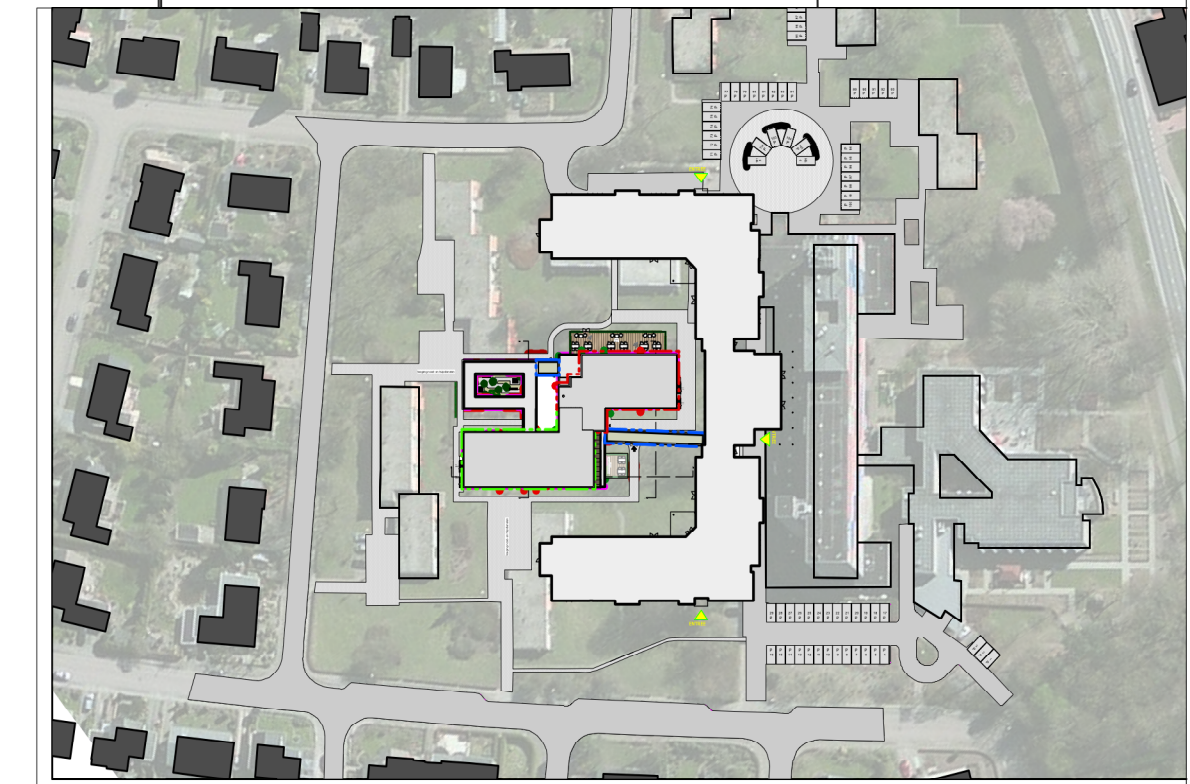

| | | |
|---------------------|--------|------------|
| kadastrale gemeente | GOOR | orientatie |
| sectie | C | |
| perceel | 6189 | |
| schaal | 1:2000 | |

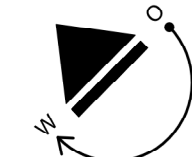

Borne

Molenstraat 124

7622 NG Borne

+31 74 266 24 30

info@tekiefte.nl

Rotterdam

Weena 723

3013 AM Rotterdam

+31 10 203 85 95

atelier@tekiefte.nl



| te kiefte architecten bv | architectuur | tuin & landschap | atelier |

onderwerp
NIEUWE SITUATIE
blad
B01

| | | | |
|---------------|----------------------------|-------|-----------|
| werknnummer | 22037 | 1:200 | schaal |
| datum | 08-09-2023 | A1 | formaat |
| opdrachtgever | Twinta Hengelo | | getekend |
| project | Aanpassing woonzorgcentrum | | architect |