

Stalen dakplaten SAB158R (2 of 4 velds)

NOTITIE

- VOOR COSTRUCTIEVE UITGANGSPUNTEN ZIE RAPPORT INDU200360.74.521
- VOOR GEWICHTSBEREKENING ZIE DOCUMENT INDU200360.74.108
- BIJBEHORENDE BOUWKUNDIGE TEKENING: INDU200360.69.102
- Staalkwaliteit: S355J2
- De palen en de funderingsconstructie (betonconstructie) worden uitgewerkt door derden

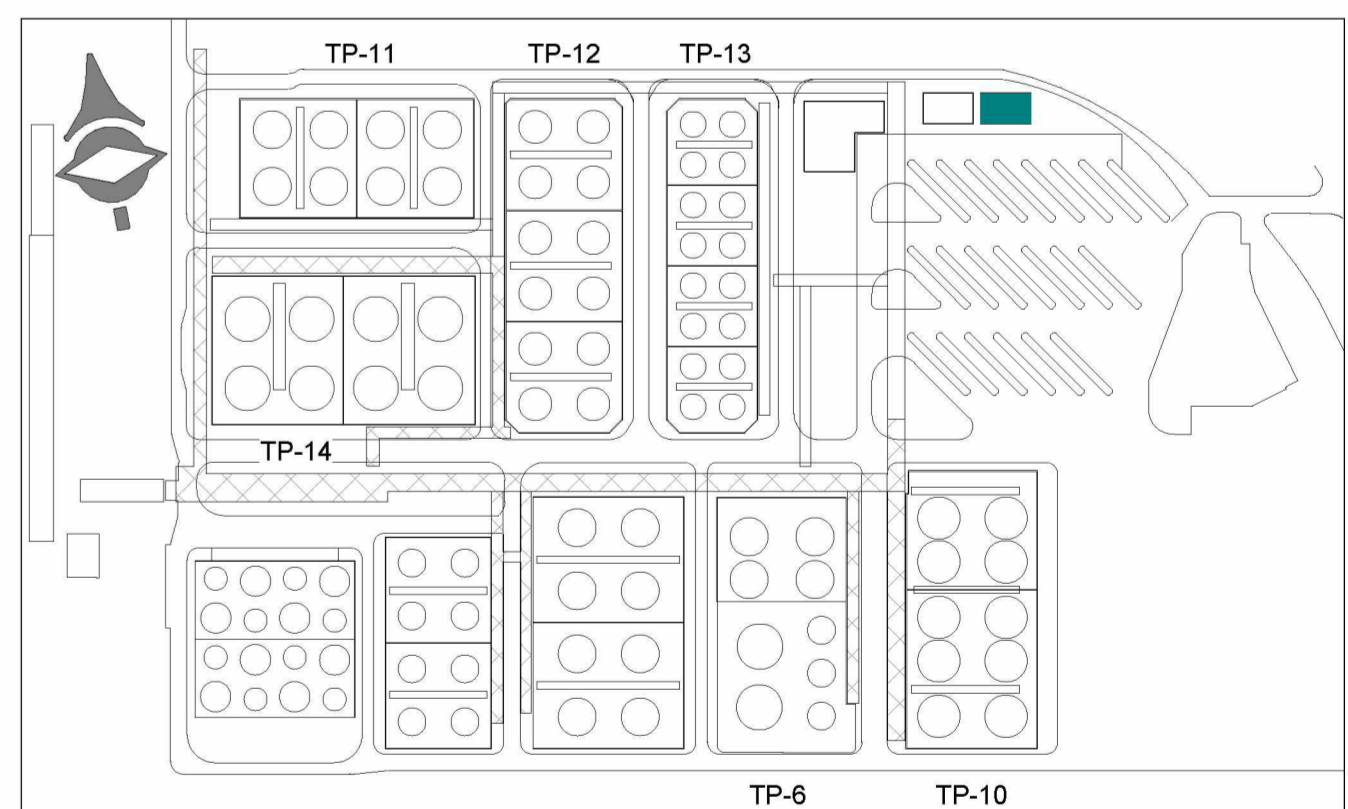
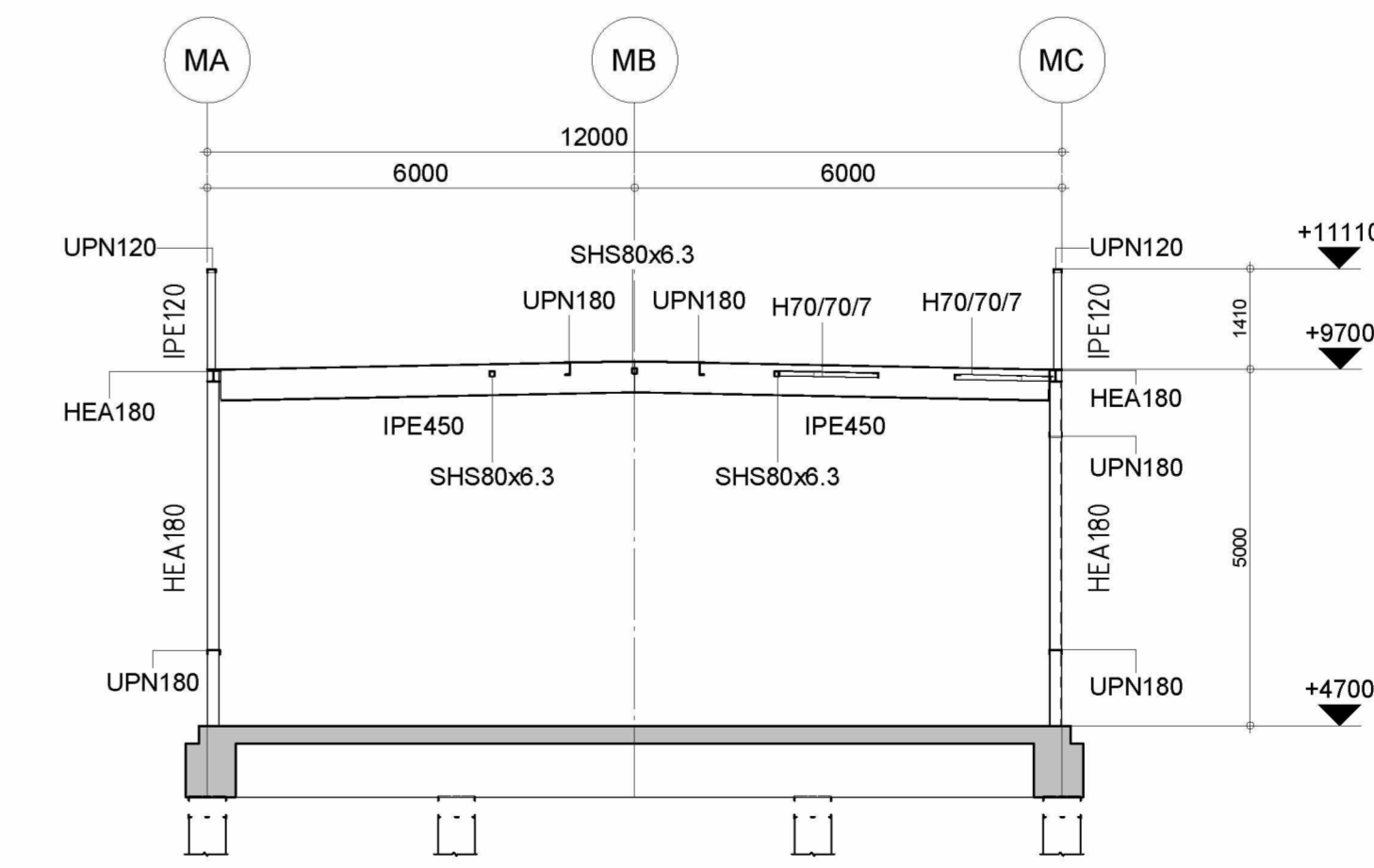
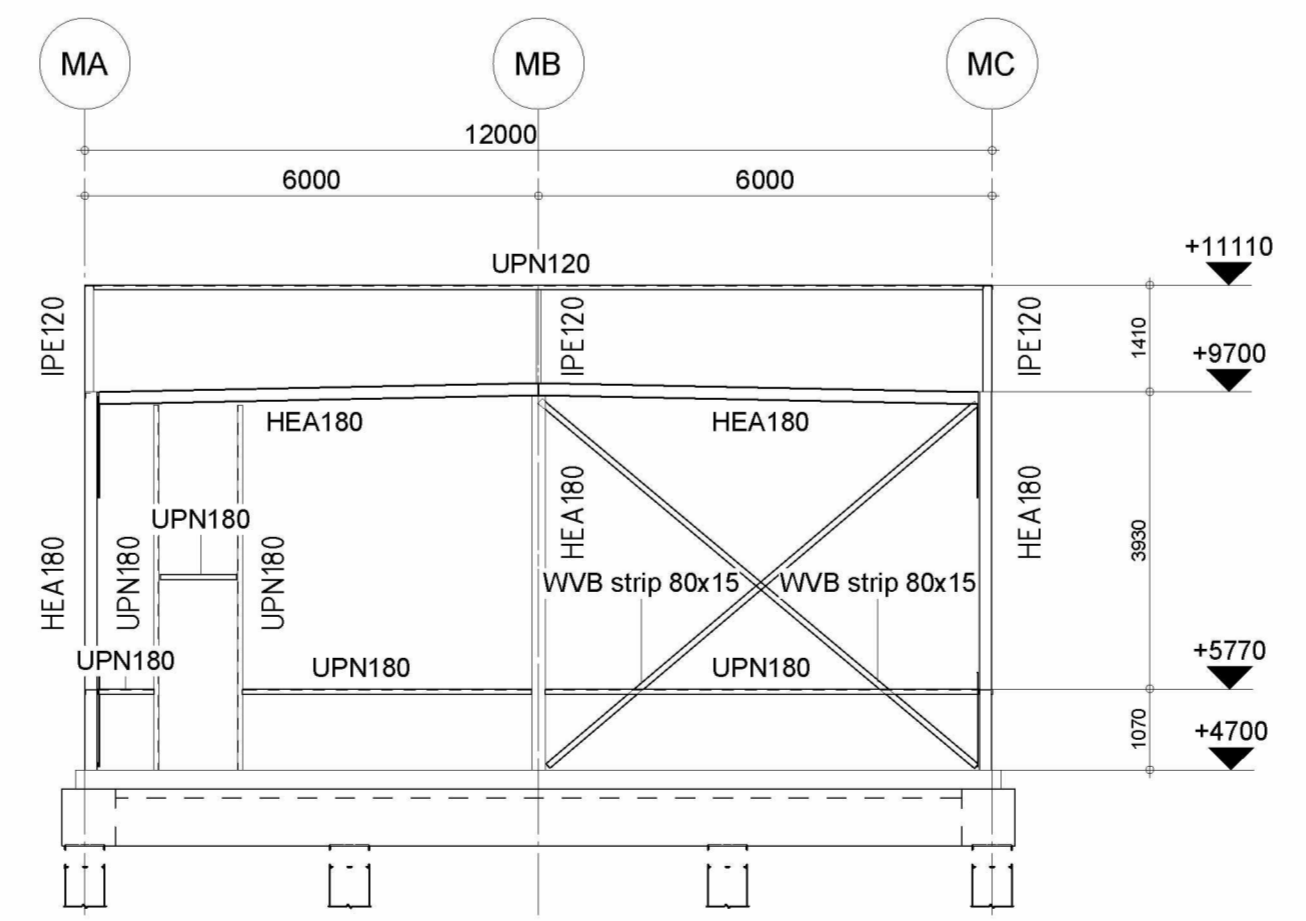
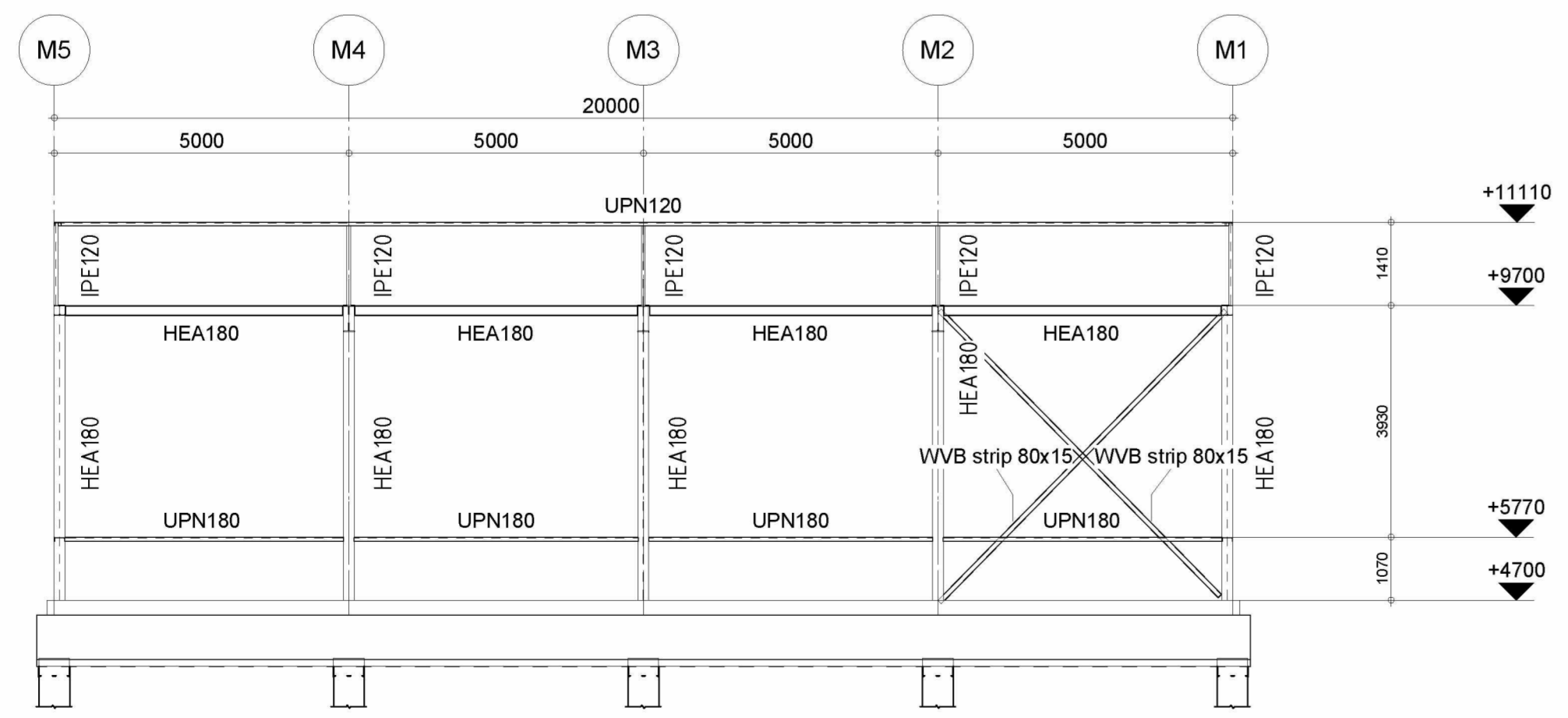
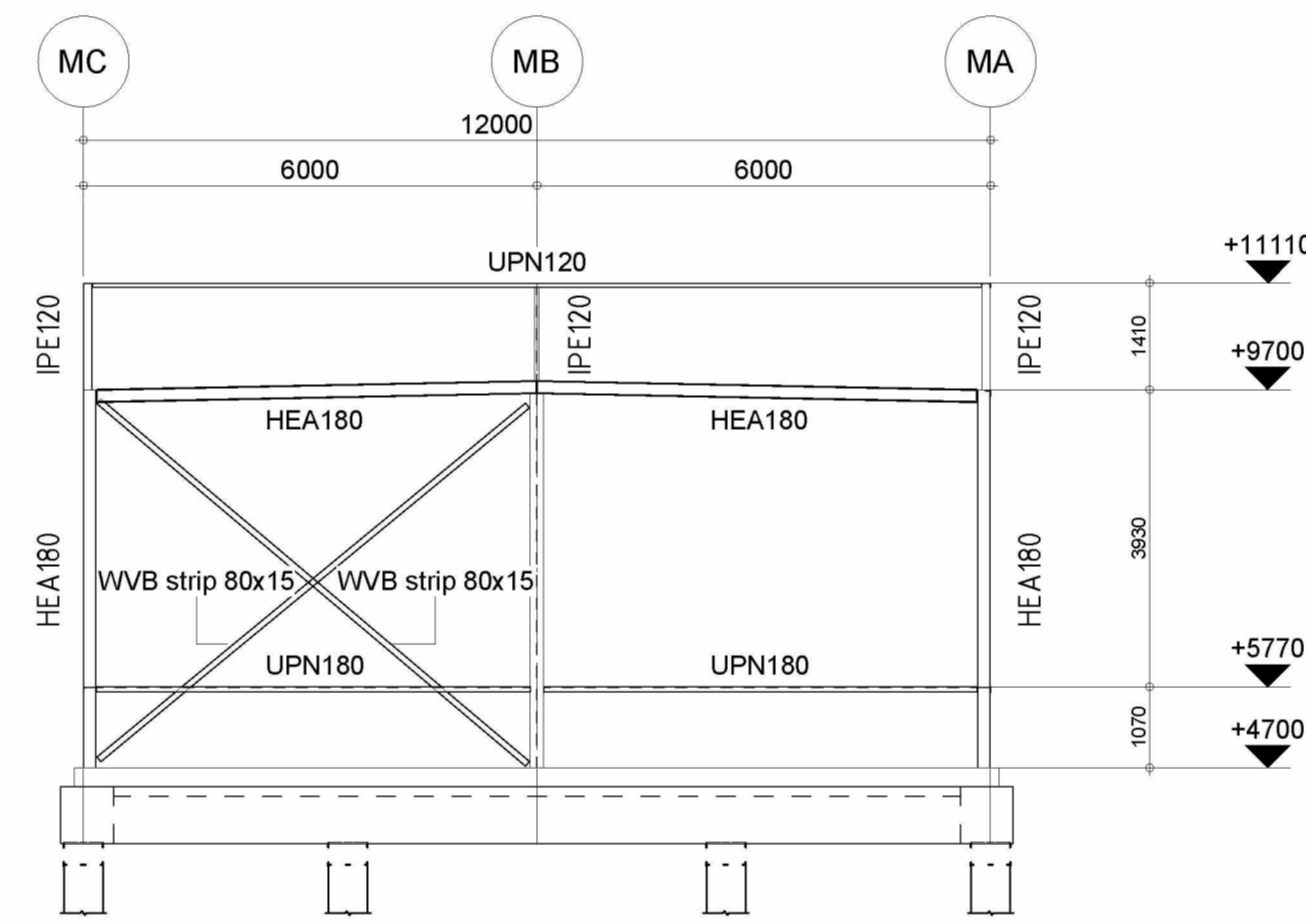
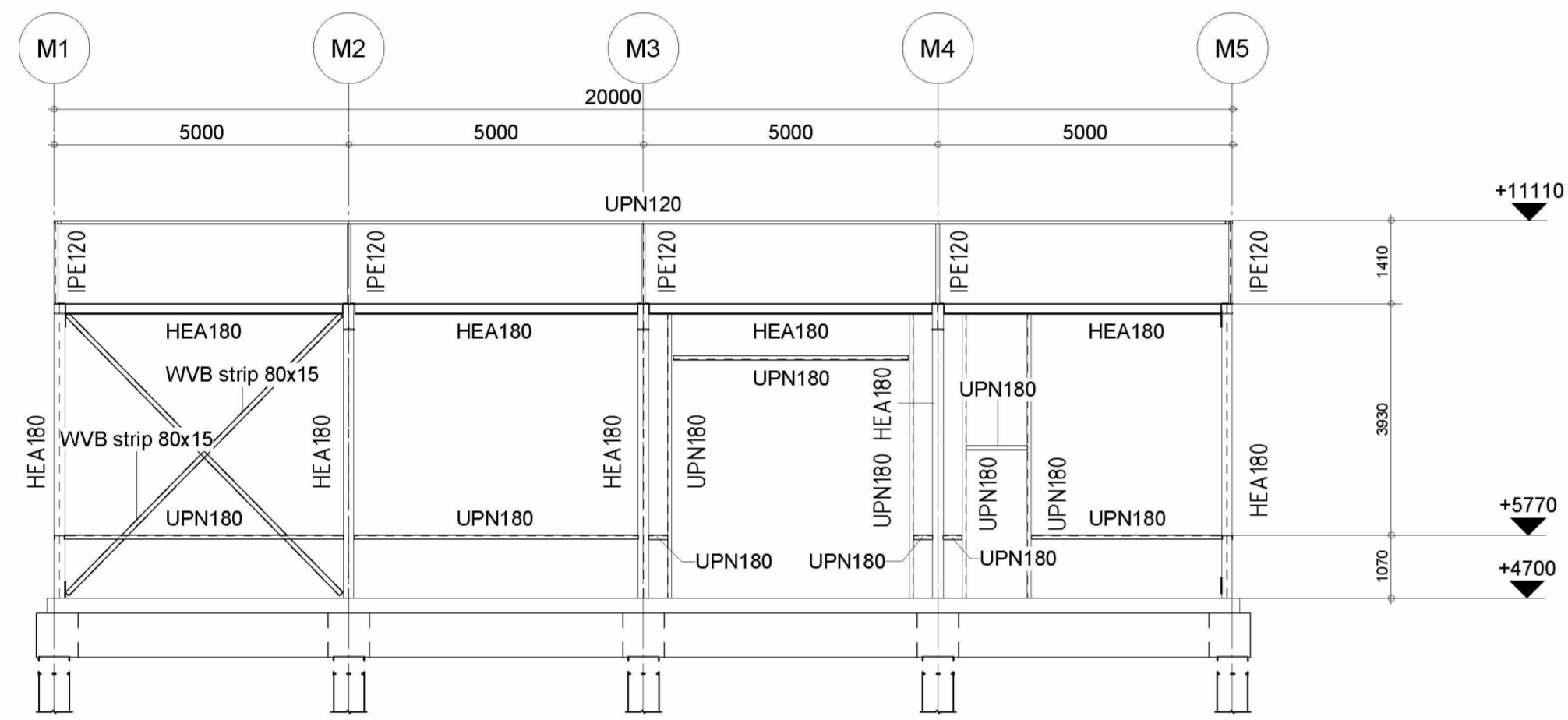
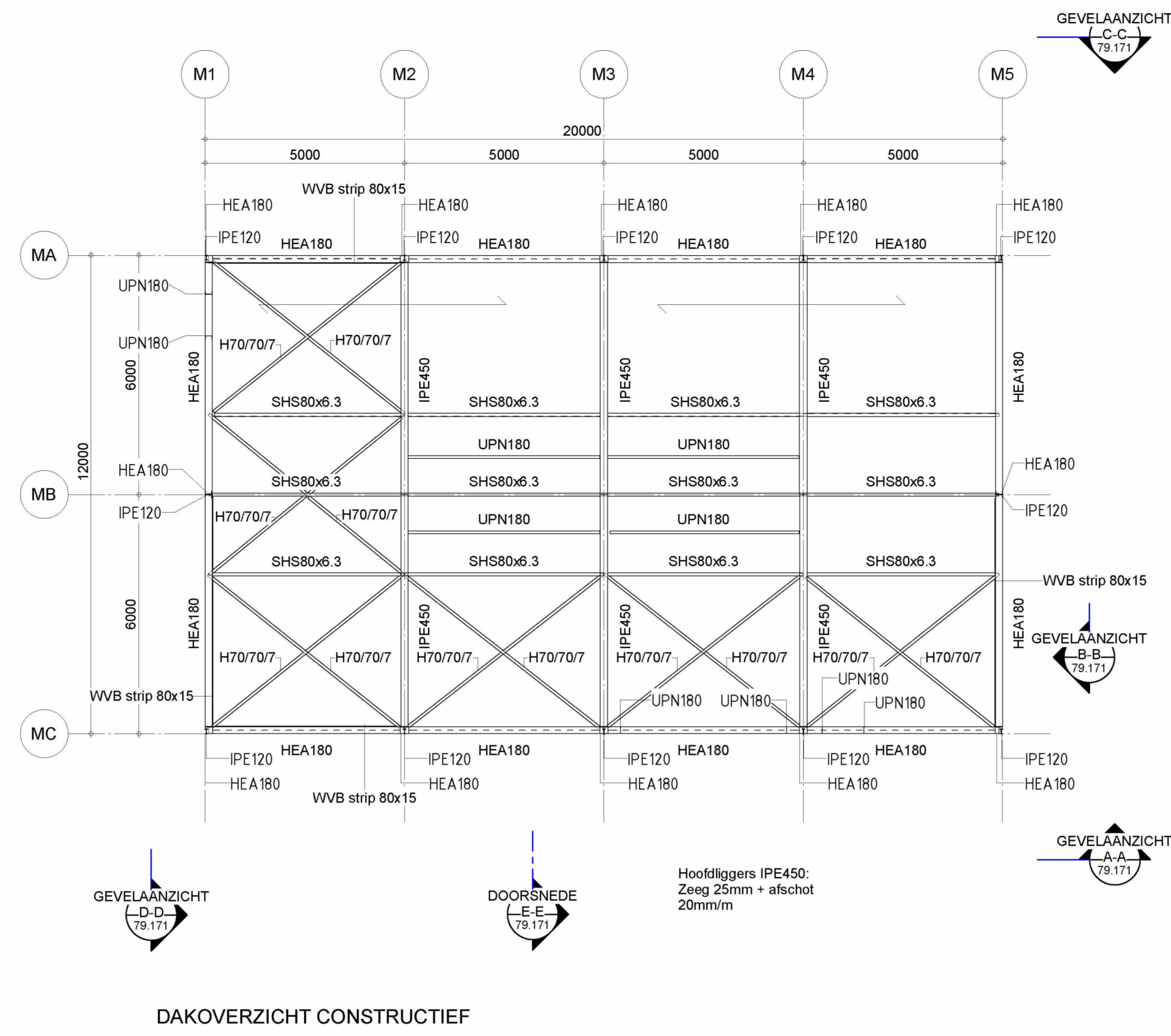
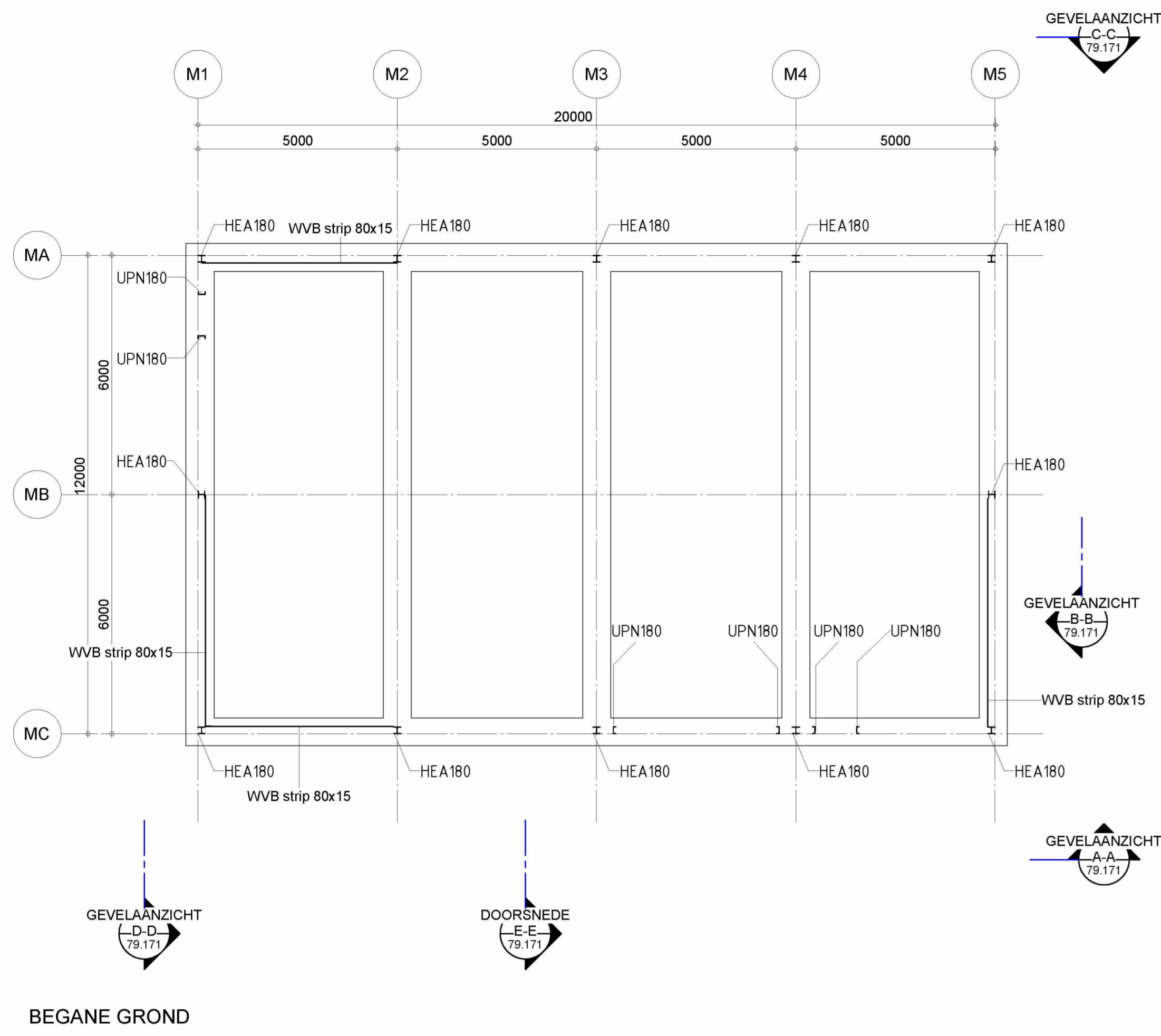

MATEN T.O.V N.A.P.

No.	Date	Issued for	Issue / Description	Made by	Checked by	Approved by
01	02-04-2021	ISSUED FOR COMMENTS		ISR	CEJ	MAL

Legal owner:

**LBC Rotterdam B.V.**  
 Oude Maasweg 4  
 3197 KJ Botlek - Rotterdam  
 The Netherlands  
 T www.lbcct.com

This drawing and its content remain the (intellectual) property of LBC Rotterdam B.V. The drawing shall at no time be copied, shown to third parties, or used for any purpose other than for which it was specifically provided.

Titel: **MAGAZIJN, STAALCONSTRUCTIE PLATTEGRONDEN, GEVELAANZICHTEN EN DOORSNEDEN**

Scale: 1:100  
 Language: NL

Identification number: **IDHA200360.79.171**

Sheets:	Document type:	Document status:	Department:	Technical reference:
---------	----------------	------------------	-------------	----------------------