

POER ASSEN F/FS
TYPE A

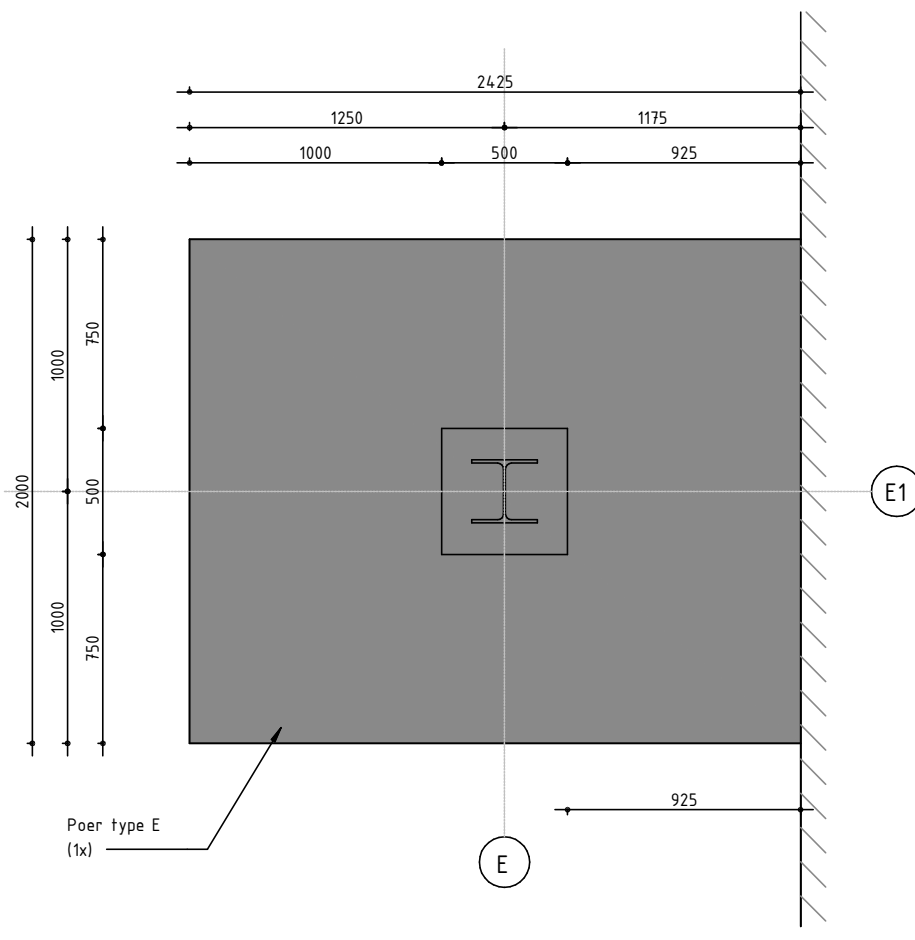

POER ASSEN E/E1
TYPE E

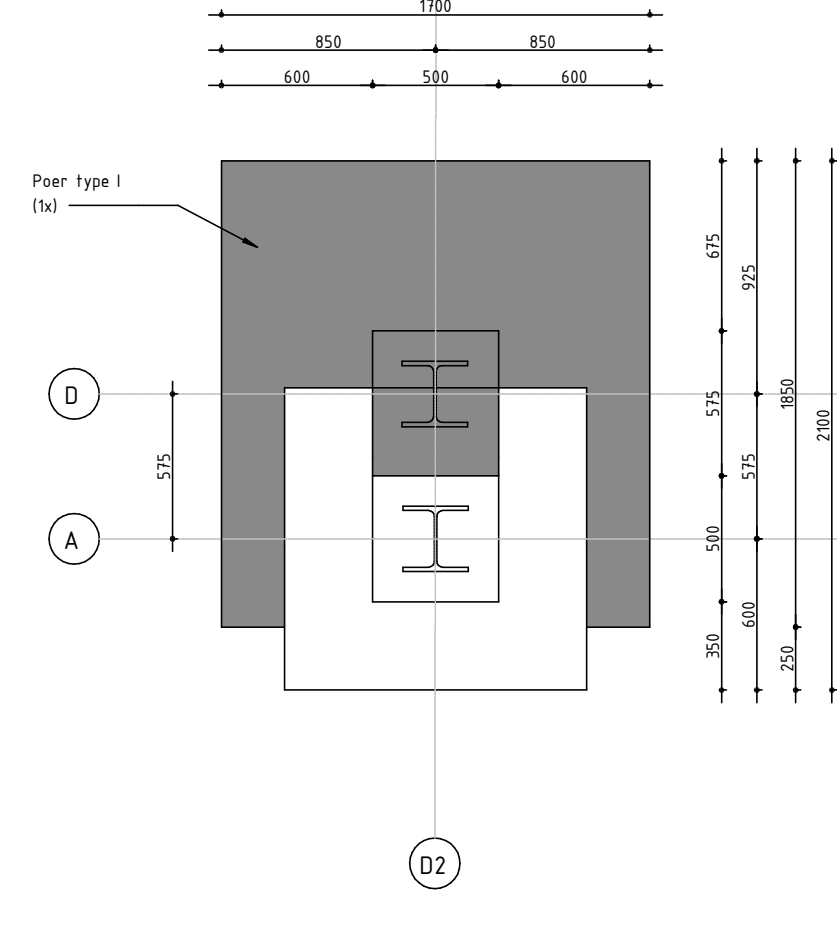

POER ASSEN D/D2
TYPE I

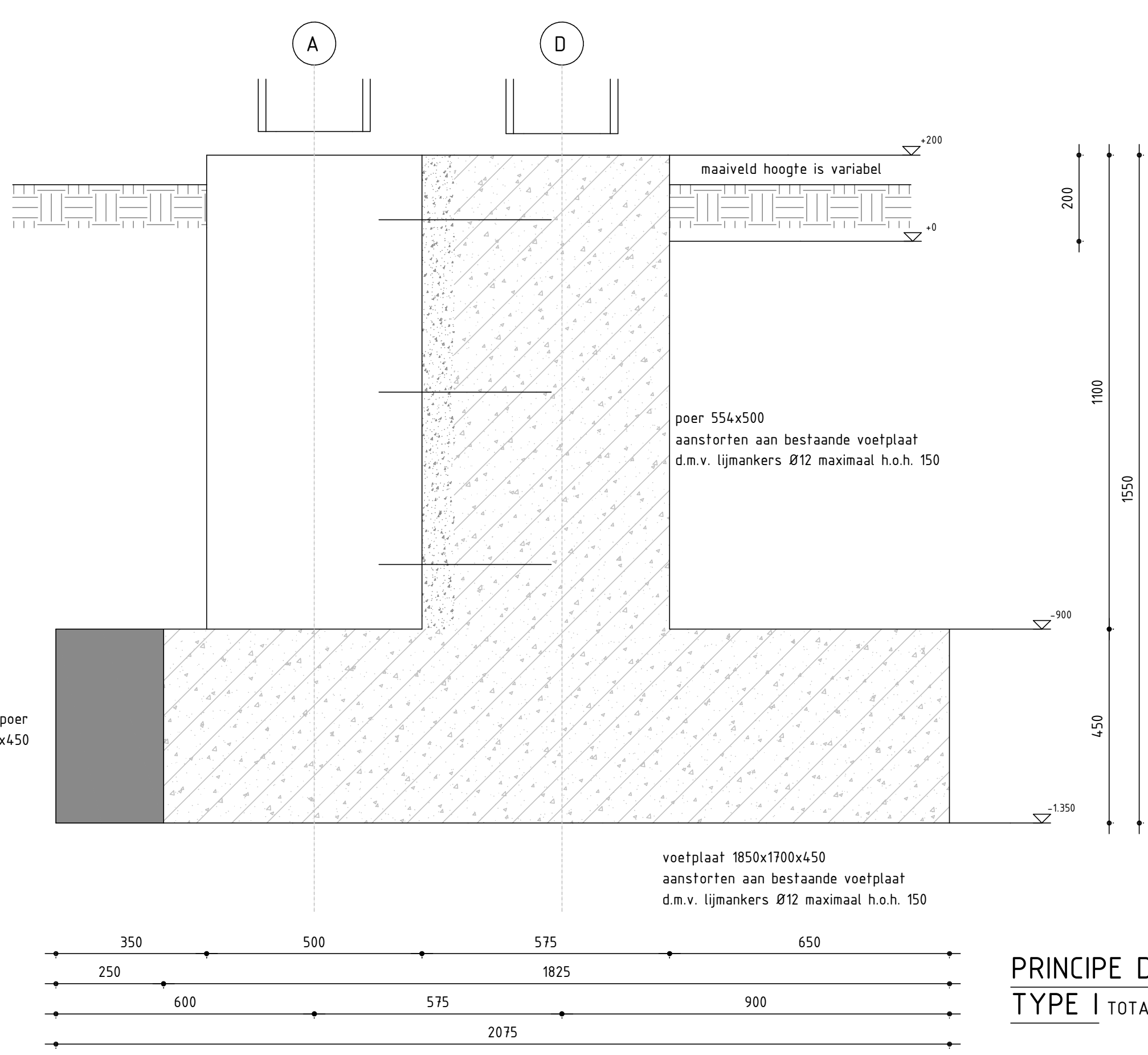

PRINCIPE DETAIL POER
TYPE I TOTAAL 1X UITVOEREN

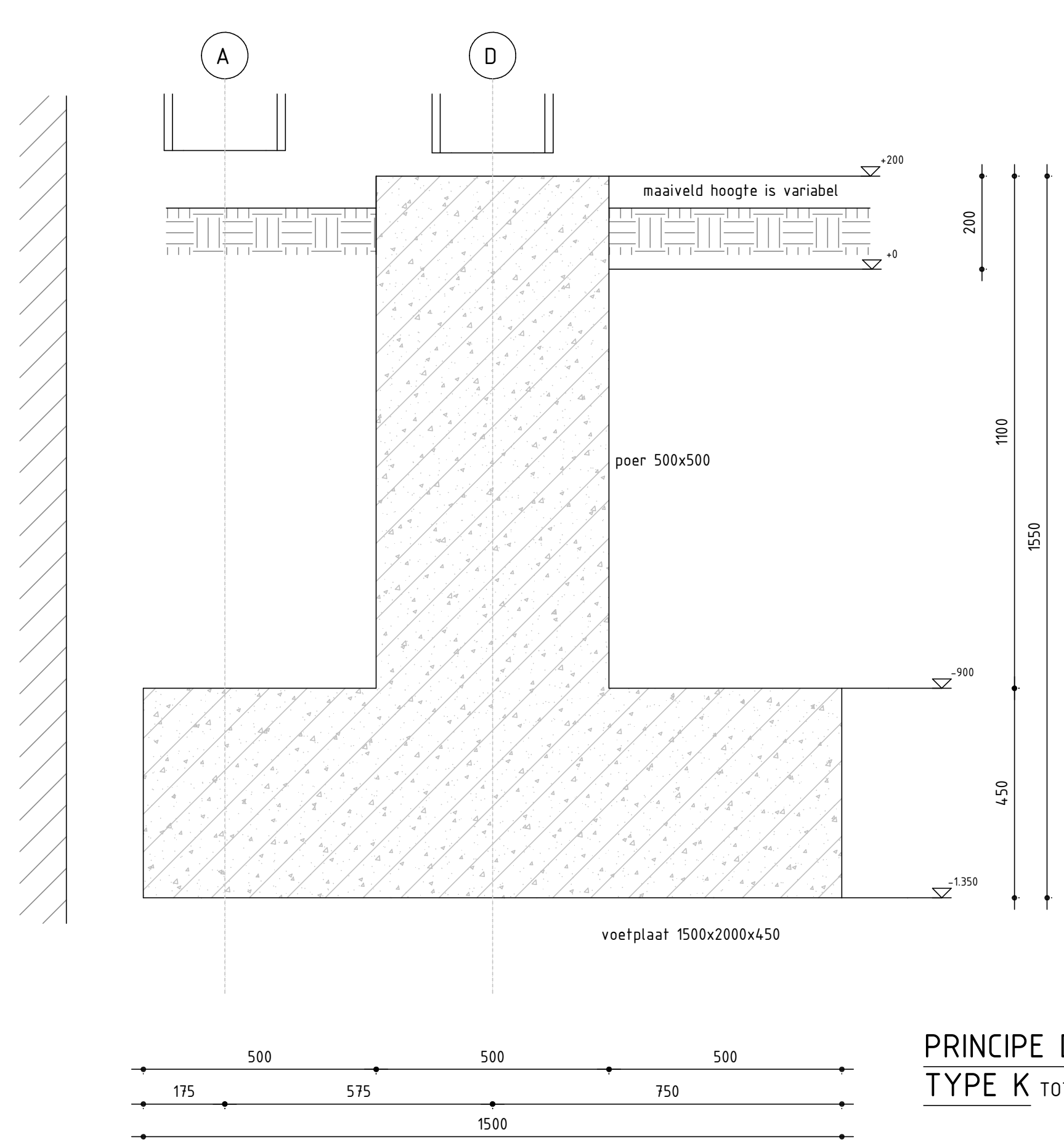

PRINCIPE DETAIL POER
TYPE K TOTAAL 1X UITVOEREN

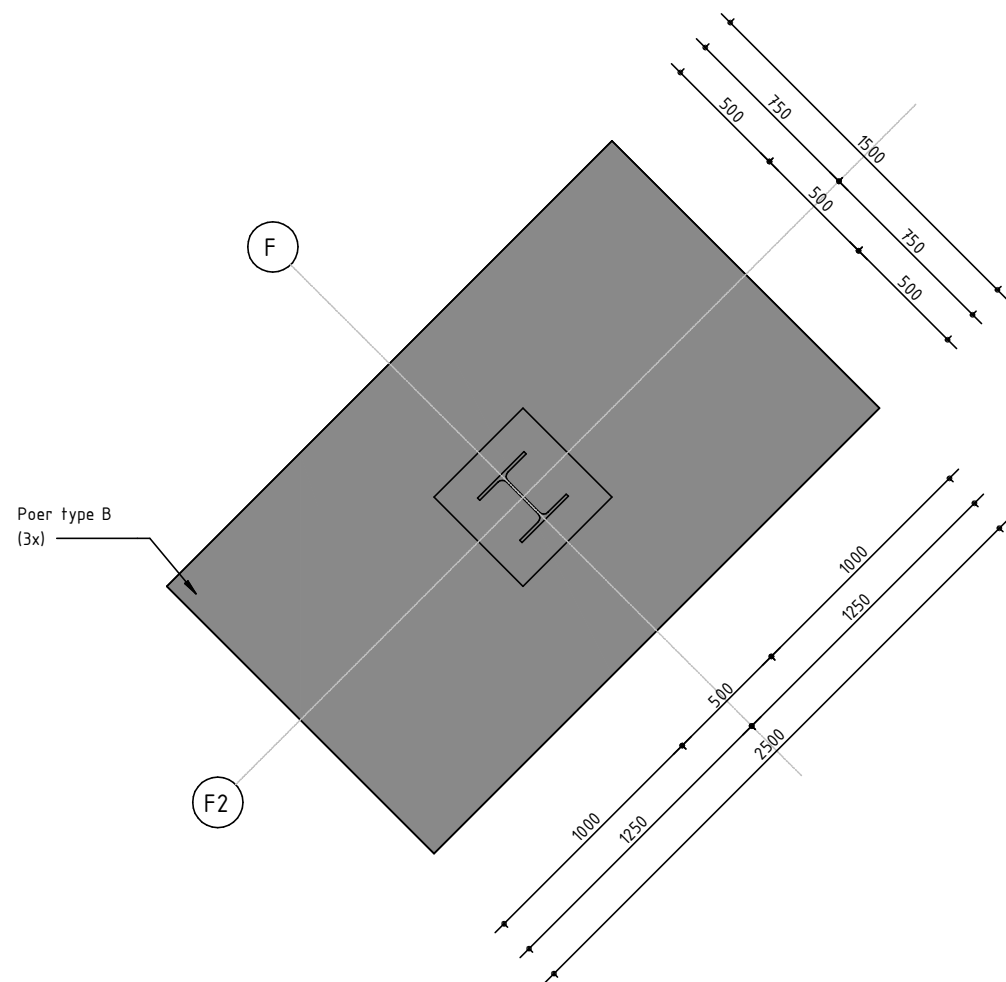

POEREN ASSEN F/F2 T/M F4
TYPE B

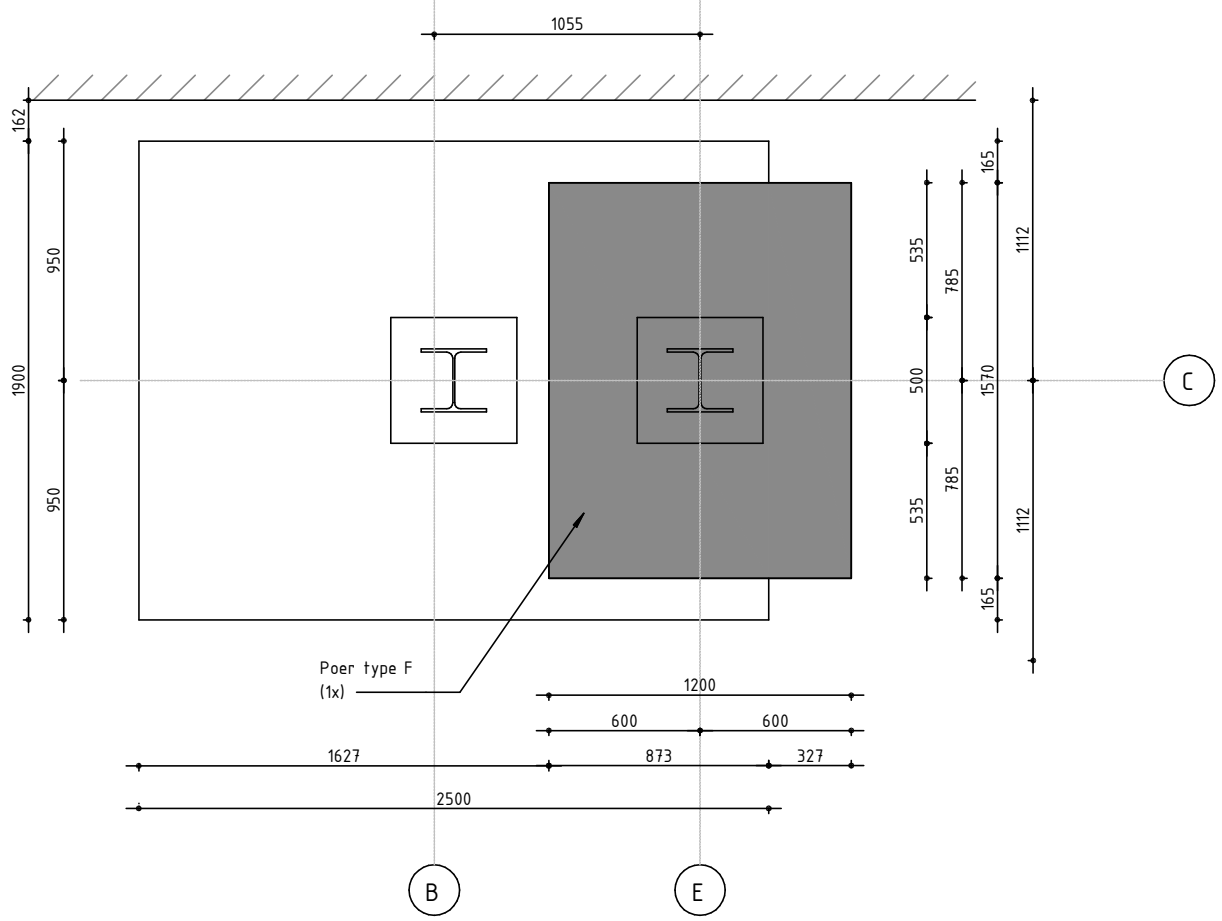

POER ASSEN E/C
TYPE F

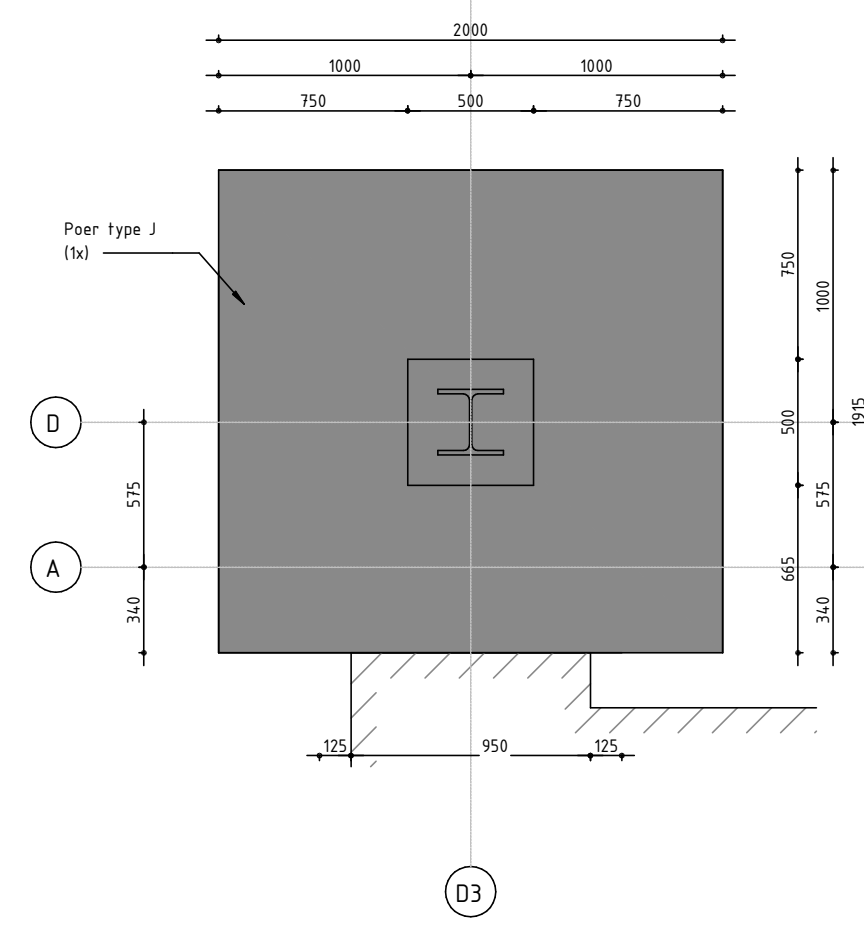

POER ASSEN D/D3
TYPE J

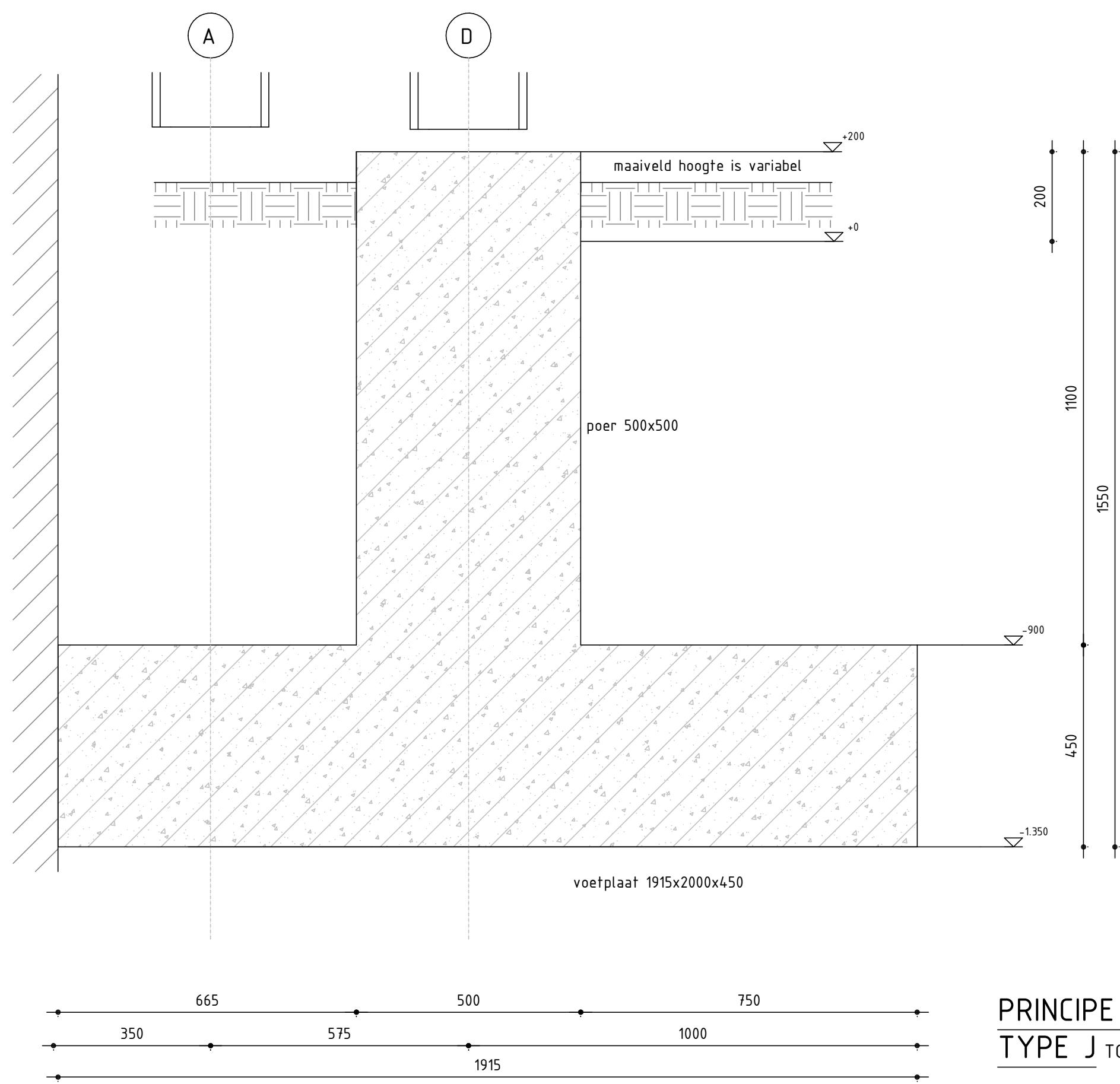

PRINCIPE DETAIL POER
TYPE J TOTAAL 1X UITVOEREN

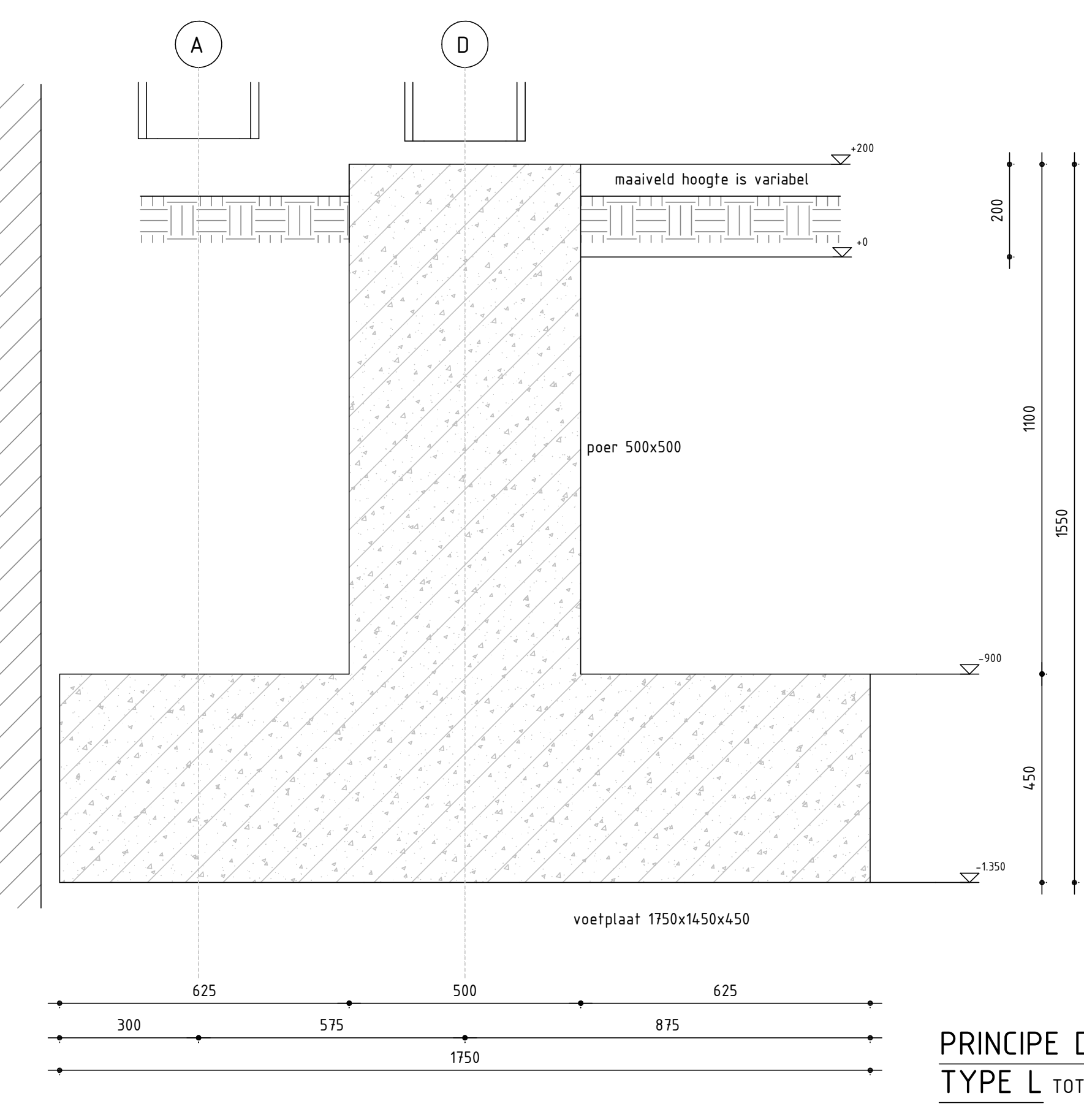

PRINCIPE DETAIL POER
TYPE L TOTAAL 1X UITVOEREN

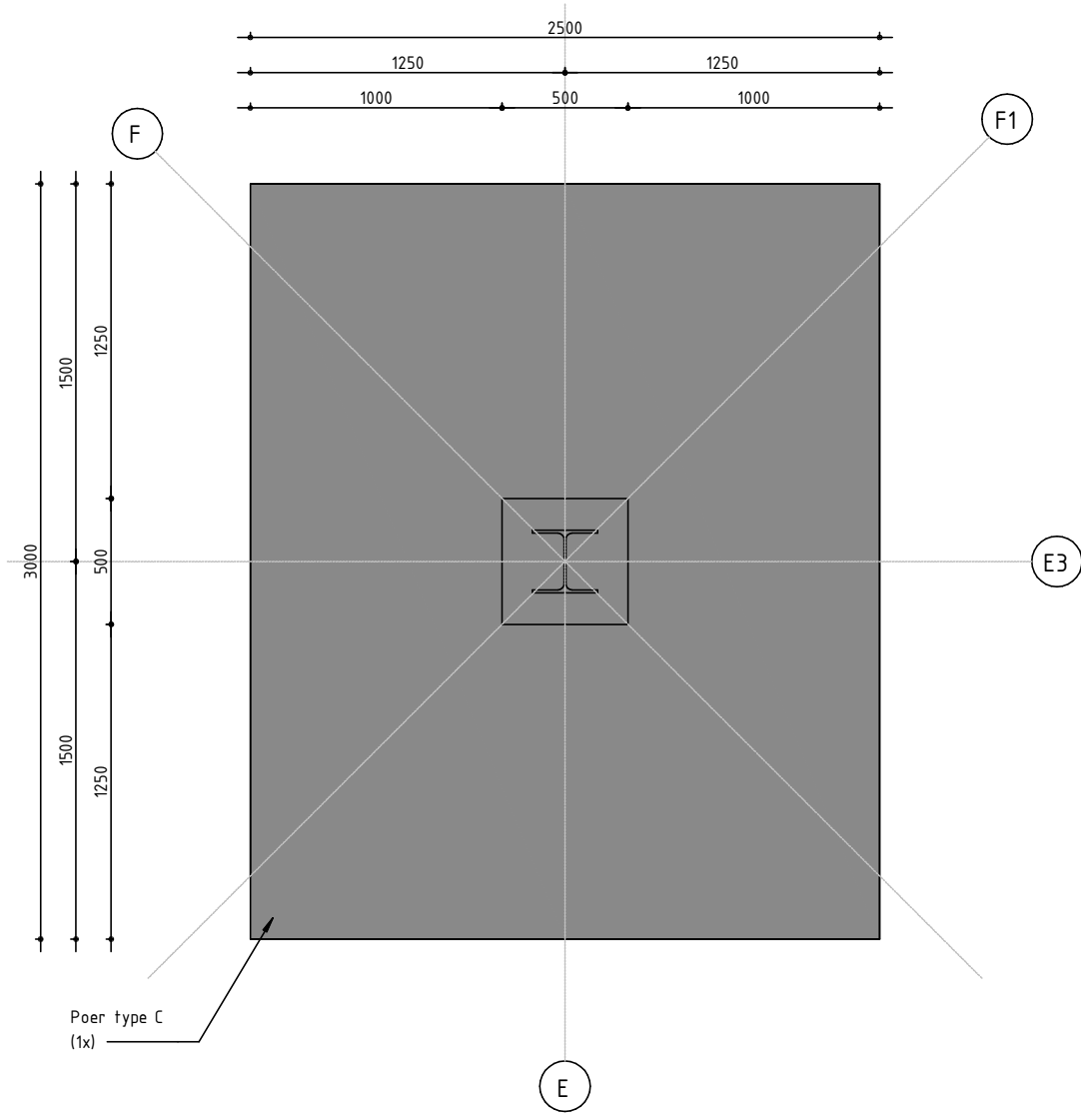

POER ASSEN E/E3
TYPE C

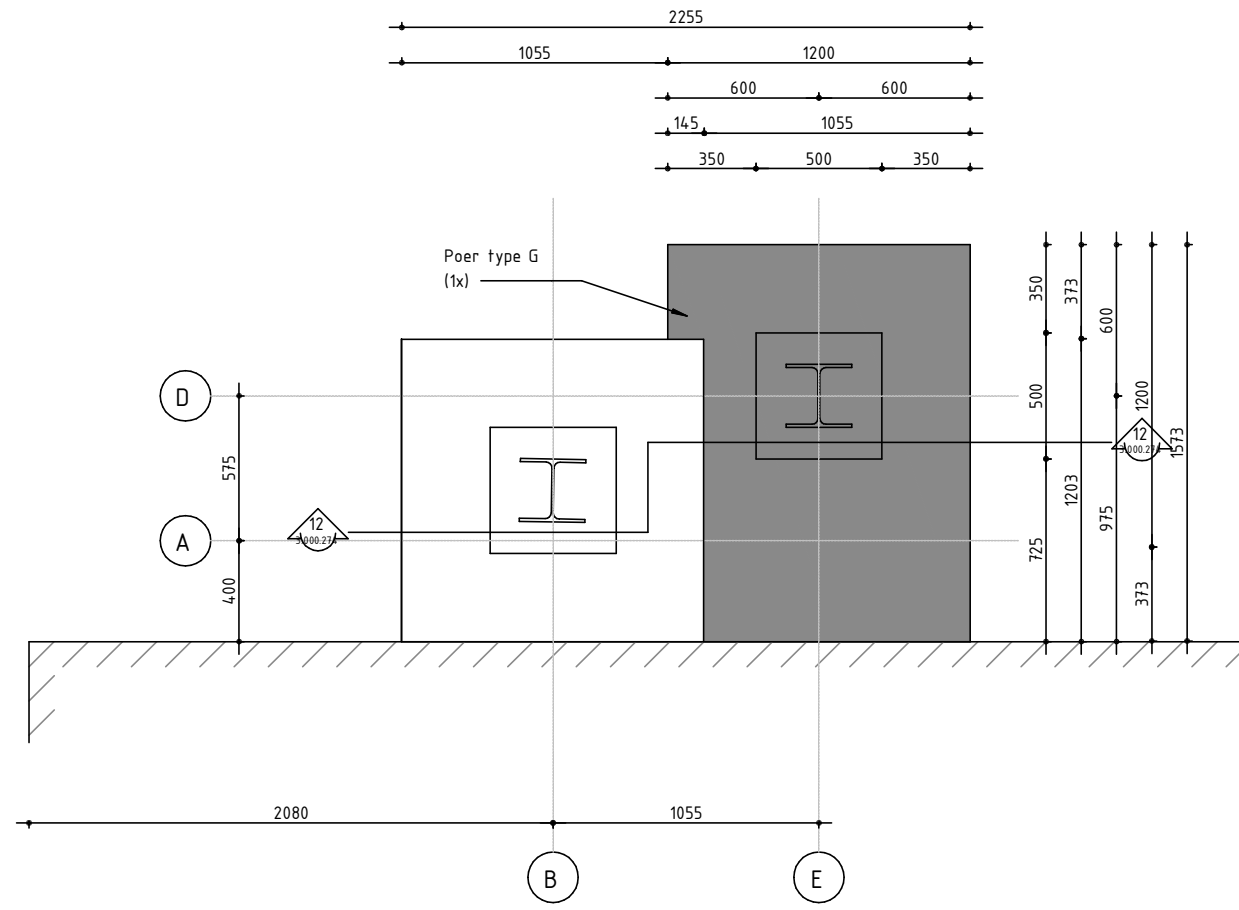

POER ASSEN E/D
TYPE G

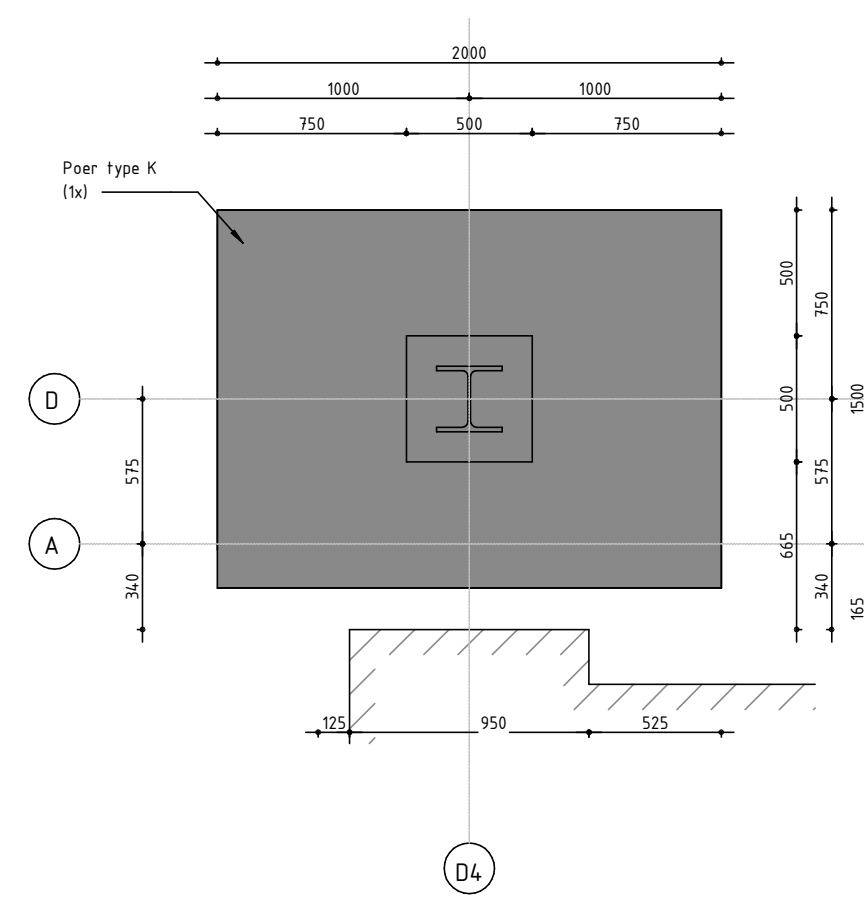

POER ASSEN D/D7
TYPE K

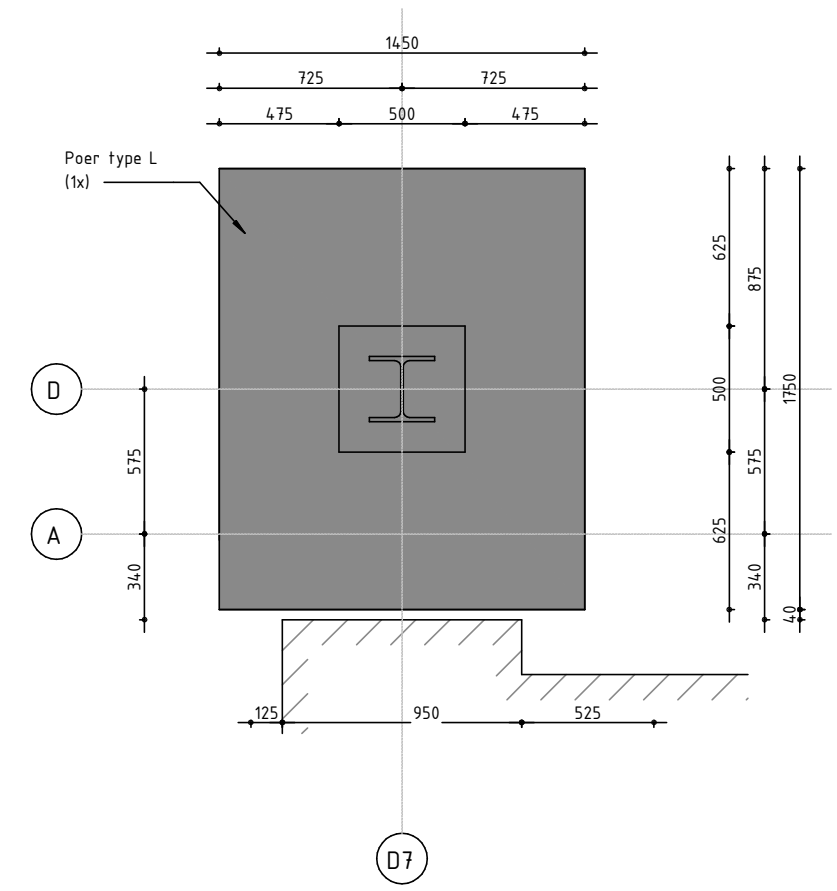
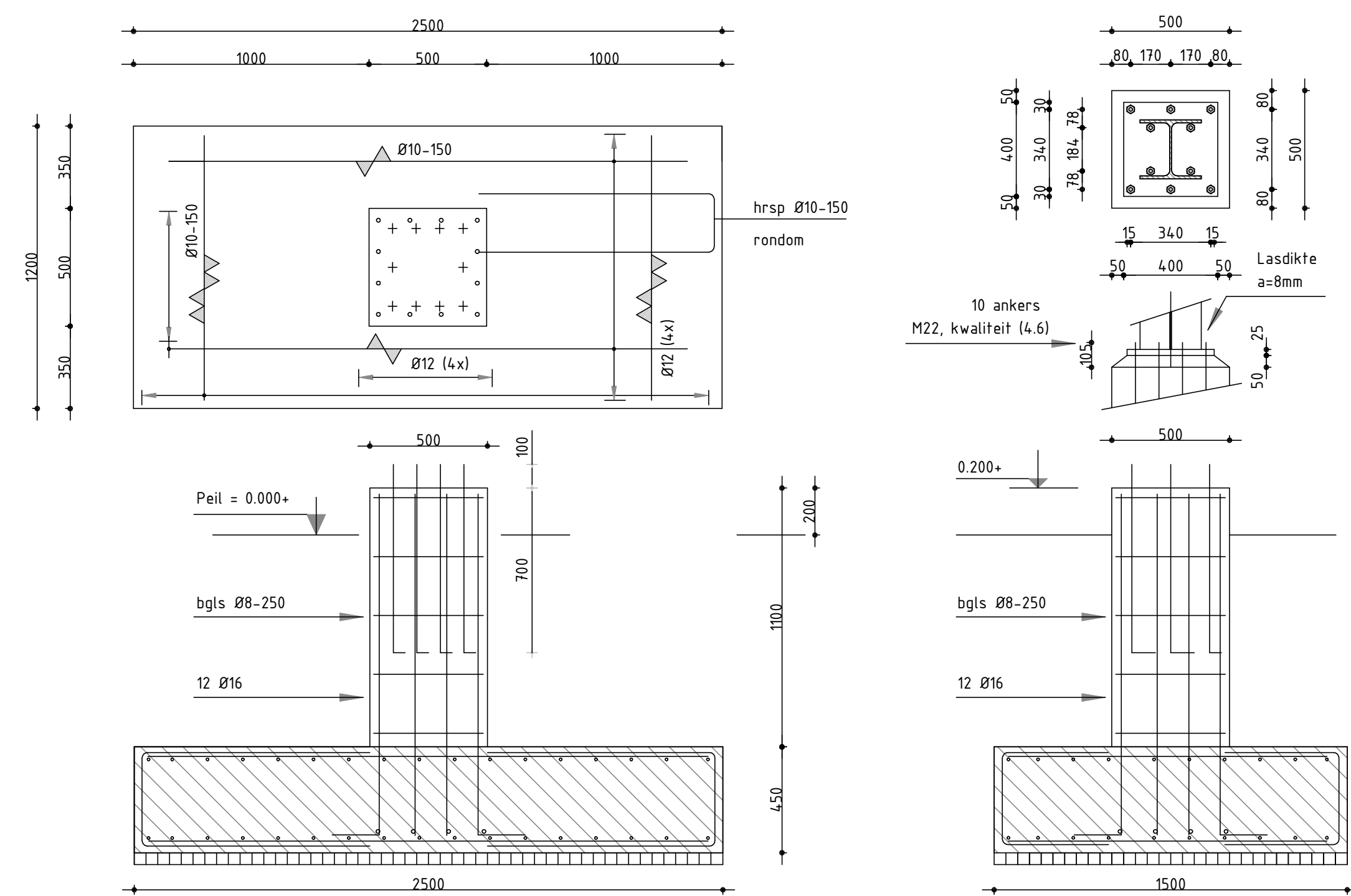

POER ASSEN D/D1
TYPE L

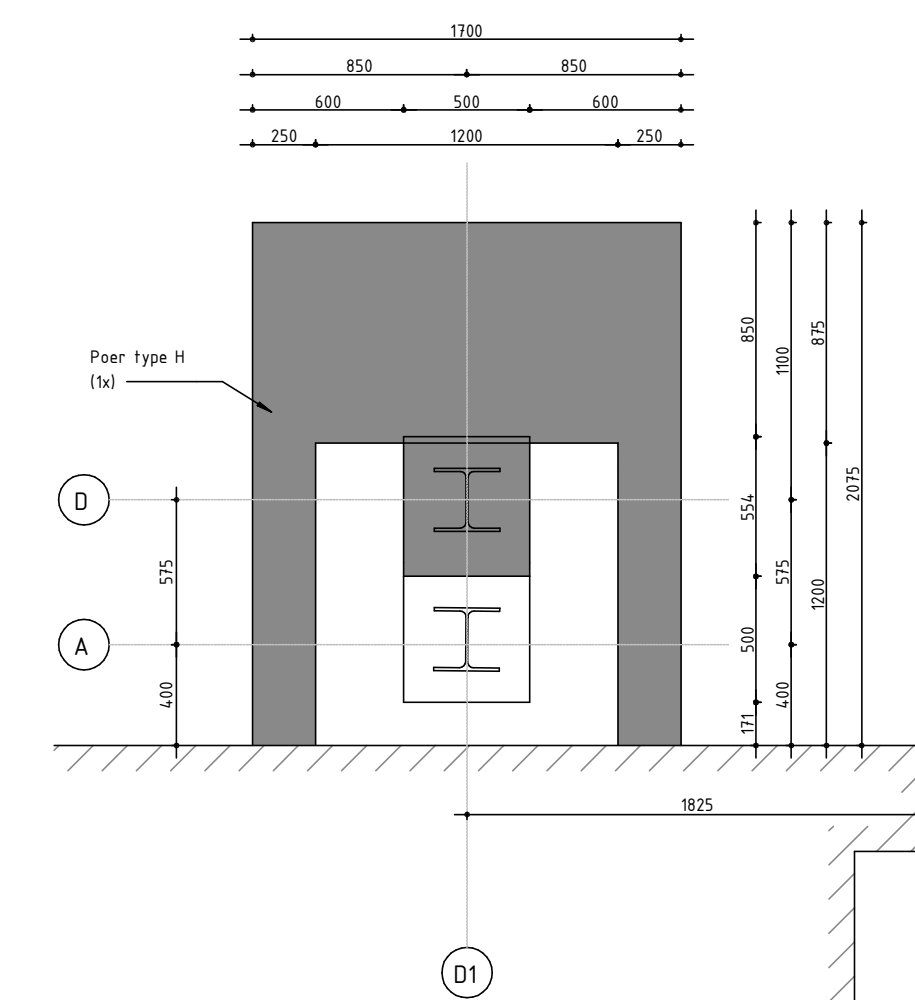

POER ASSEN D/D1
TYPE H

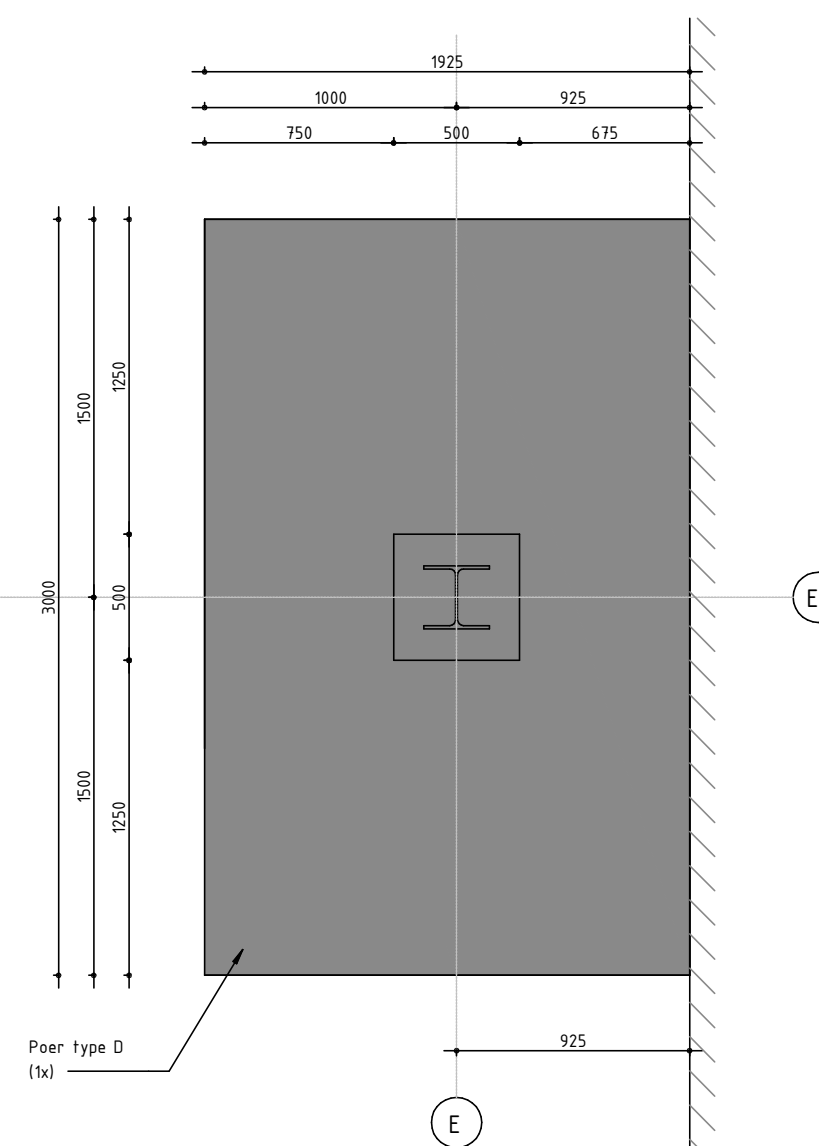

POER ASSEN E/E2
TYPE D

project : Leidingbrug E 15 Getec-Brands	opdrachtgever : Getec Brands	uitg. : A .. B .. C .. D .. E .. F .. G ..	datum :	tek. :
onderwerp : Nieuwe Leidingbrug Poeren	www.stop-engineering.nl info@stop-engineering.nl	base : Uitvoering	status : As built	
STOP ENGINEERING	21.2944 BW 1:10 A0 mm 17-2-2022 3.000.274-1			